



## MANUAL DE INSTRUCCIONES

MESA DE ORDENADOR MULTIFUNCION

MODELO:MB0141TT18-2

MODELO:MB2701TT99-2

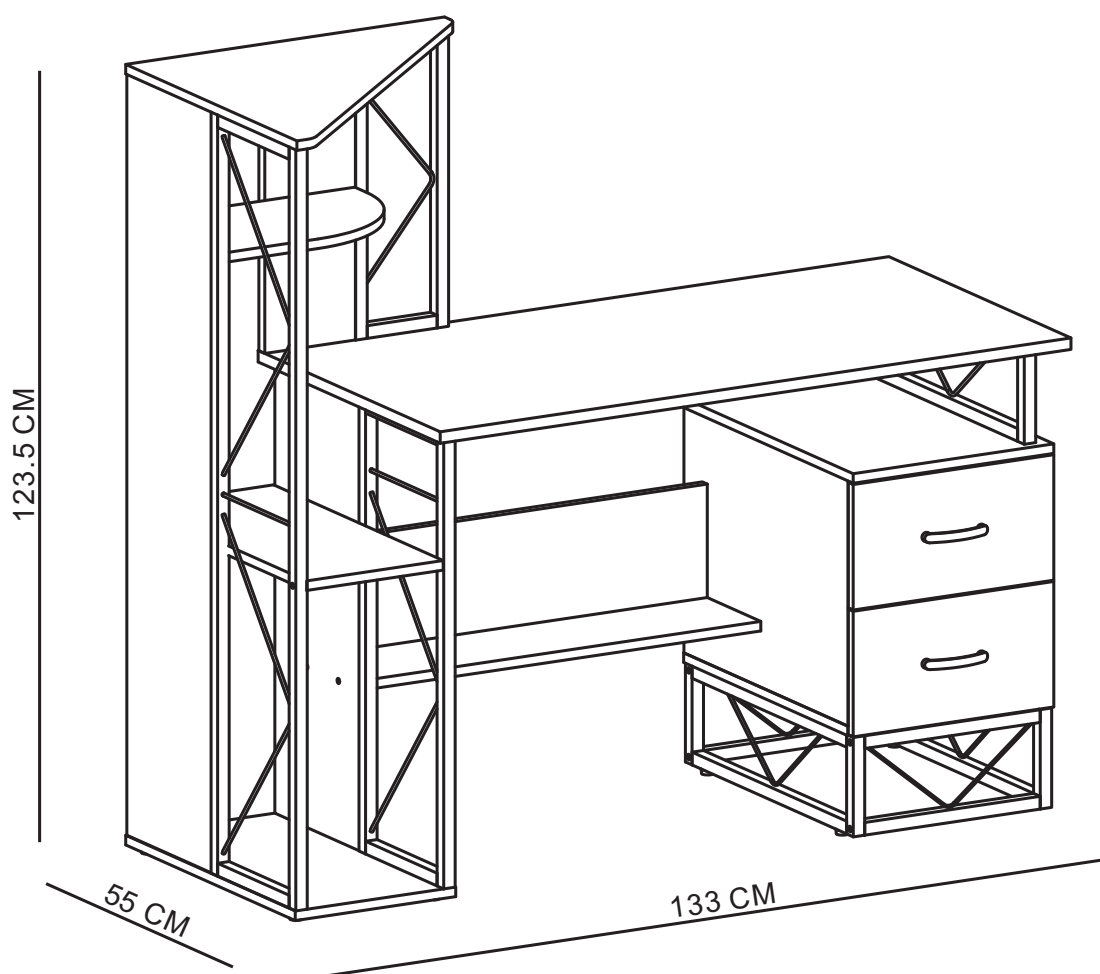



## ADVERTENCIA

Siga las instrucciones que se detallan en el manual, si presenta alguna diferencia en el contenido de sus piezas pongase en contacto con la tienda donde fue adquirido.

## RECOMENDACIONES

- Estudie atentamente las instrucciones antes del montaje.
- Ordene las piezas que componen el mueble.
- Agrupe y ordene la quincallería.
- Prepare una zona despejada para el montaje.
- Monte las piezas sin forzar los ensambles, una vez armada toda la estructura, reaprete de forma definitiva.
- Volver a apretar los tornillos después de un tiempo de uso.
- Conserve estas instrucciones de montaje.



Herramientas requeridas  
(no incluidas)



2 persona  
para el armado



Producto contenido  
en 1 cajas

# QUINCALLERÍA

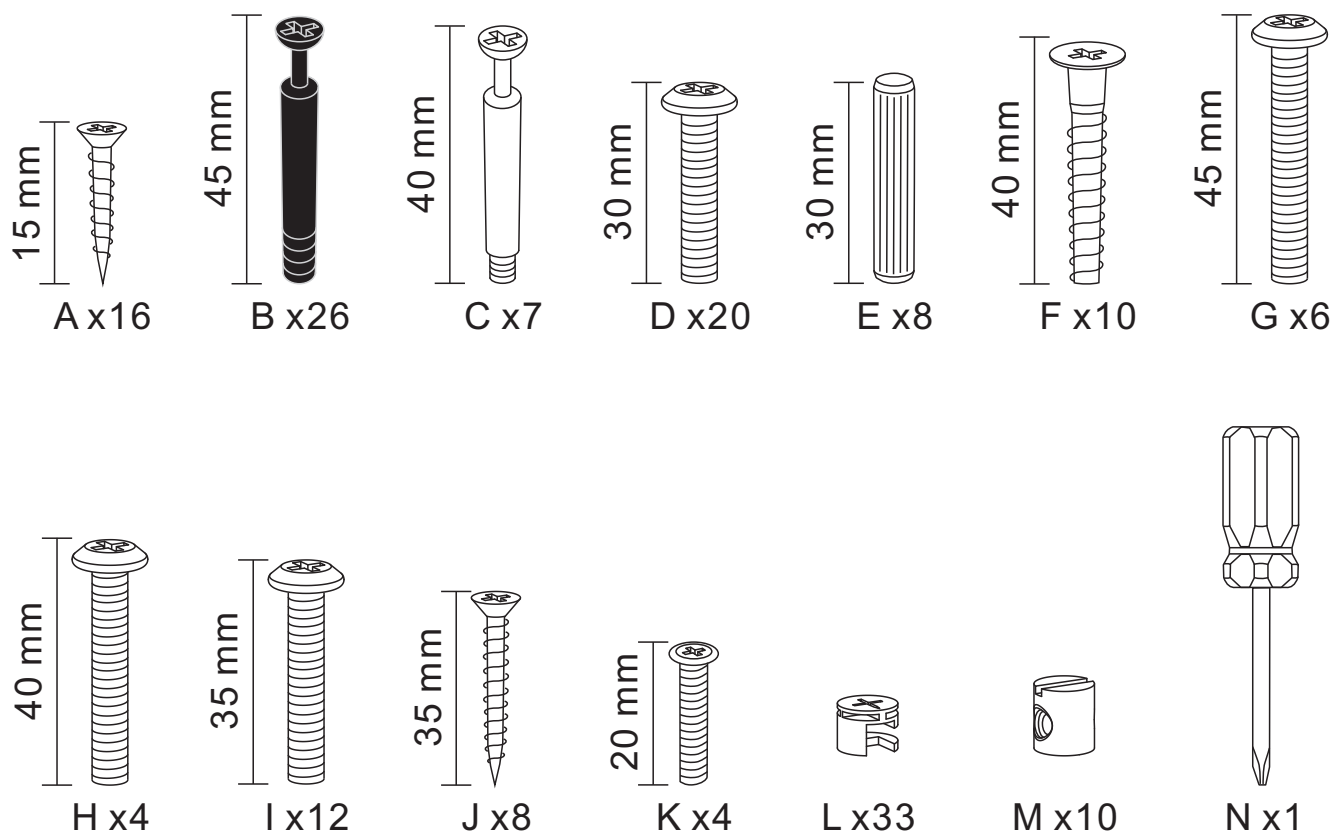

**Instale los pernos 6x40mm 6X45mm según la siguiente ilustración**

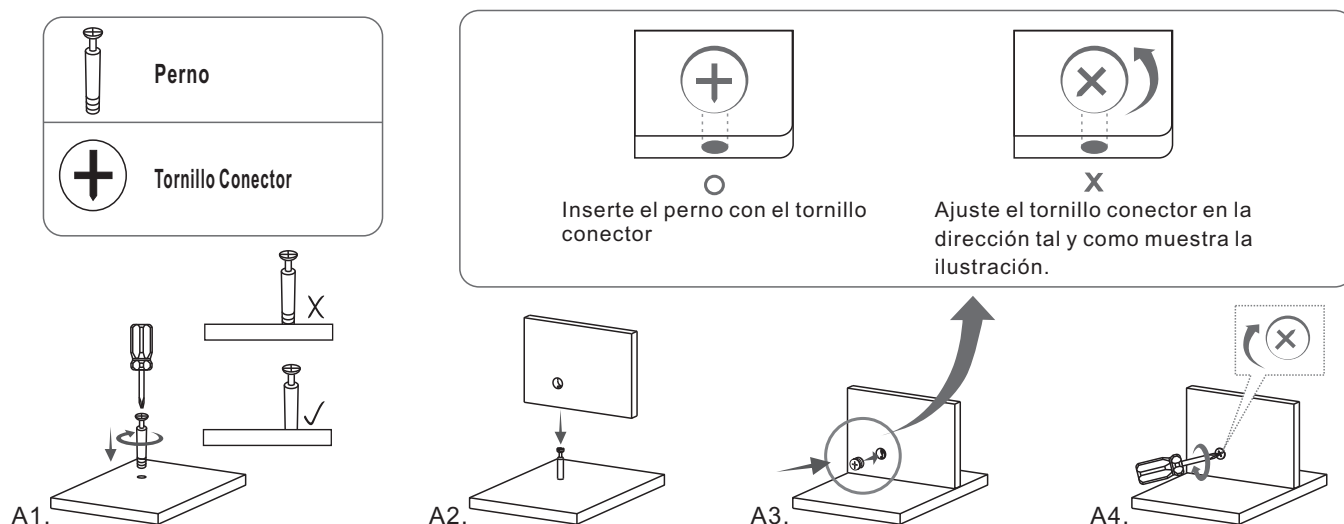

# PIEZAS

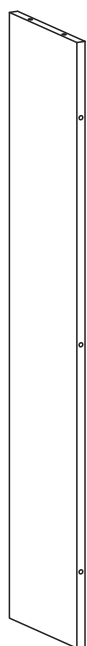

1 X1

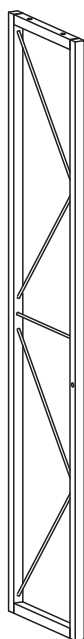

2 X1

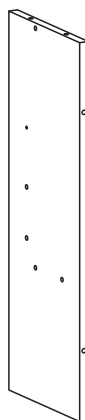

3 X1



4 X1



5 X8

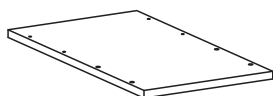

6 X1

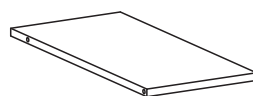

7 X1



8 X1

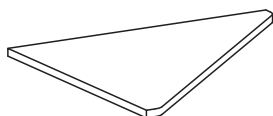

9 X1

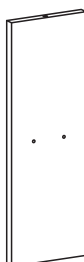

10 X1

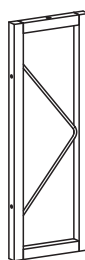

11 X1

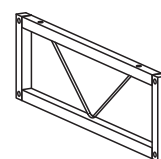

12 X2

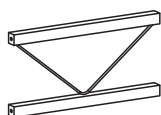

13 X2

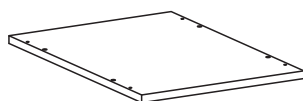

14 X1

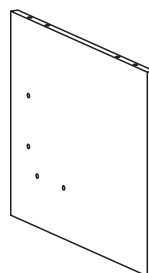

15 X1

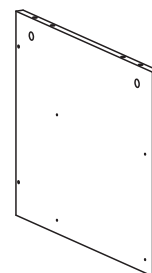

16 X1

# PIEZAS

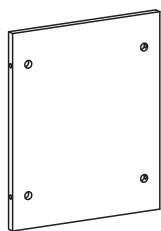

17 X1

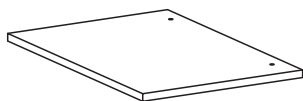

18 X1

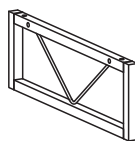

19 X1



20 X2



21 X2

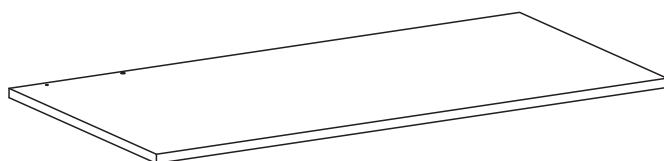

22 X1



23 X2

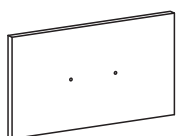

24 X2

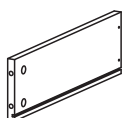

25 X2

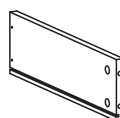

26 X2



27 X2



28 X2

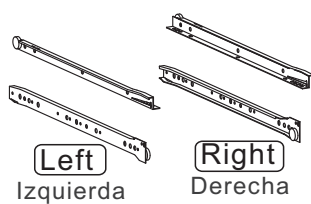

29 X2



30 X2

# PASO 1

Monte las piezas sobre una superficie plana y protegida (con frazadas o cartones).

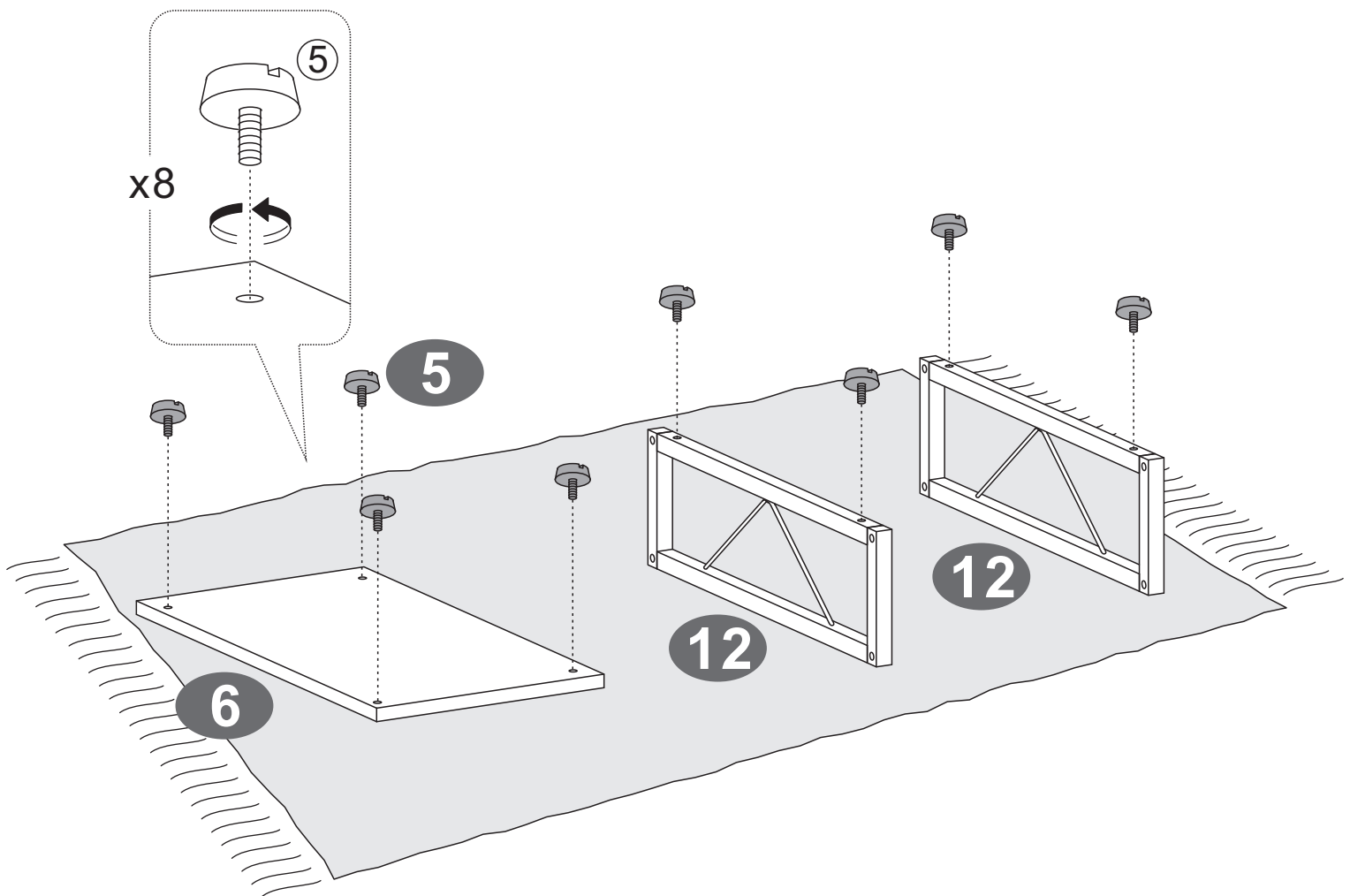

# PASO 2

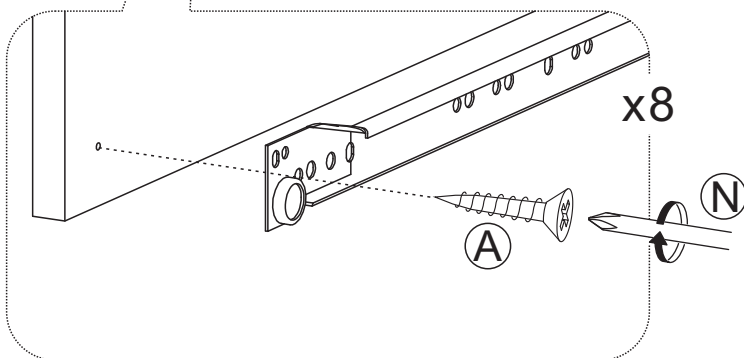
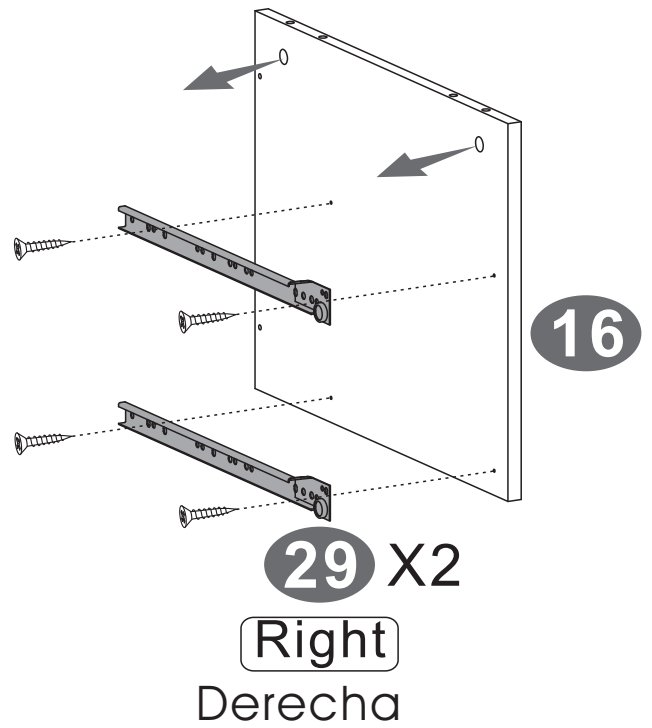
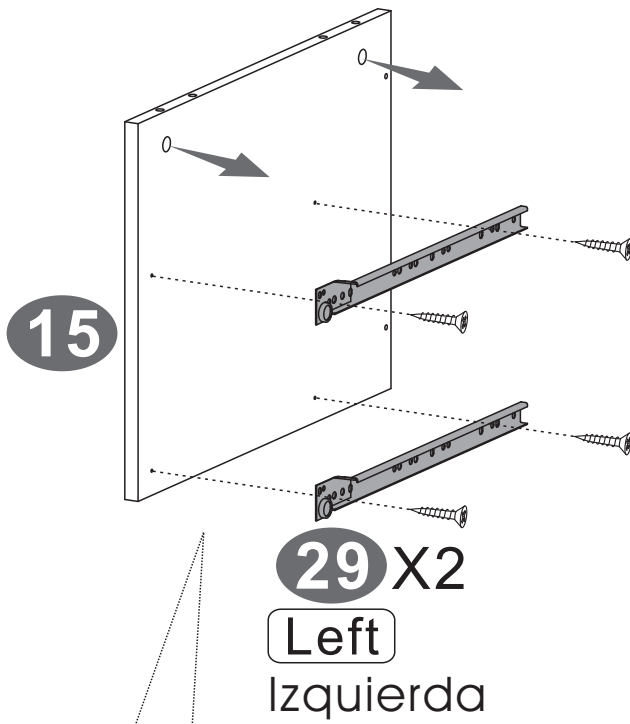
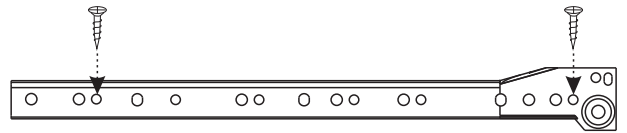
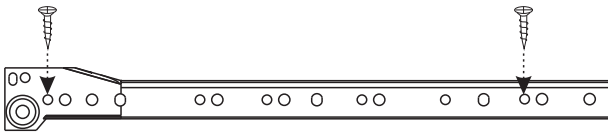

# PASO 3

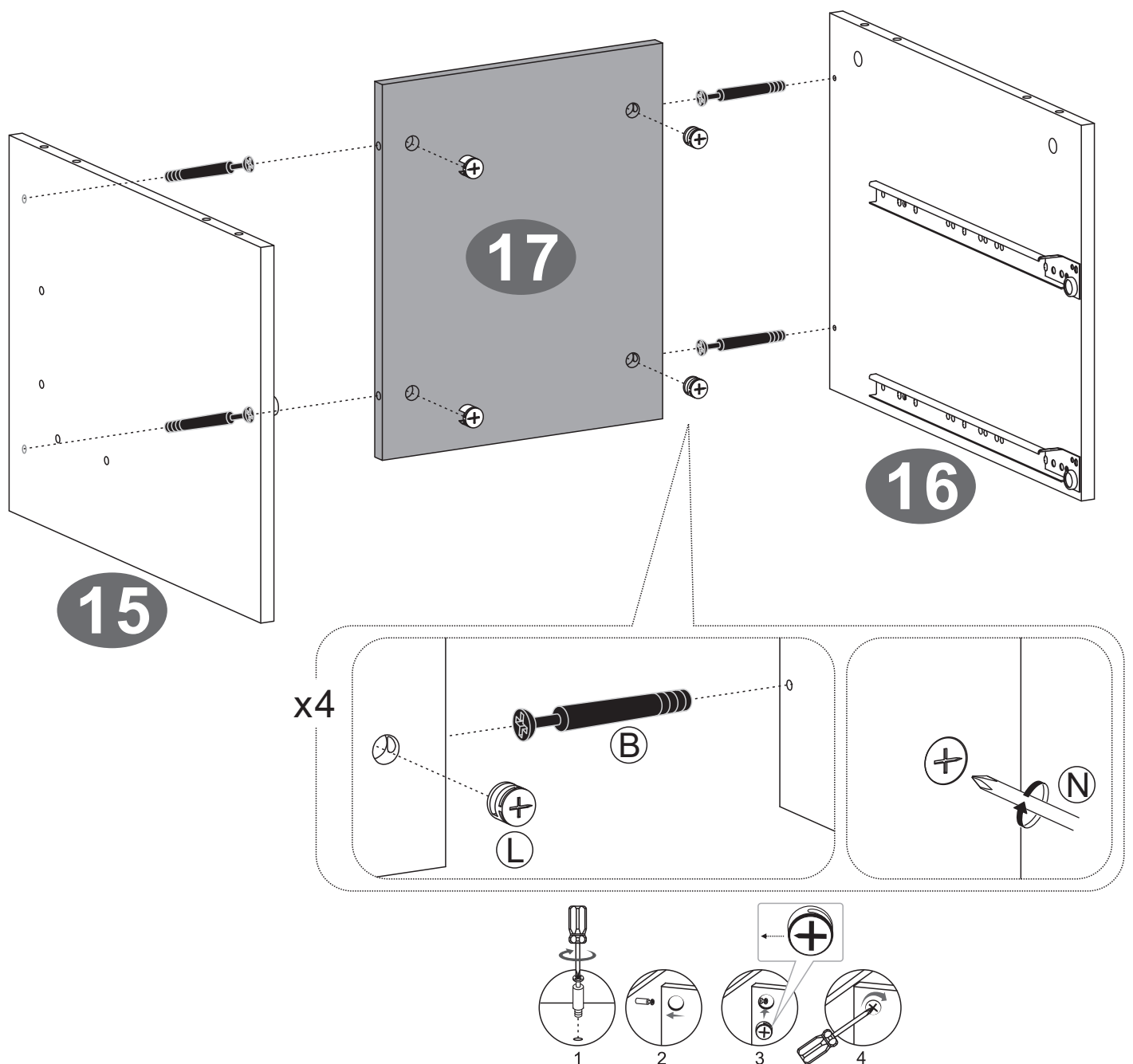



# PASO 4

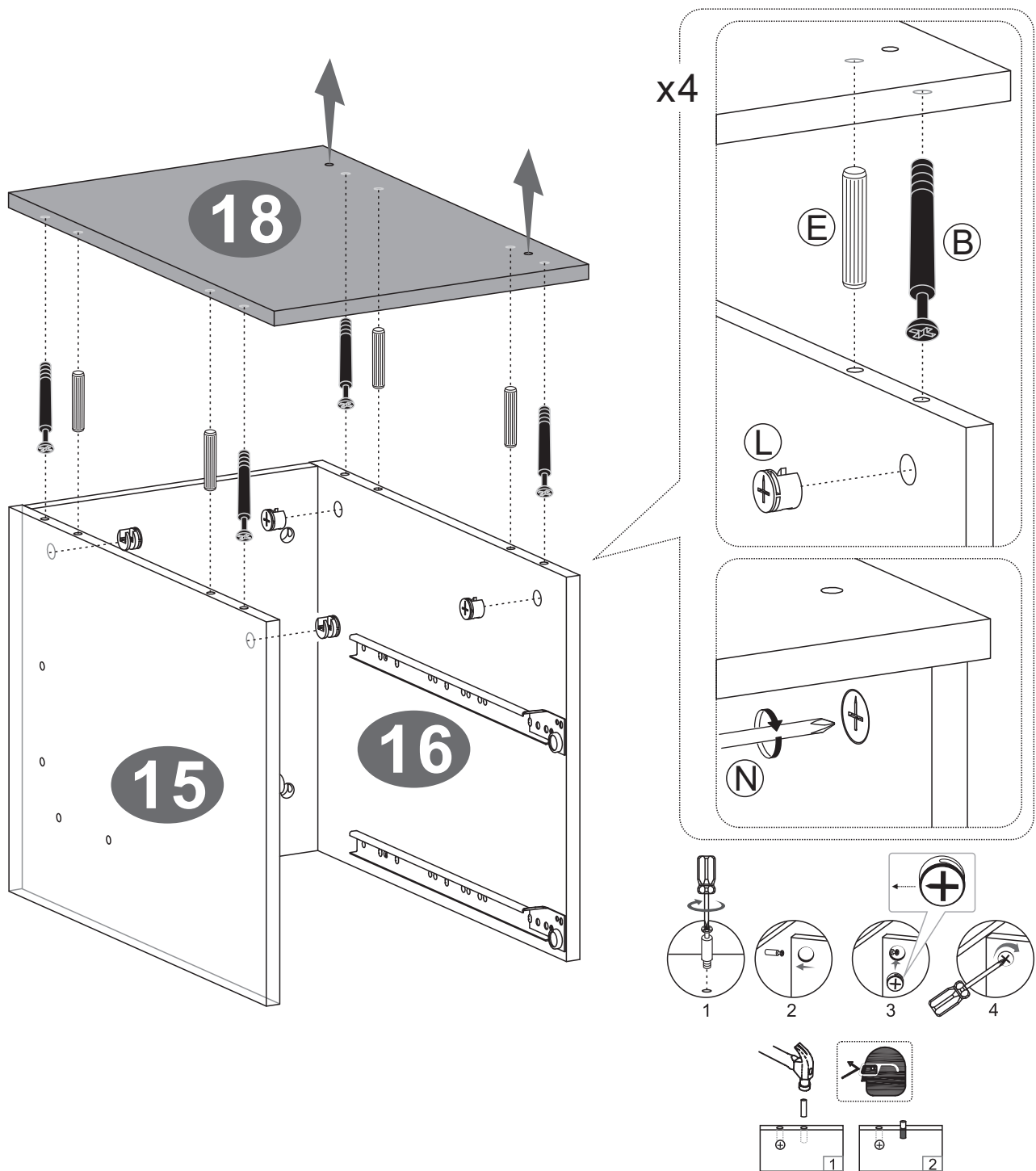

# PASO 5

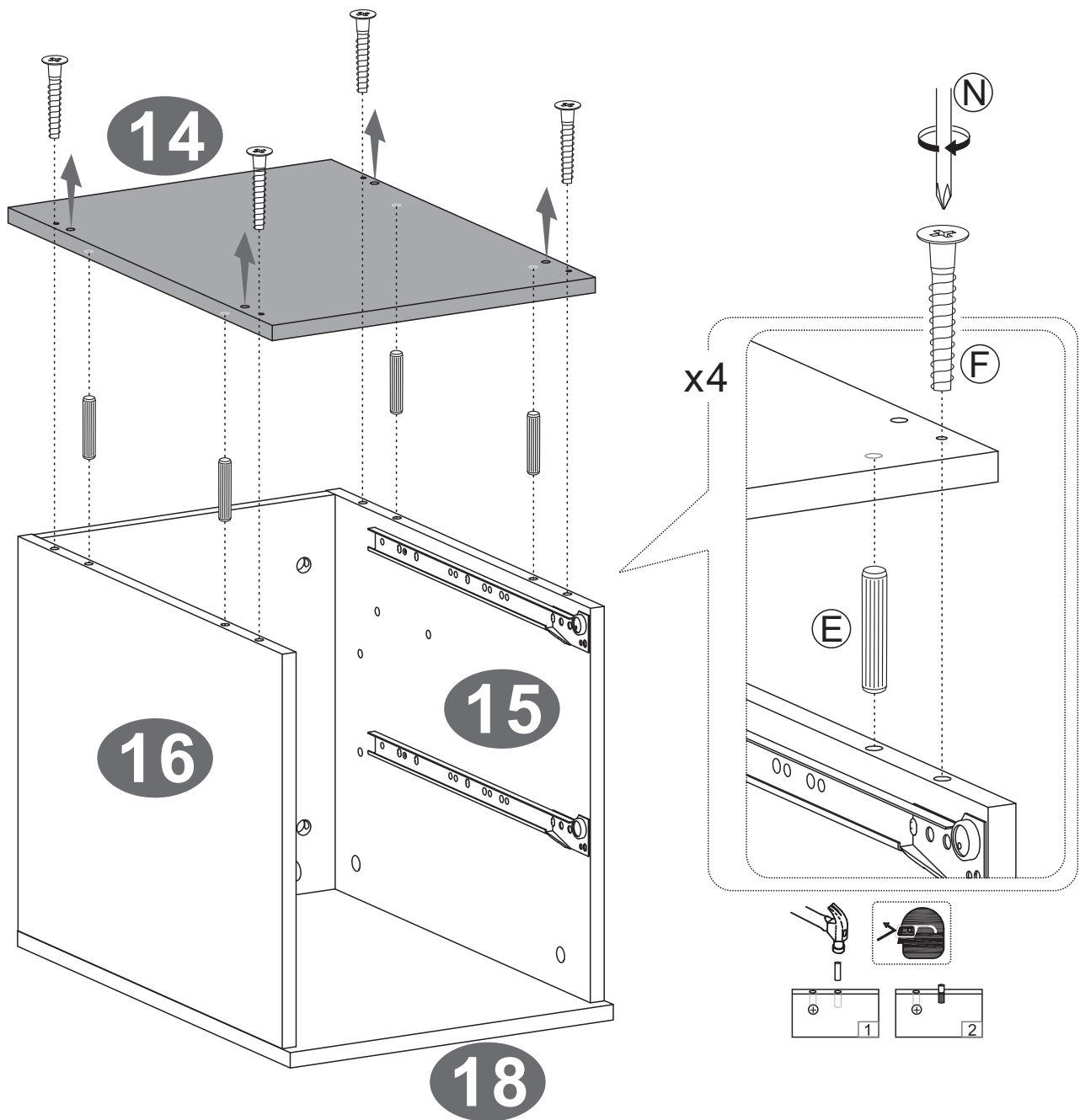

## PASO 6

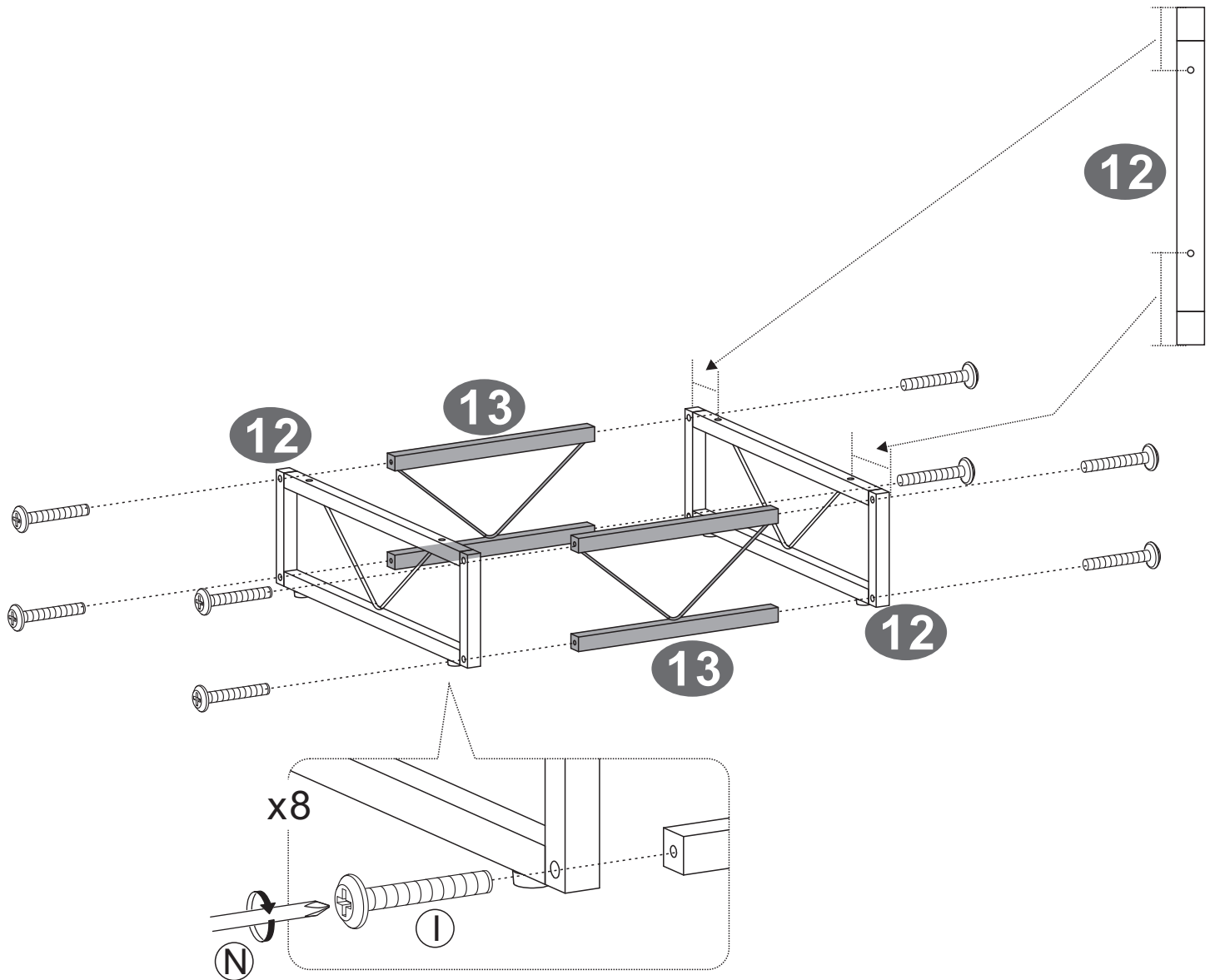

# PASO 7

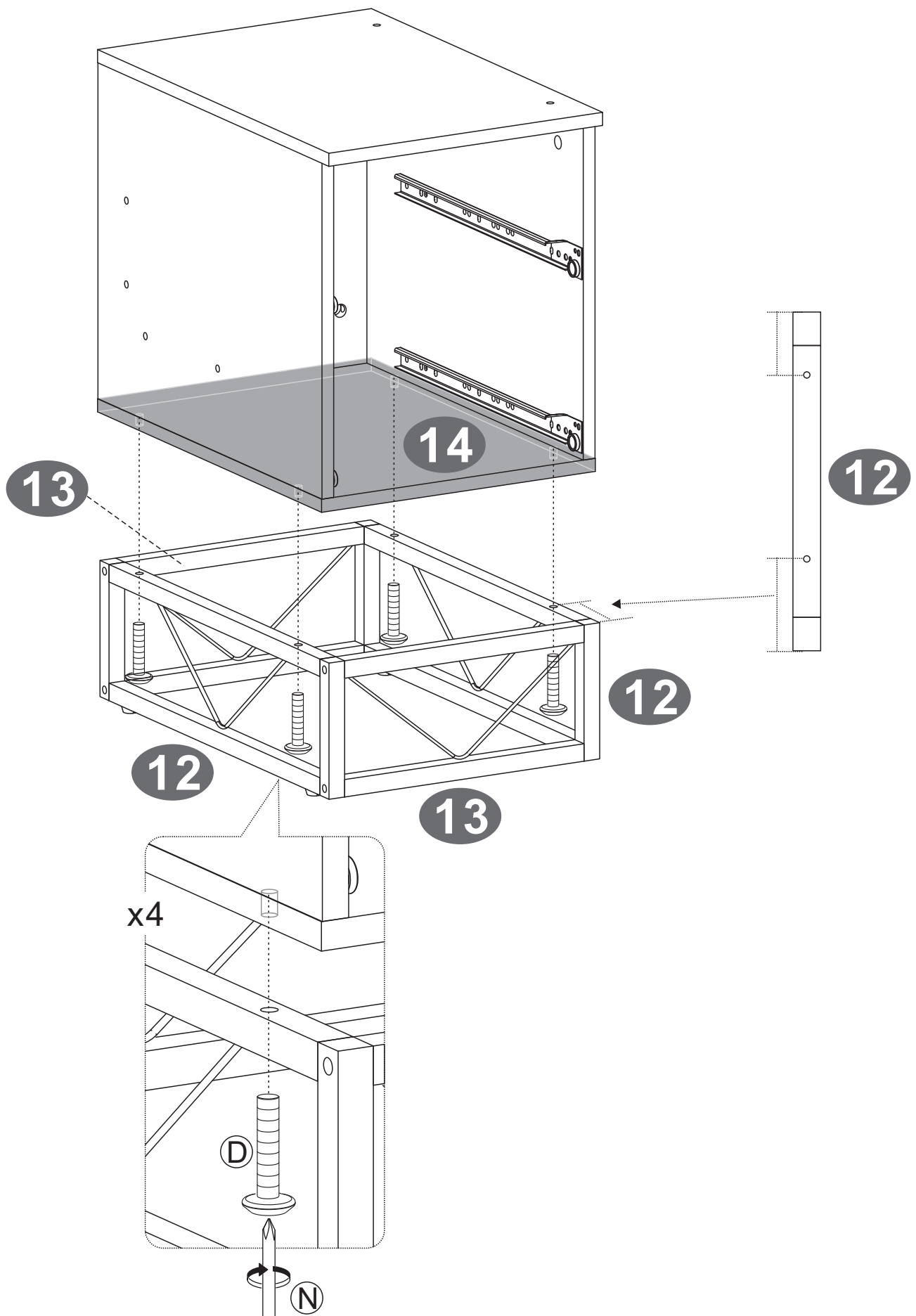

## PASO 8

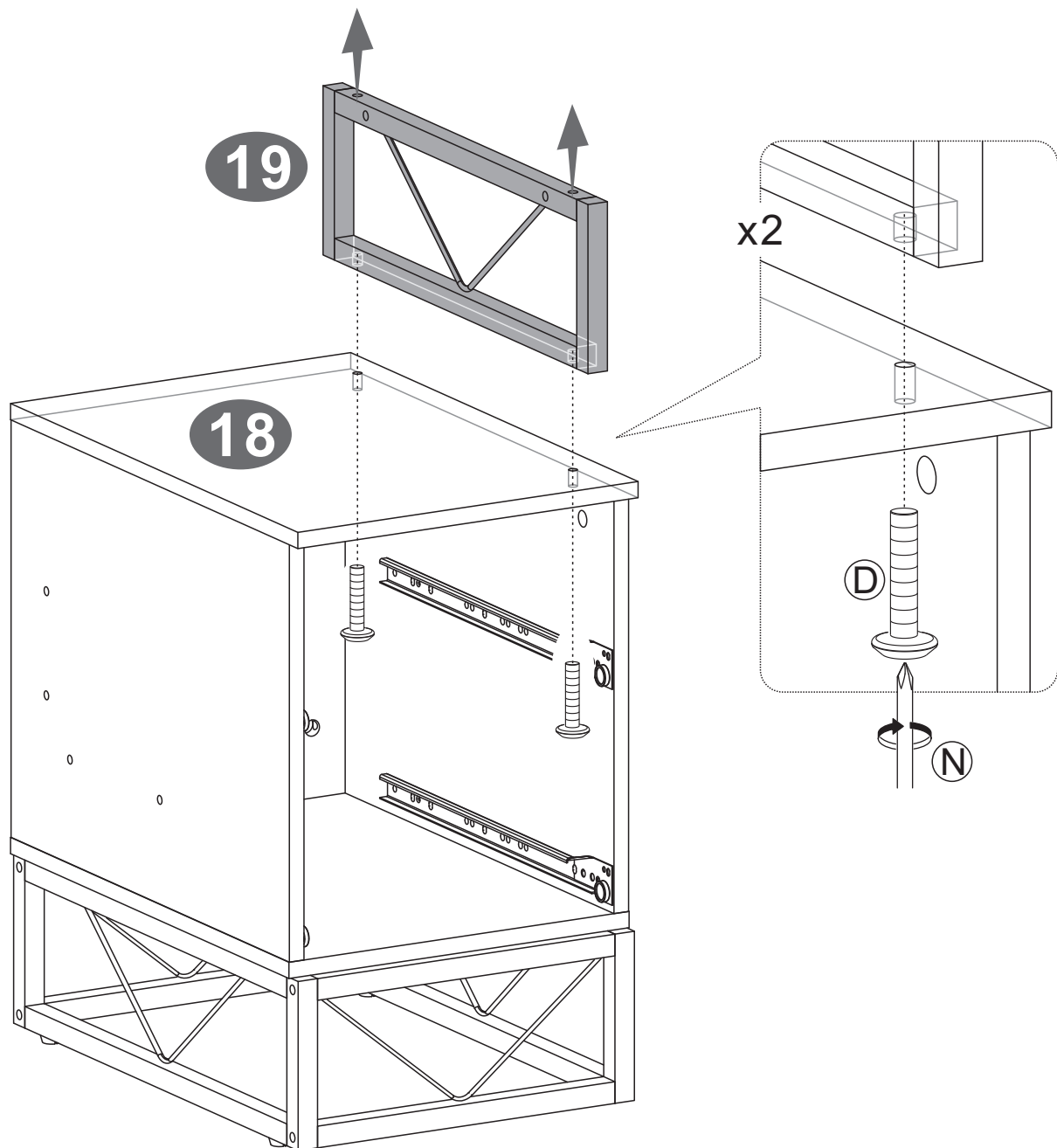

# PASO 9

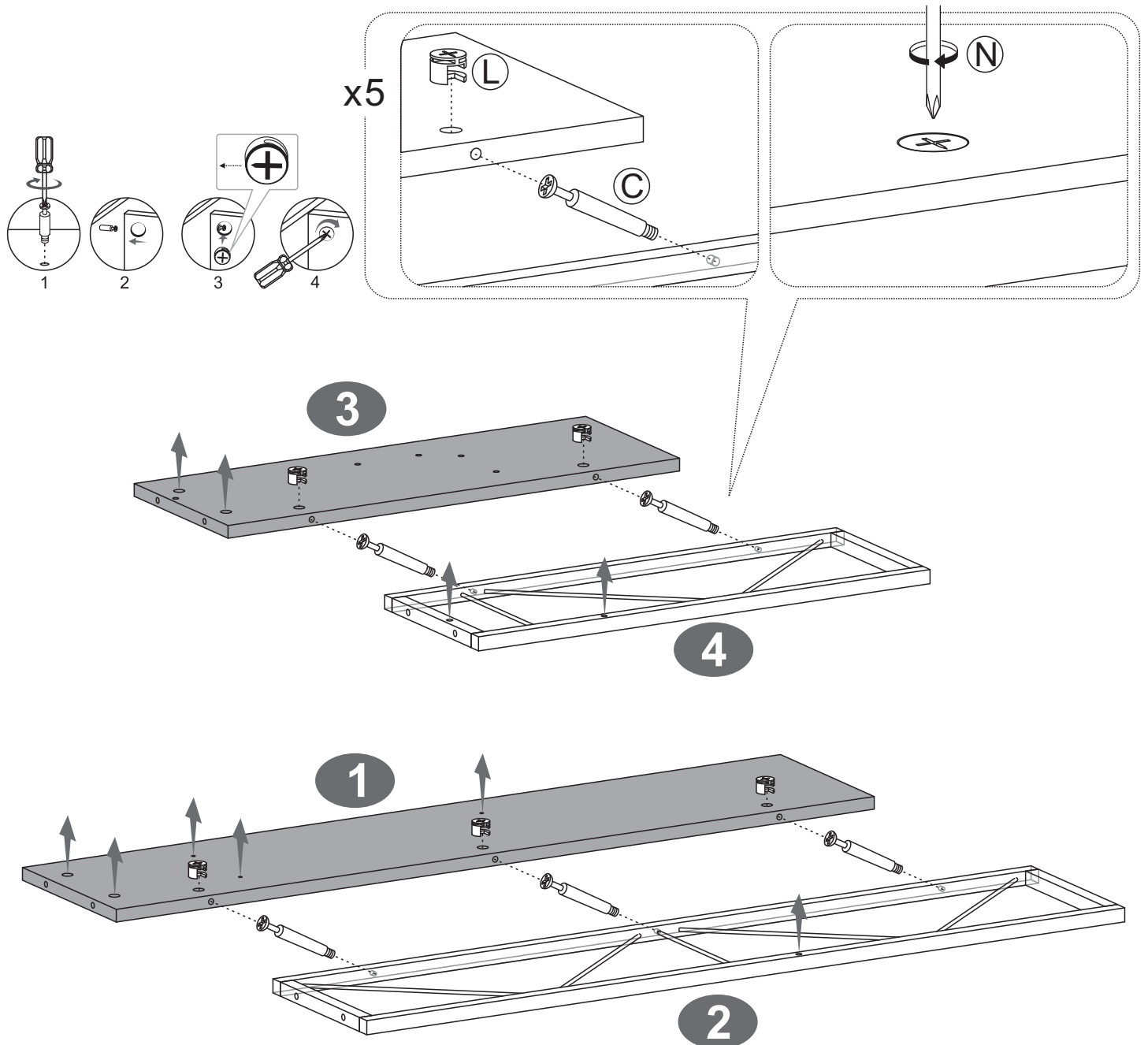

## PASO 10

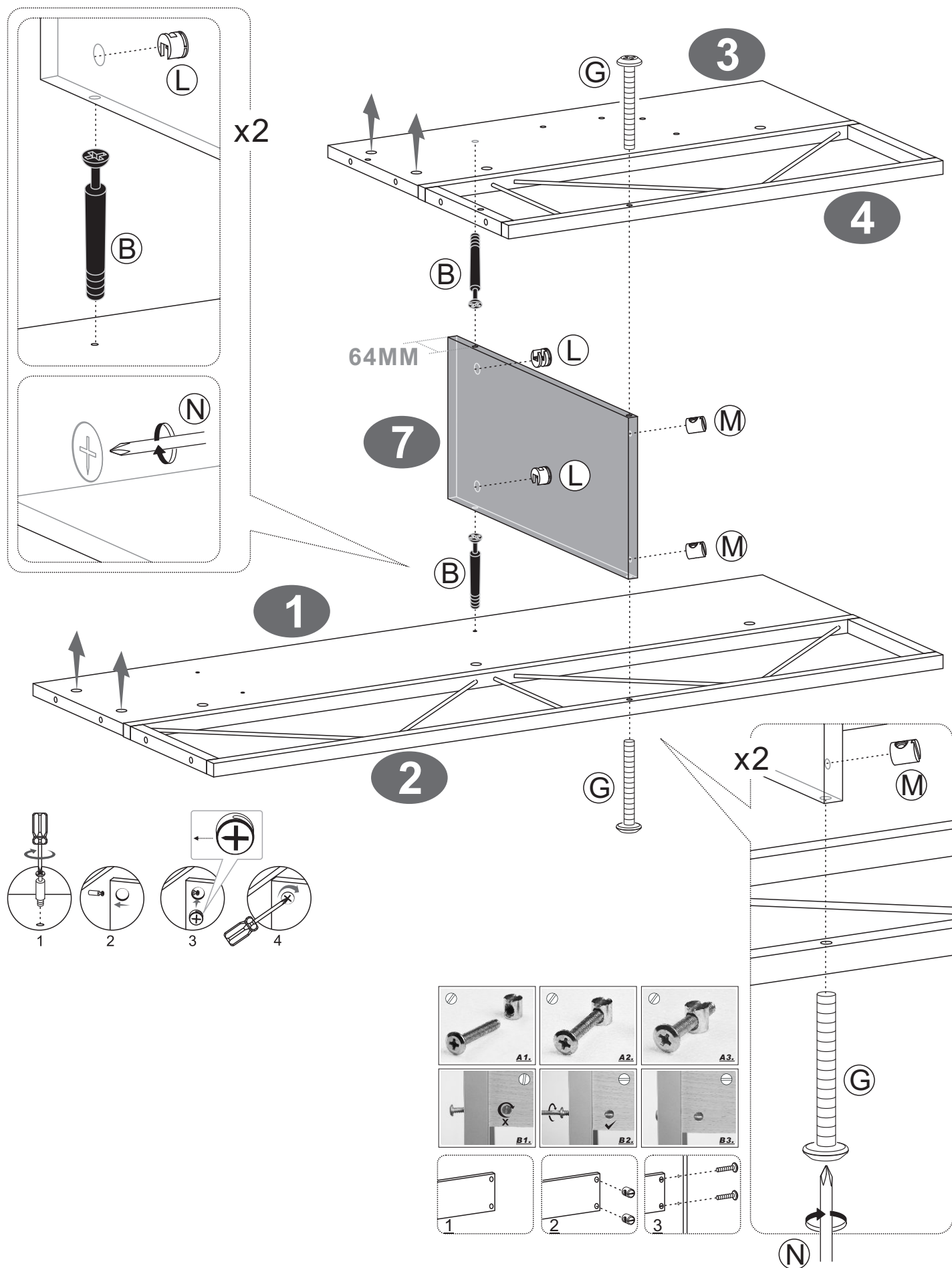

# PASO 11

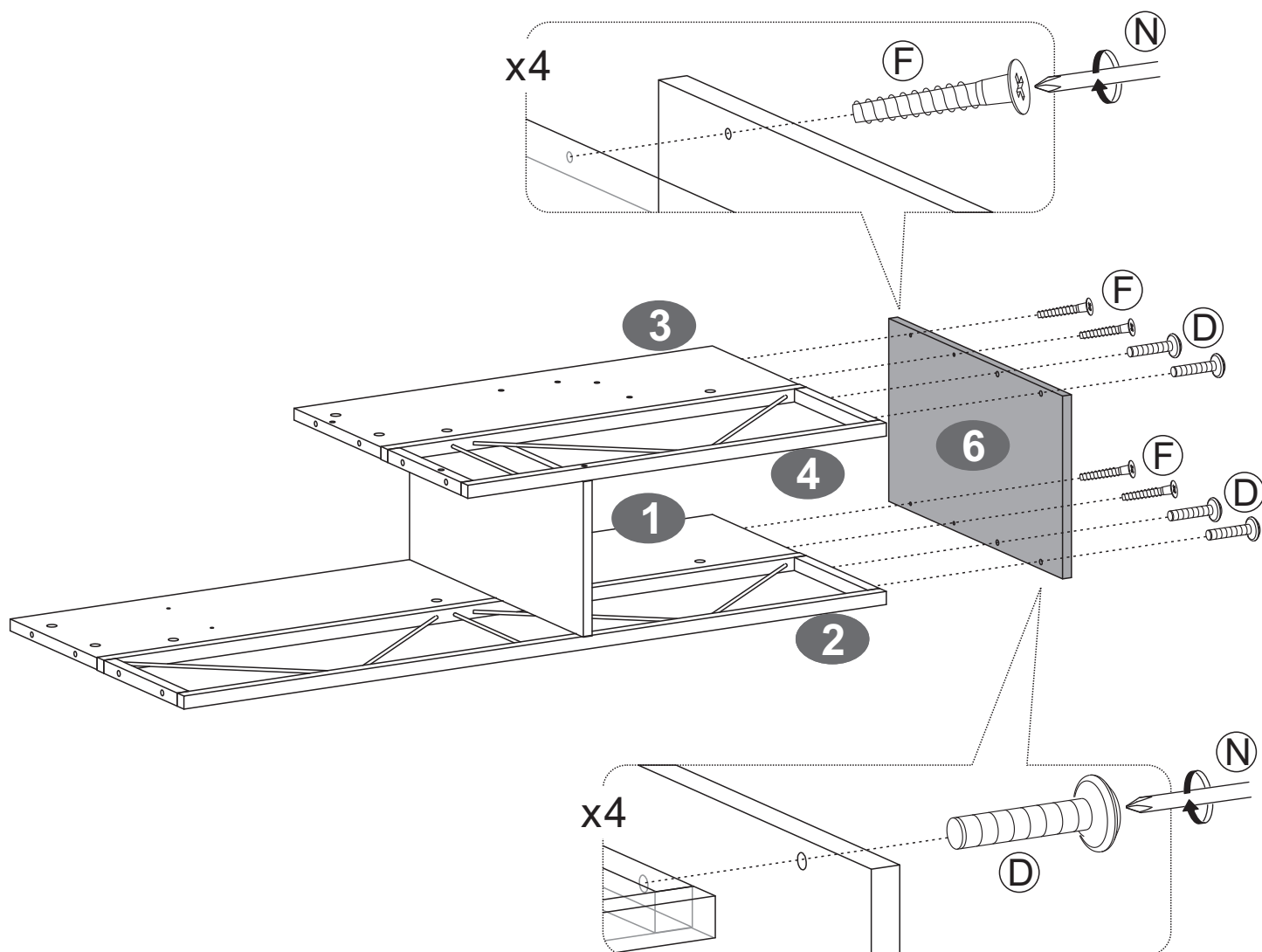



# PASO 12

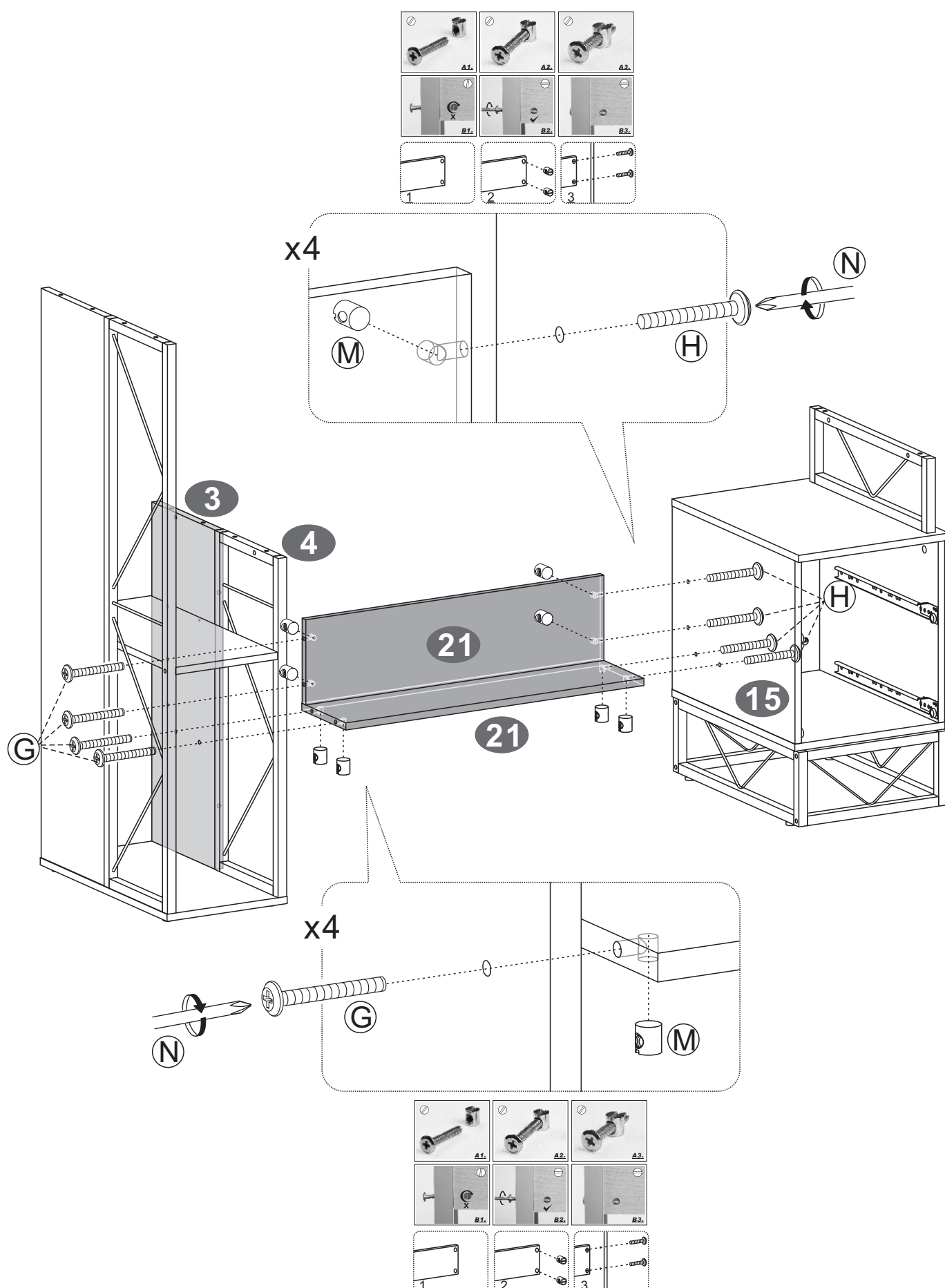

## PASO 13

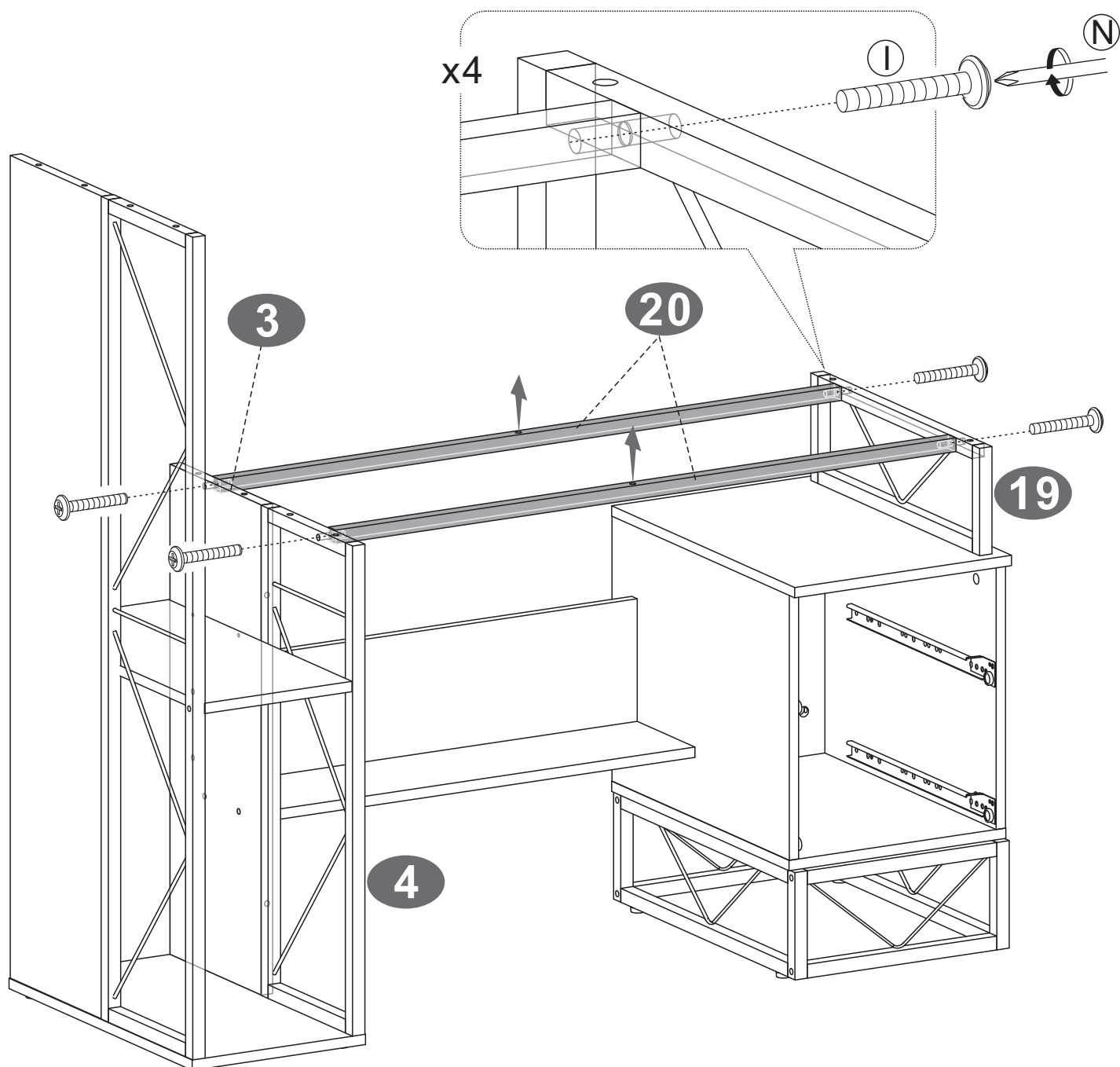

# PASO 14

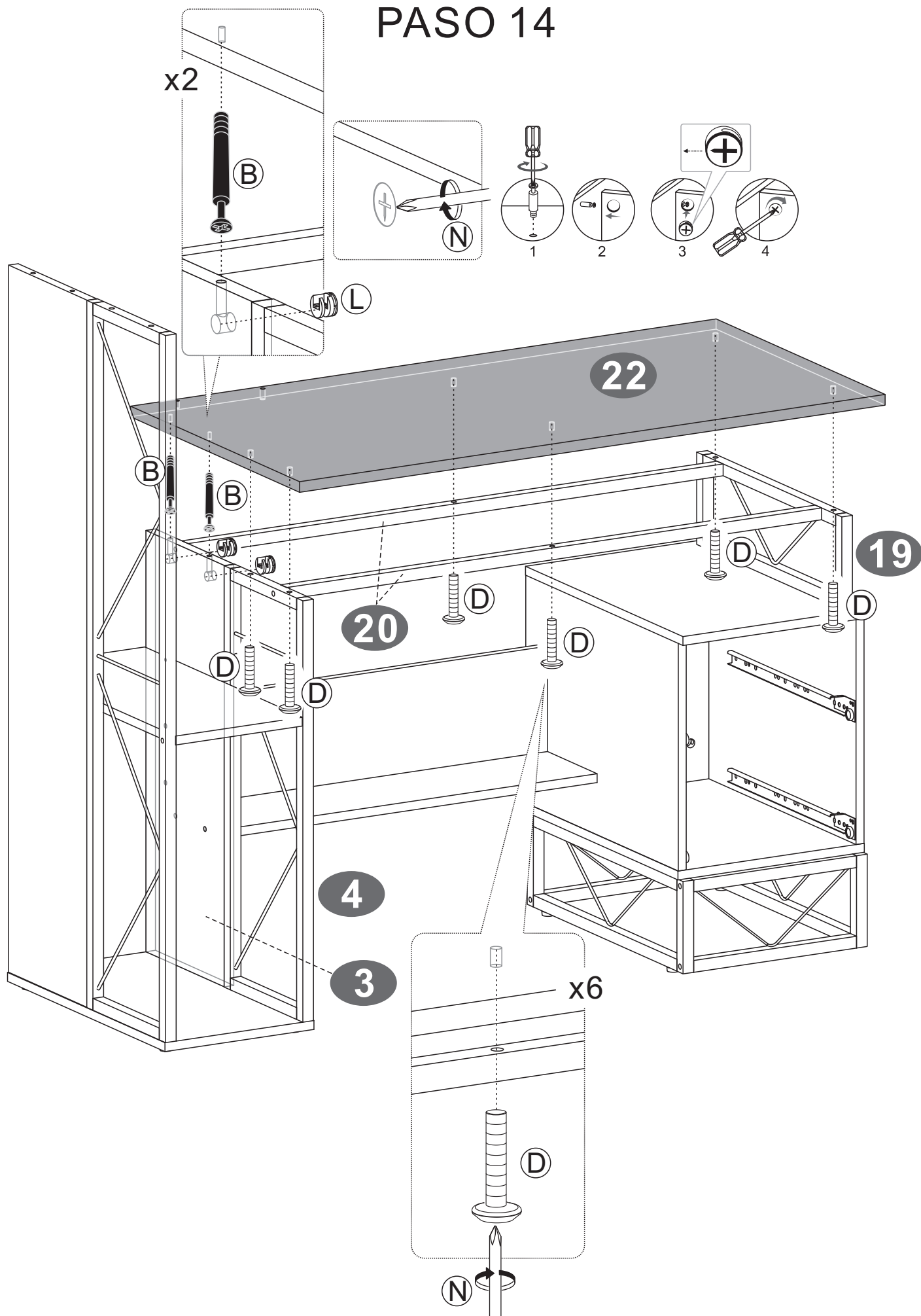

## PASO 15

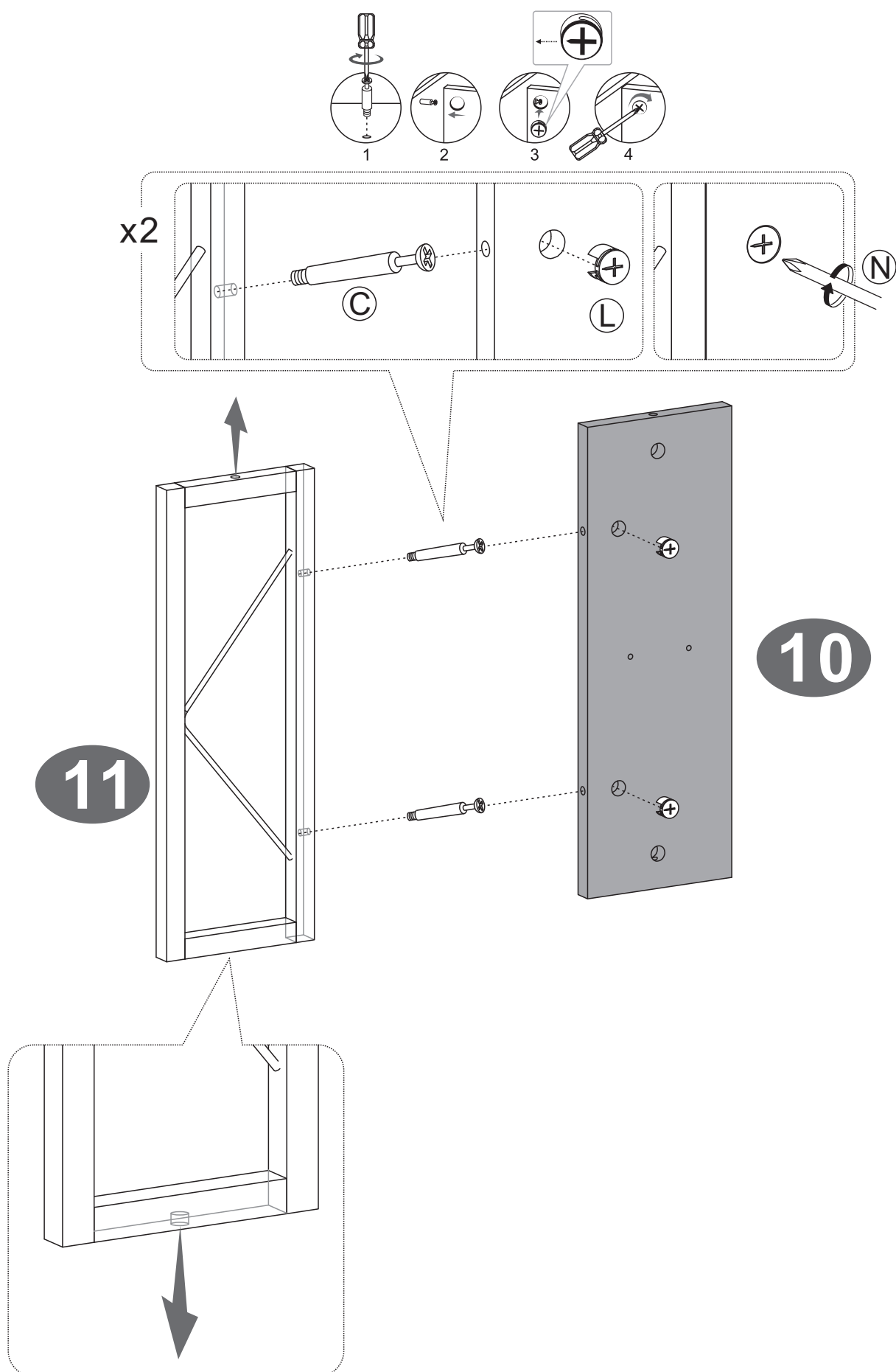

## PASO 16

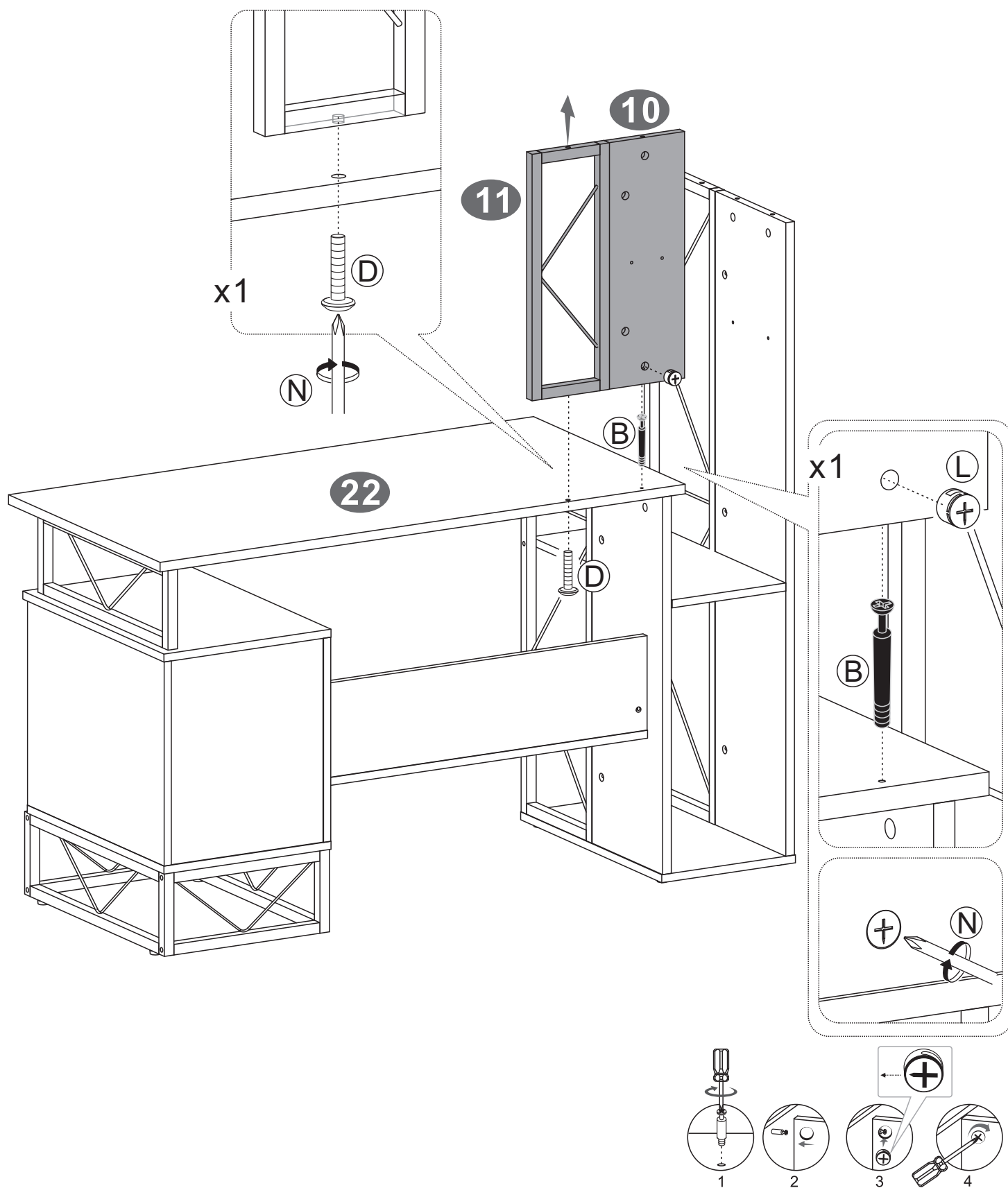

# PASO 17

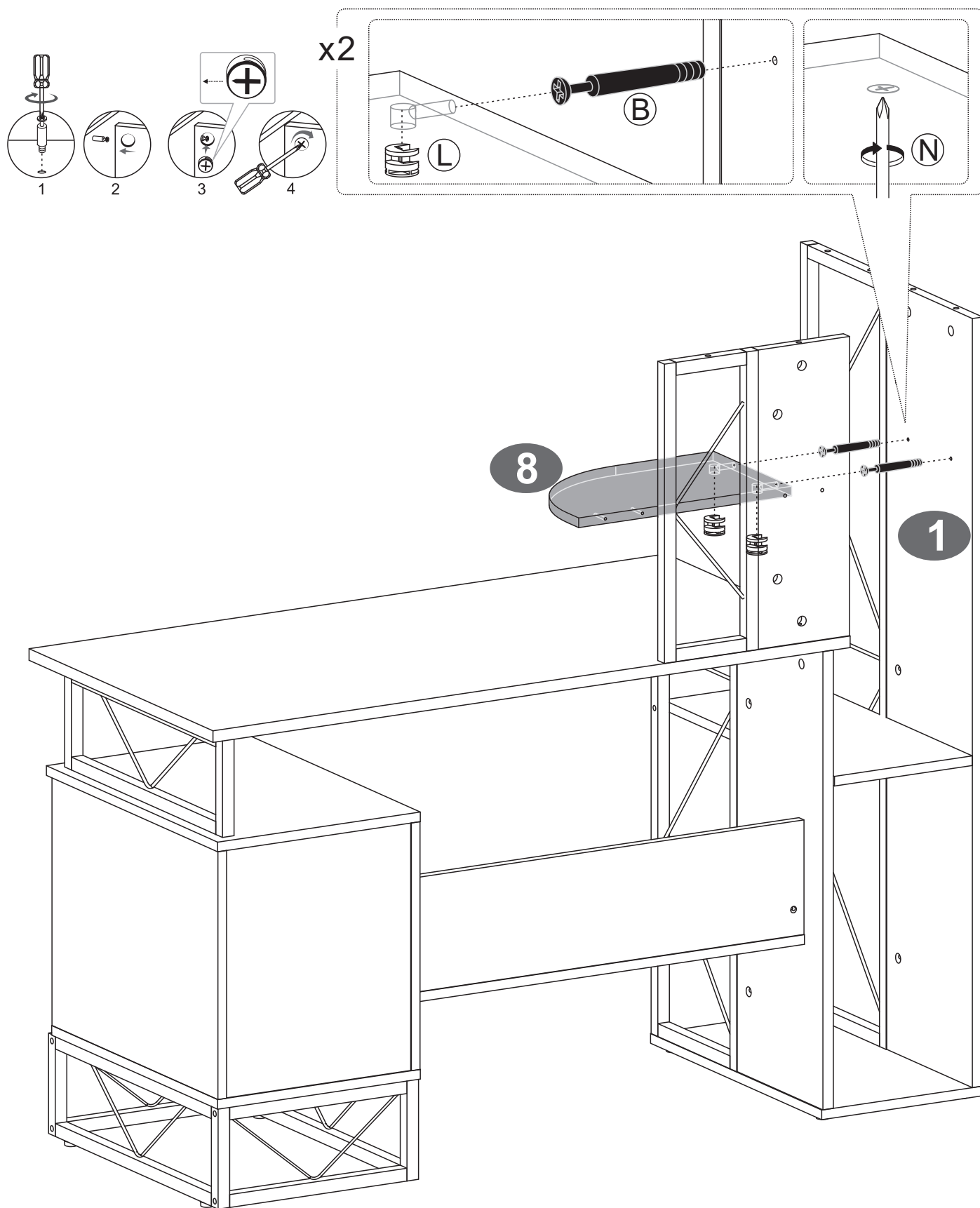

## PASO 18

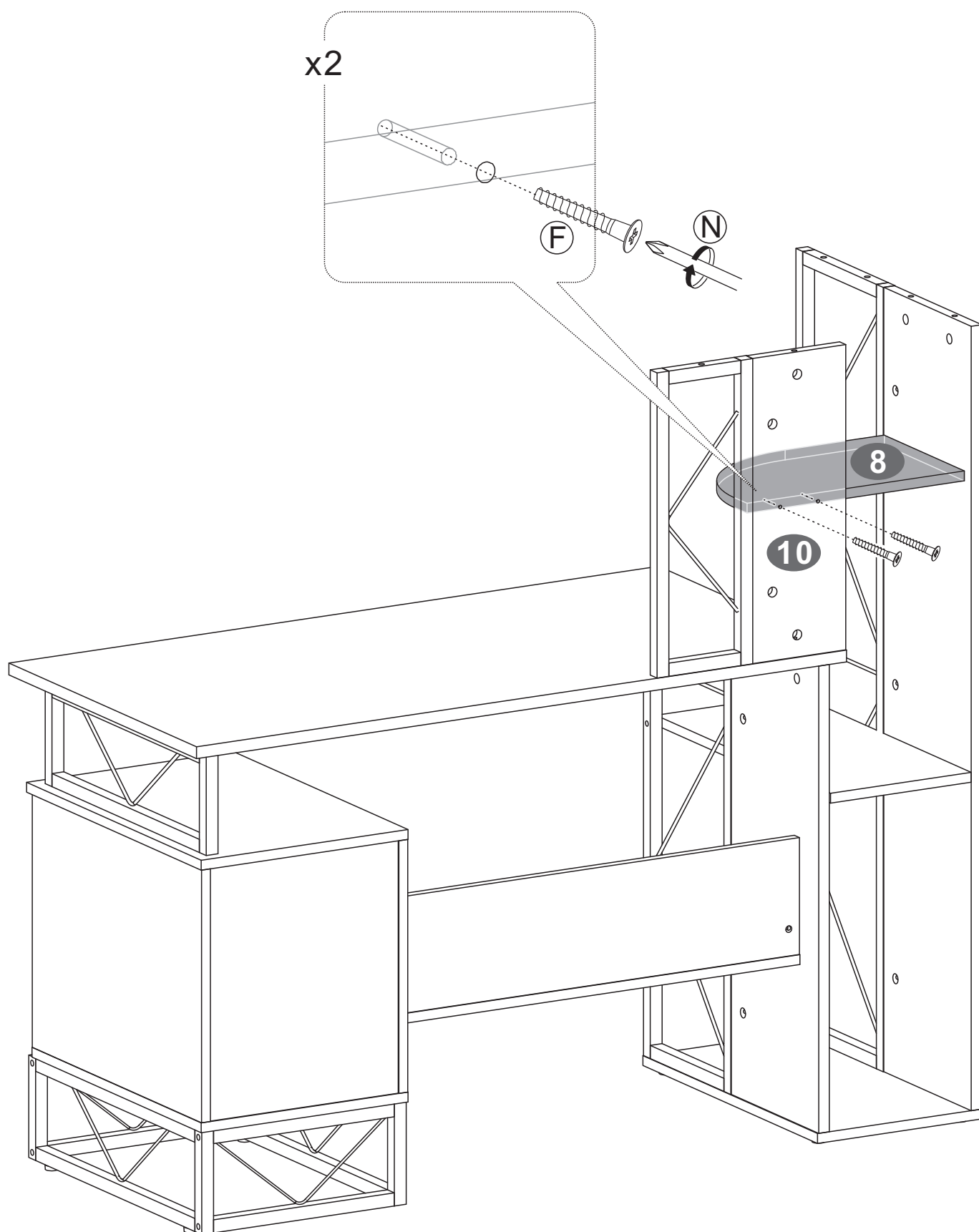

# PASO 19

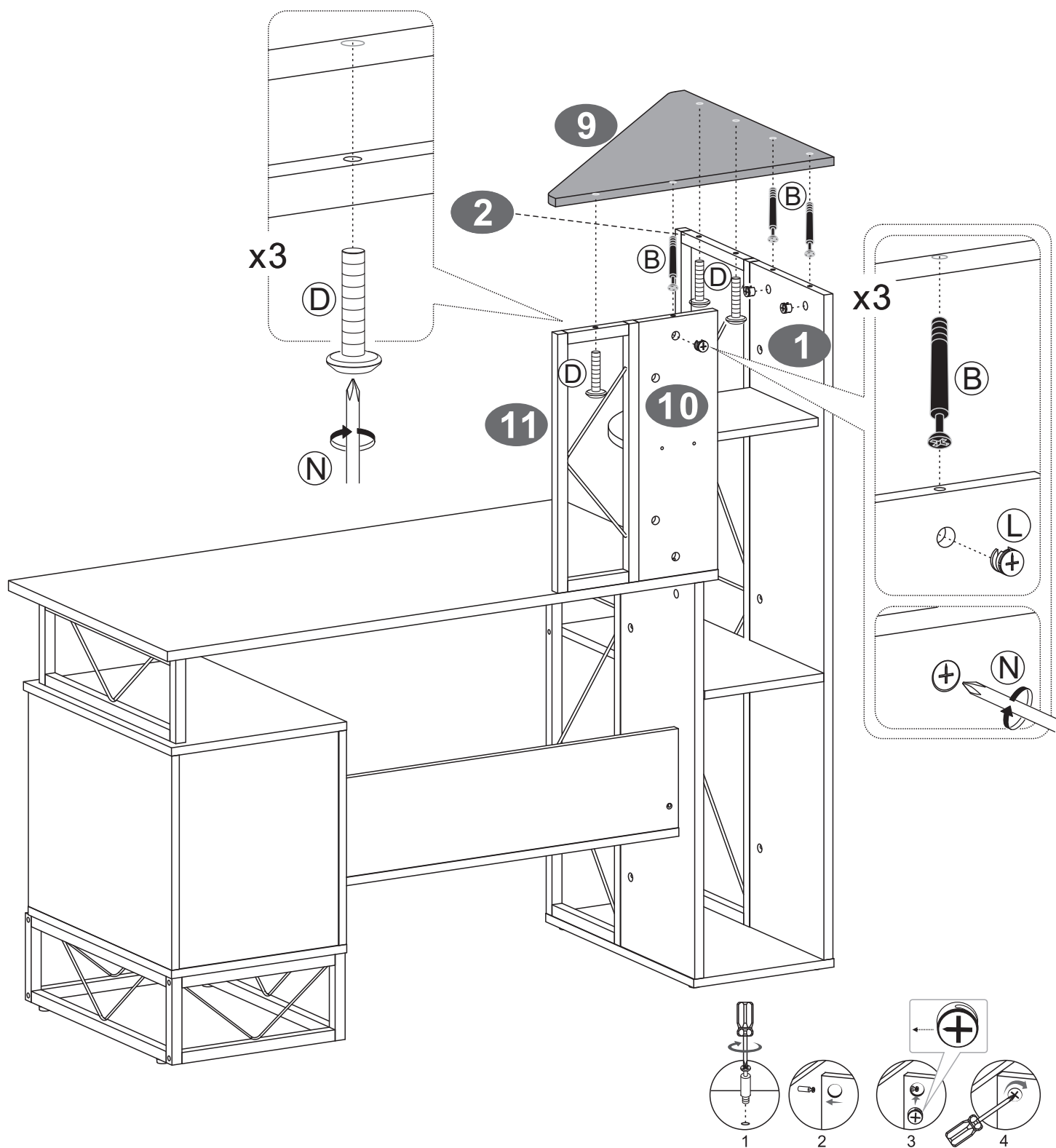



## PASO 20

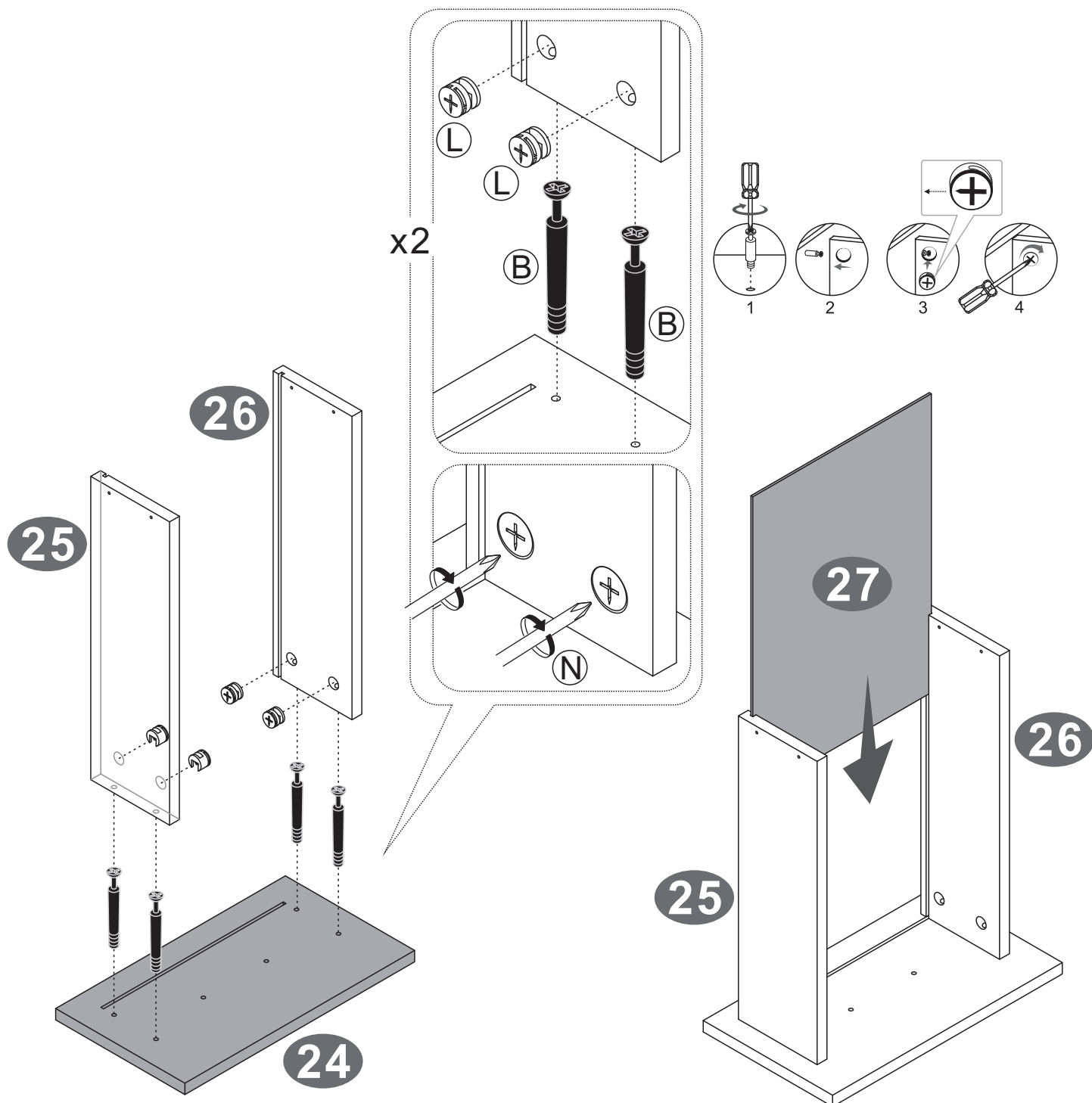

## PASO 21

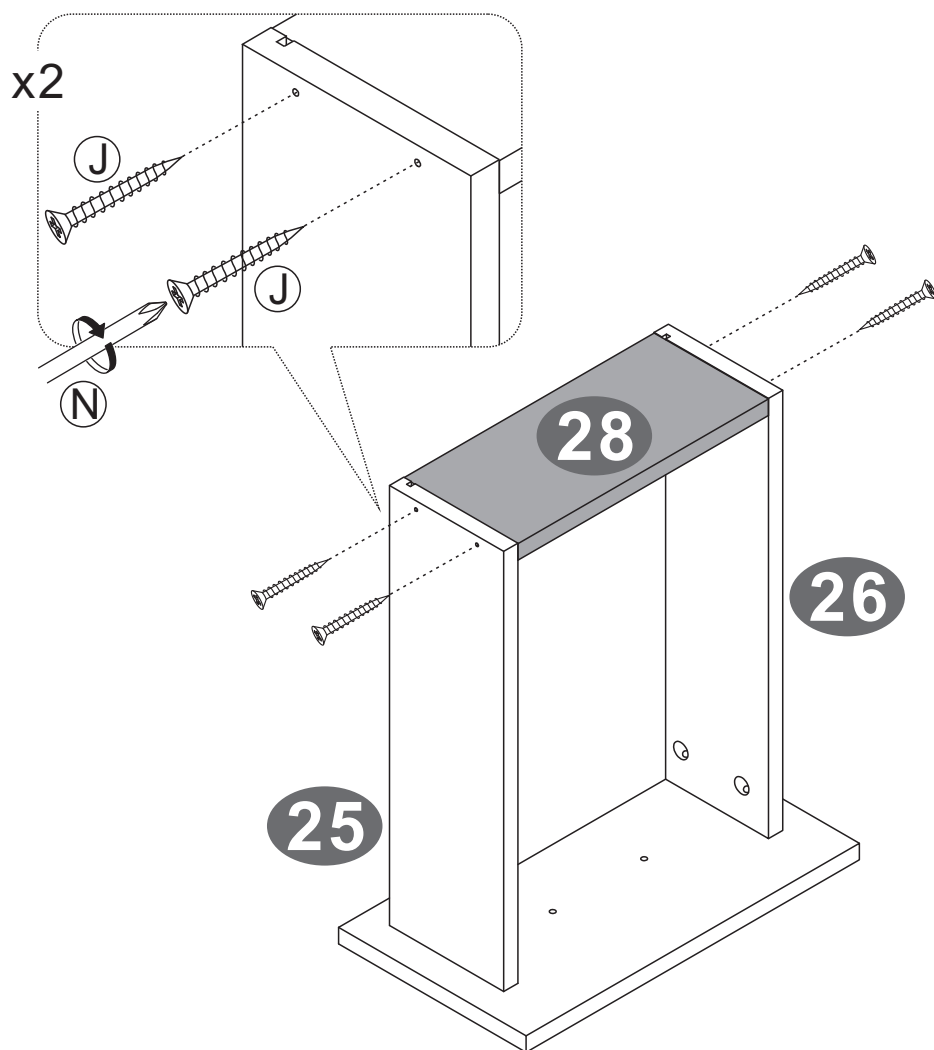

## PASO 22

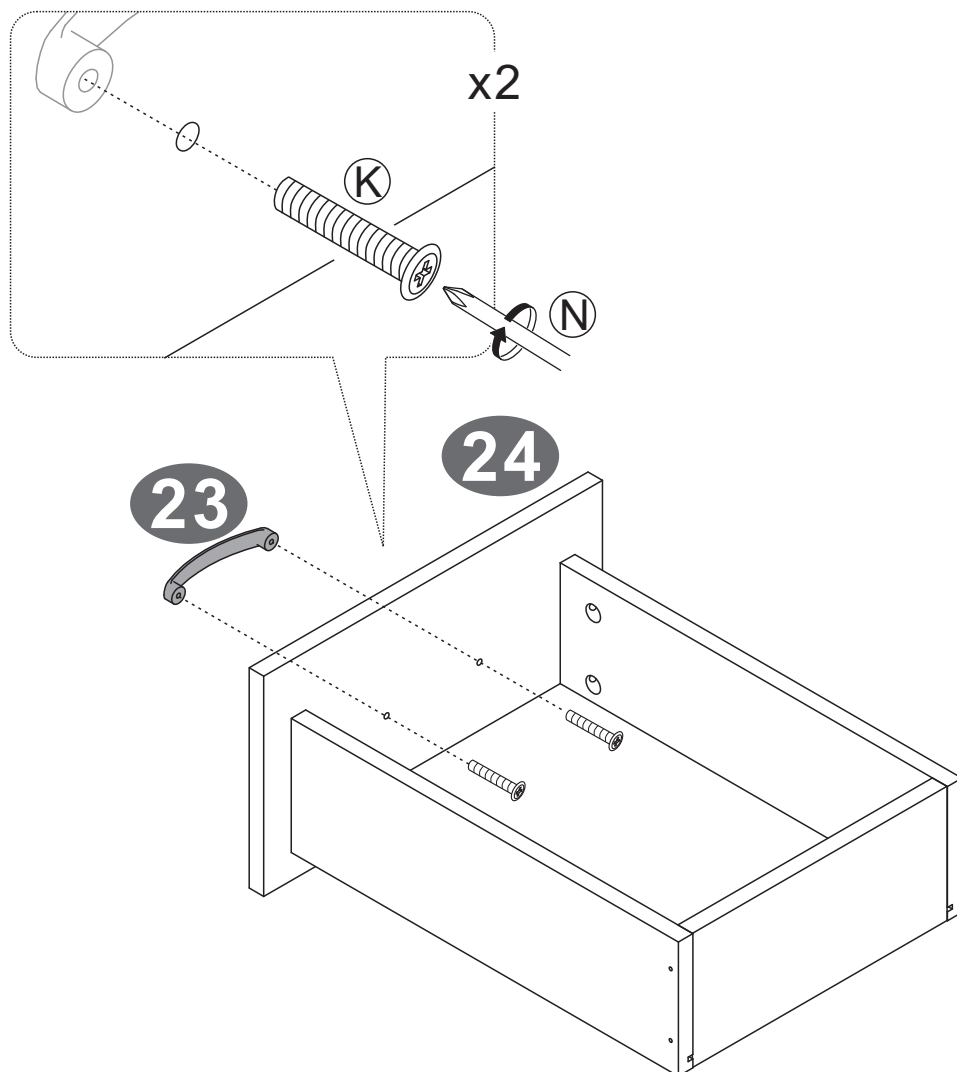

## PASO 23

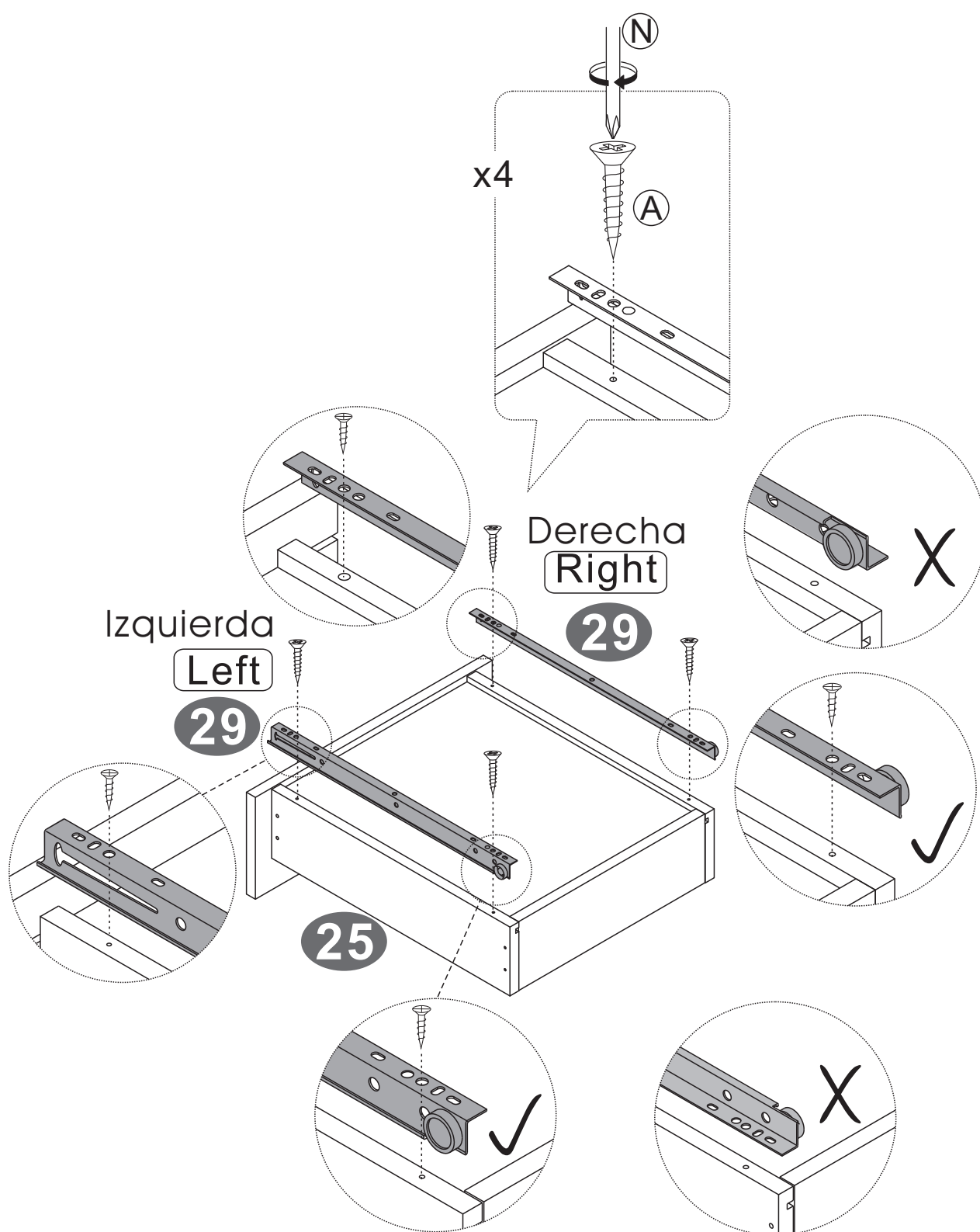

Repita el paso 20 al paso 23 para instalar el otro cajon

## PASO 24

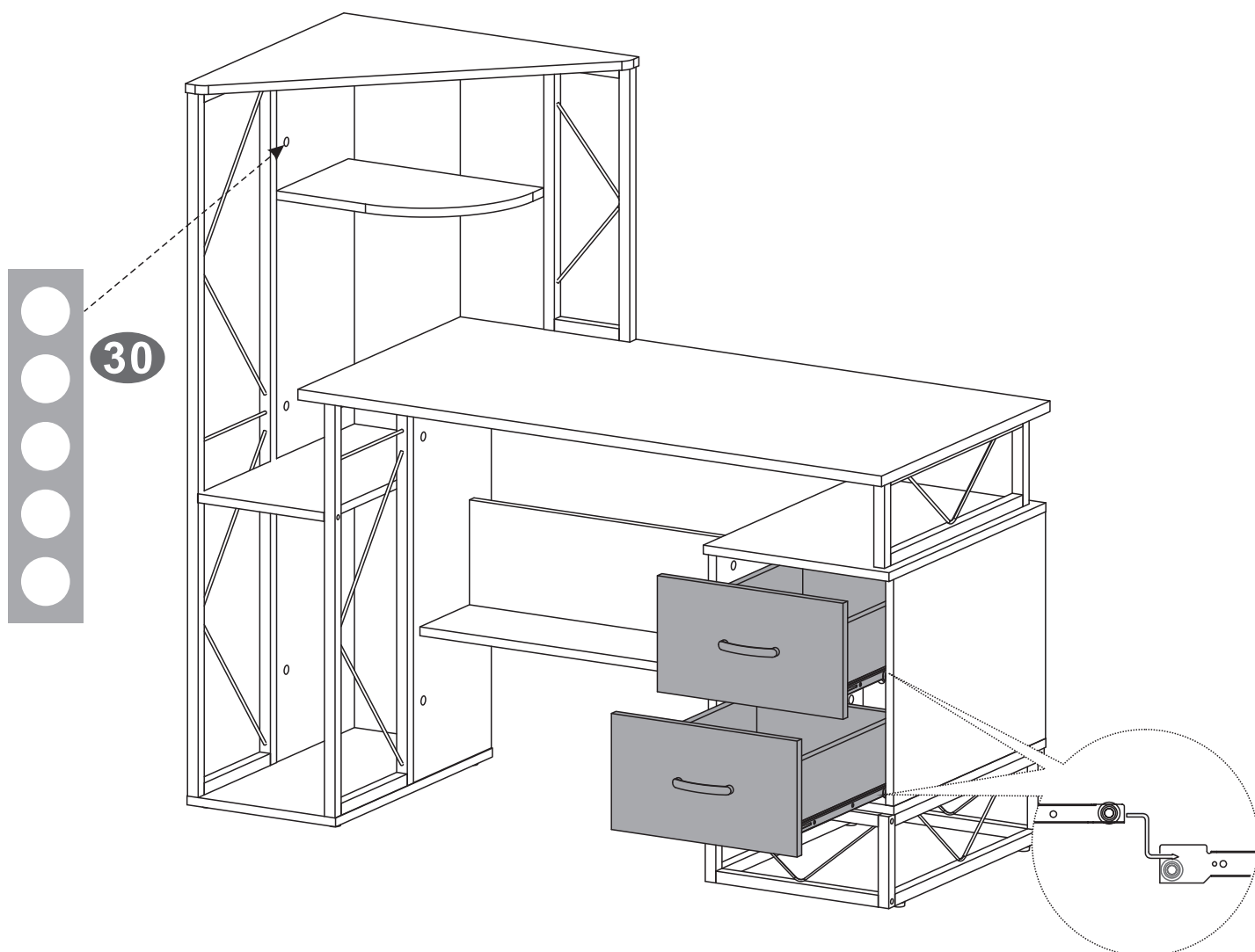



## **TODOS JUNTOS**

Entre todos sí es posible  
lograr un impacto real  
ahorrando papel.

