

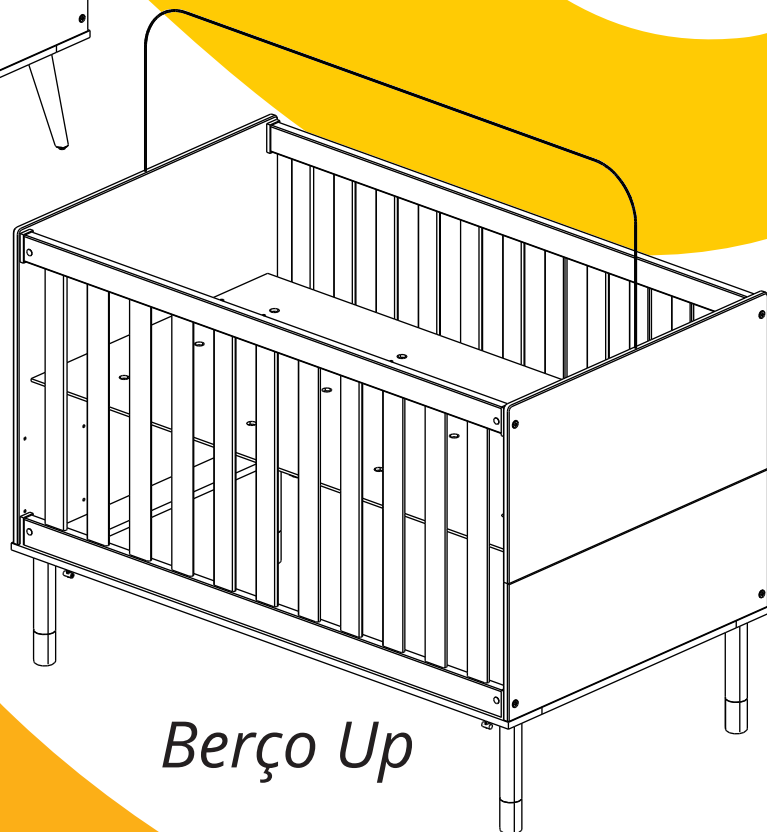

*Berço Gold*

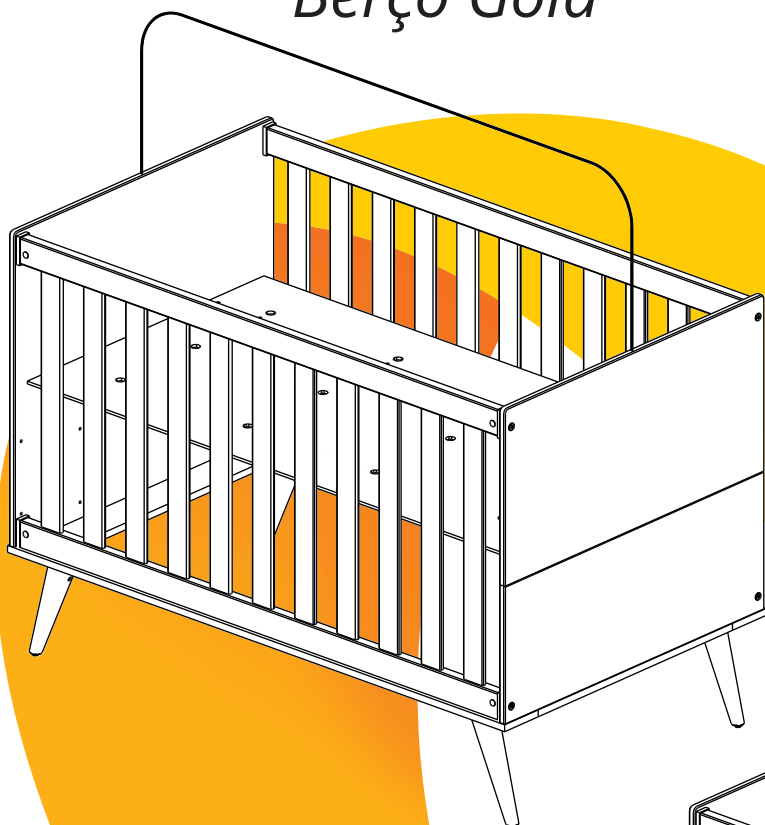

*Berço Up*

# ACESSÓRIOS

ACCESORIOS

A

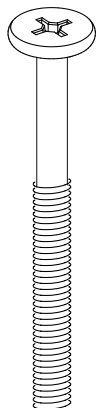

PARAFUSO ROSCA MQ  
1/4 x 60

**04 x**

B

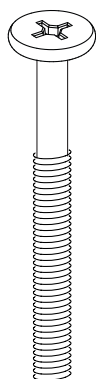

PARAFUSO MQ  
1/4 x 50

**08 x**

C

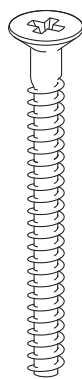

PARAFUSO CHATO  
5,0 x 50

**08 x**

D

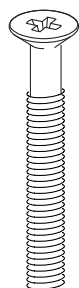

PARAFUSO MQ  
1/4 x 30

**06 x**

E

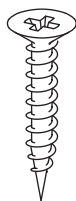

PARAFUSO CHATO  
3,5 x 22

**08 x**

F

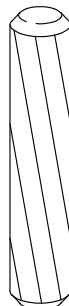

CAVILHA 8 x 40

**04 x**

G



CAVILHA 8 x 30

**08 x**

H



PÉ BOTÃO

**04 x**

I



PREGO  
8 x 8

**04 x**

J



BUCHA AMERICANA  
1/4 x 13

**06 x**

K

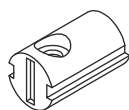

PORCA CILÍNDRICA  
1/4x10x20

**04 x**

L

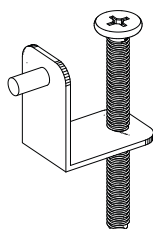

SUPOTE SARRAFO  
KIT

**01 x**

M

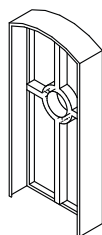

PONTEIRA GRADE  
INFERIOR

**04 x**

N

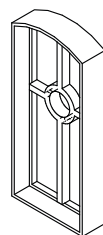

PONTEIRA GRADE  
INFERIOR

**04 x**

O

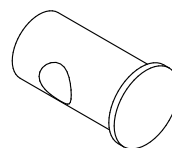

PORCA CILÍNDRICA  
PLÁST. 20x10x1/4

**08 x**

P

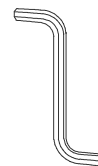

CHAVE ALLEN  
Ø6mm Z

**01 x**

## ACESSÓRIOS MINI CAMA

ACCESORIOS MINI CAMA

Q

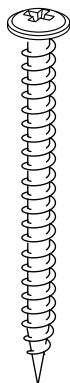

PARAFUSO FLANGEADO  
5,0 x 50

**04 x**

R



CAVILHA 8 x 30

**04 x**

S



CAVILHA 6 x 30

**04 x**

T

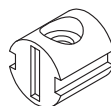

PORCA CILÍNDRICA  
10x10x1/4

**04 x**

# VISTA GERAL

VISIÓN DE CONJUNTO

*Berço Gold*

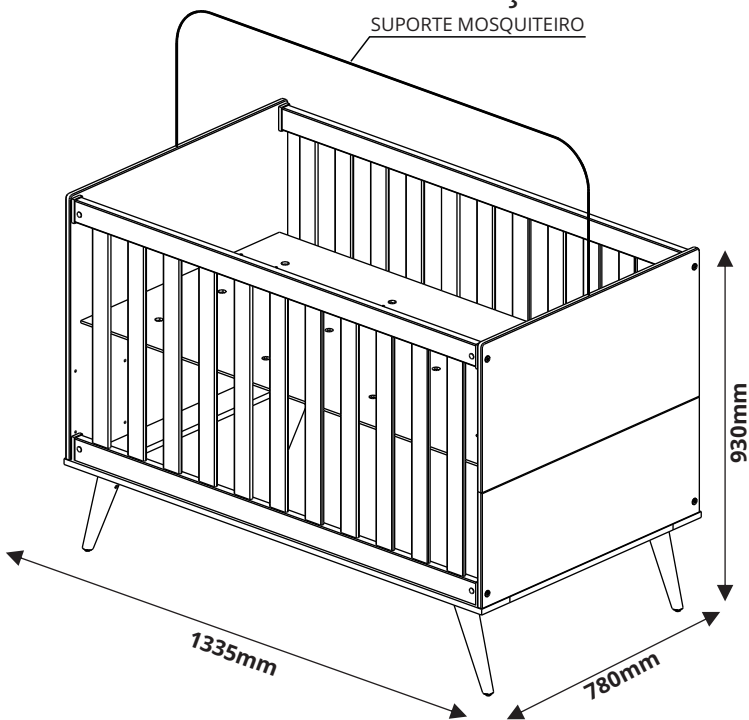

*Berço Up*

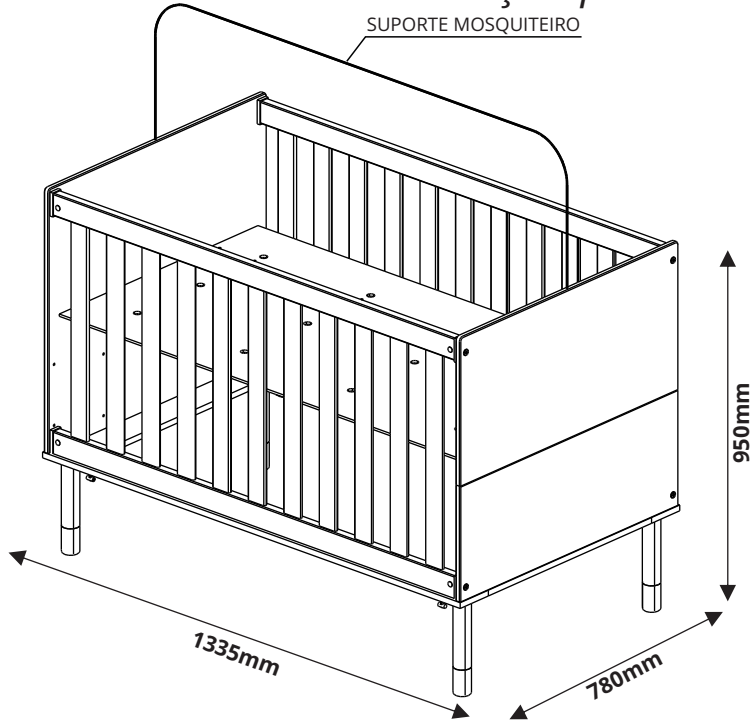

## PEÇAS

PIEZAS

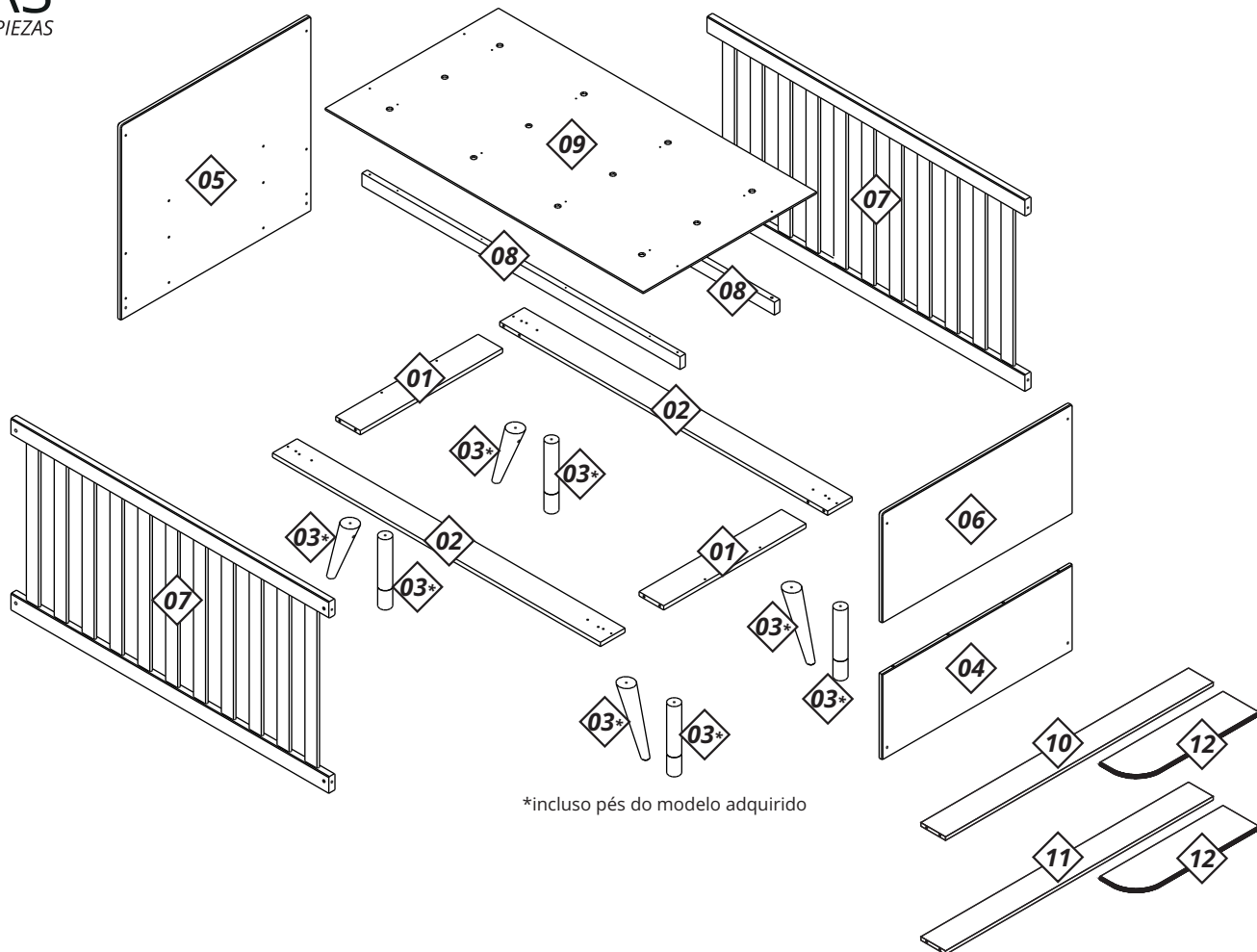

# MONTAGEM

MONTAJE

## IMPORTANTE

IMPORTANTE

A MONTAGEM DEVE SER REALIZADA POR UM PROFISSIONAL DE MONTAGEM.  
EL MONTAJE DEBE SER HECHO POR UN MONTADOR DE MUEBLES.

1

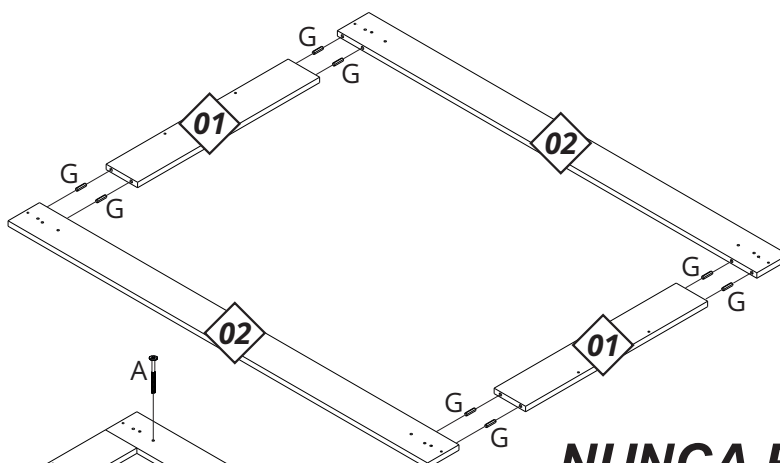

## 2 Berço Gold

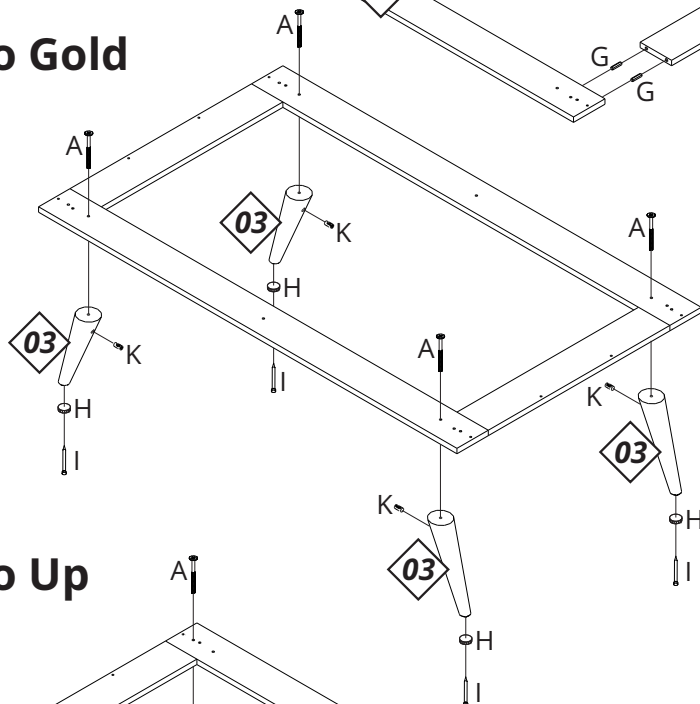

**NUNCA REMOVER OS  
ACESSÓRIOS "I+H"  
DO COMPONENTE "03".**

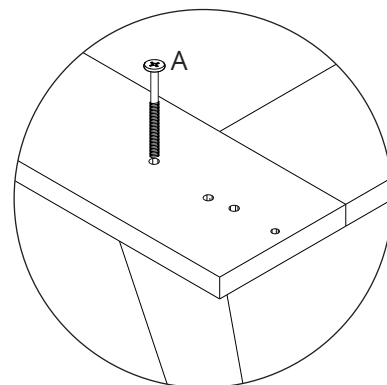

NO MODELO GOLD, UTILIZE A 4ª FURAÇÃO  
PARA FIXAR OS PÉS

## 2 Berço Up

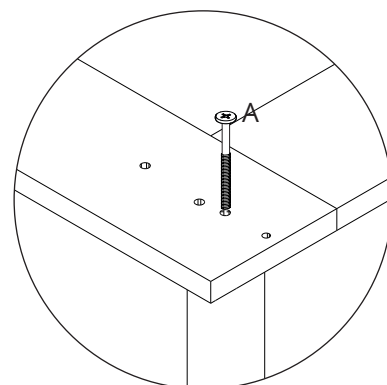
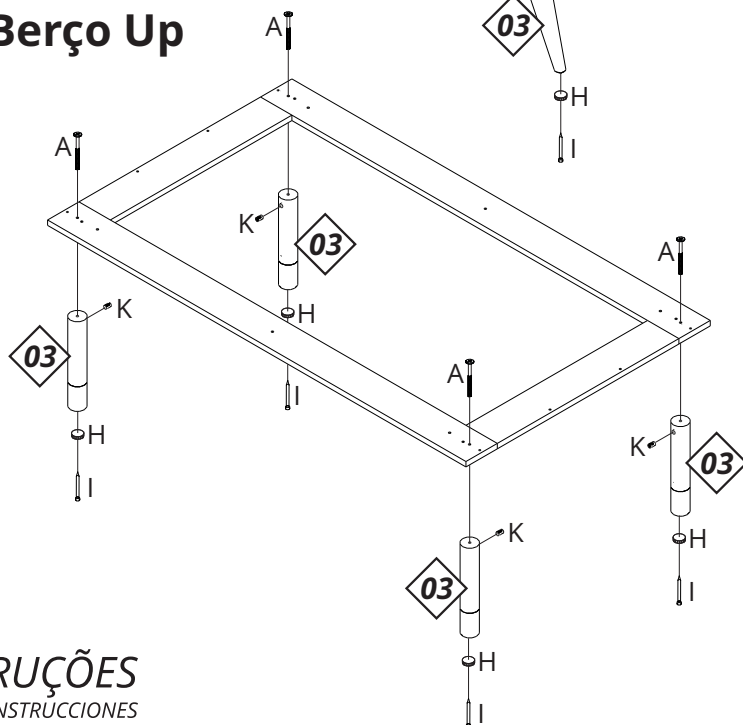

NO MODELO UP, UTILIZE A 2ª FURAÇÃO  
PARA FIXAR OS PÉS

## INSTRUÇÕES

INSTRUCCIONES

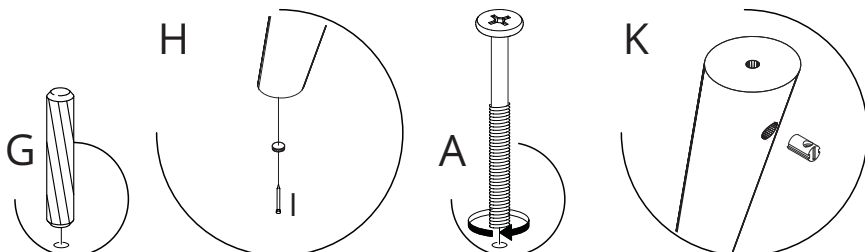

# MONTAGEM

MONTAJE

3

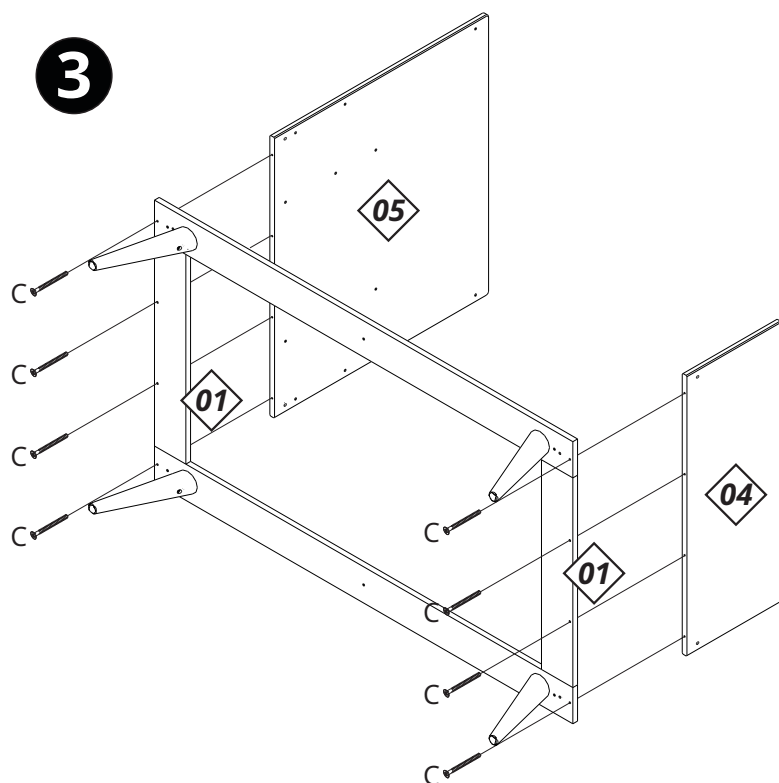

**NUNCA REMOVER O PARAFUSO "C" DOS CONJUNTOS "01 E 04" E "01 E 05".**

4

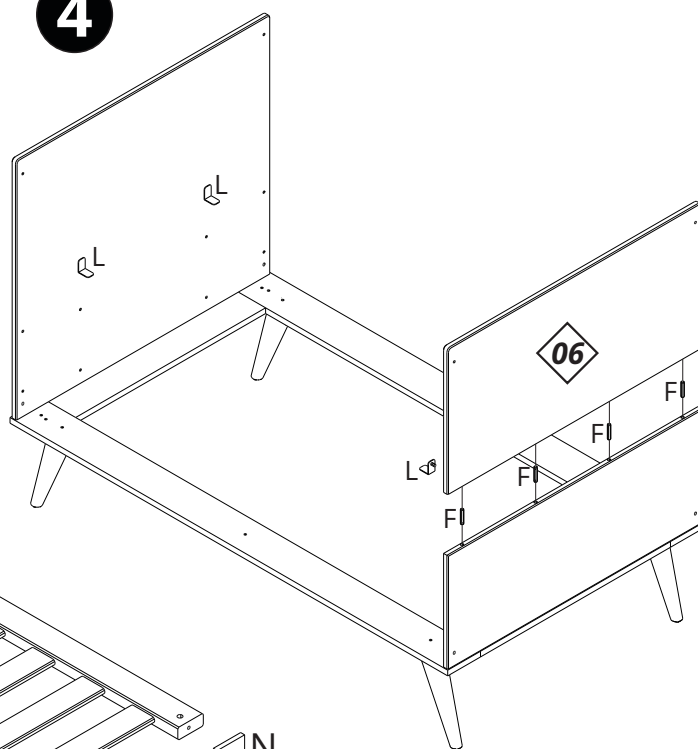

5

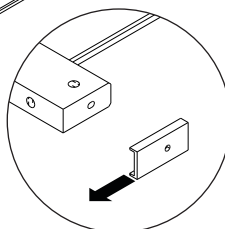
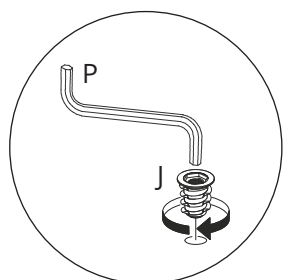
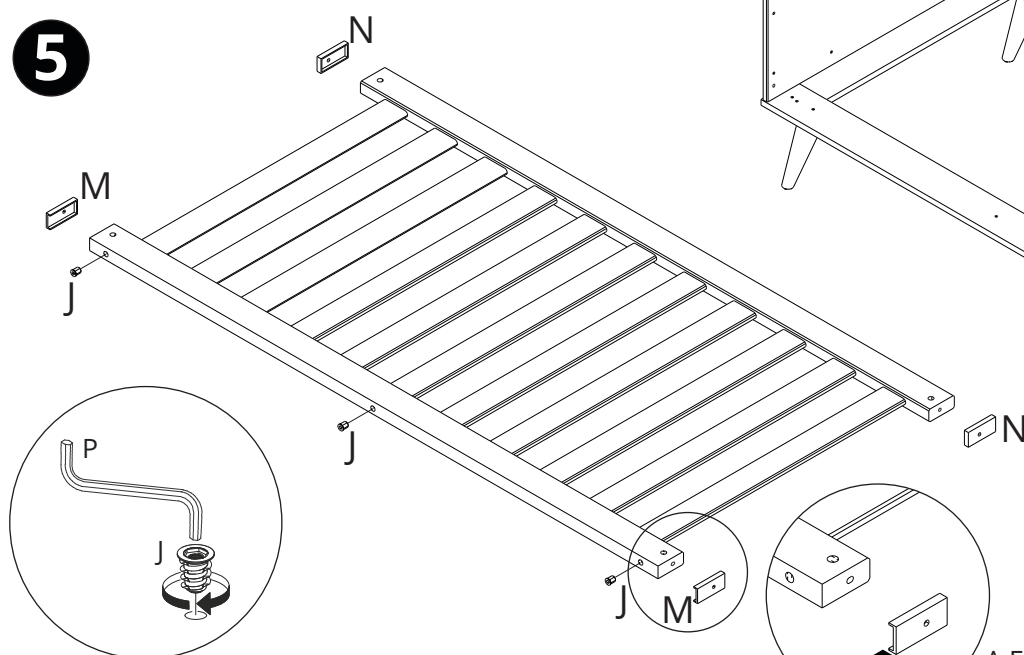

**INSTRUÇÕES**  
INSTRUCCIONES

A FACE ABERTA DA PONTEIRA "M"  
DEVE SER FIXADA PARA BAIXO  
NOS SARRAFOS INFERIORES DAS GRADES

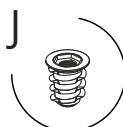
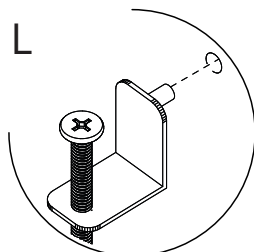
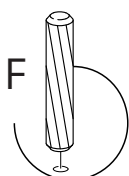
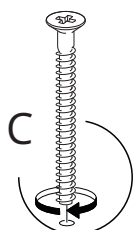

# MONTAGEM

MONTAJE

6

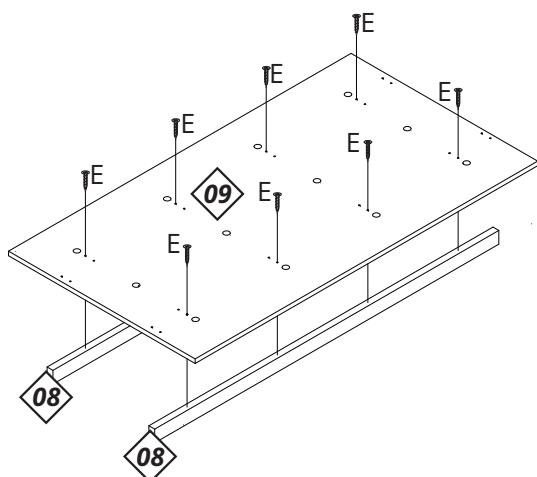

7

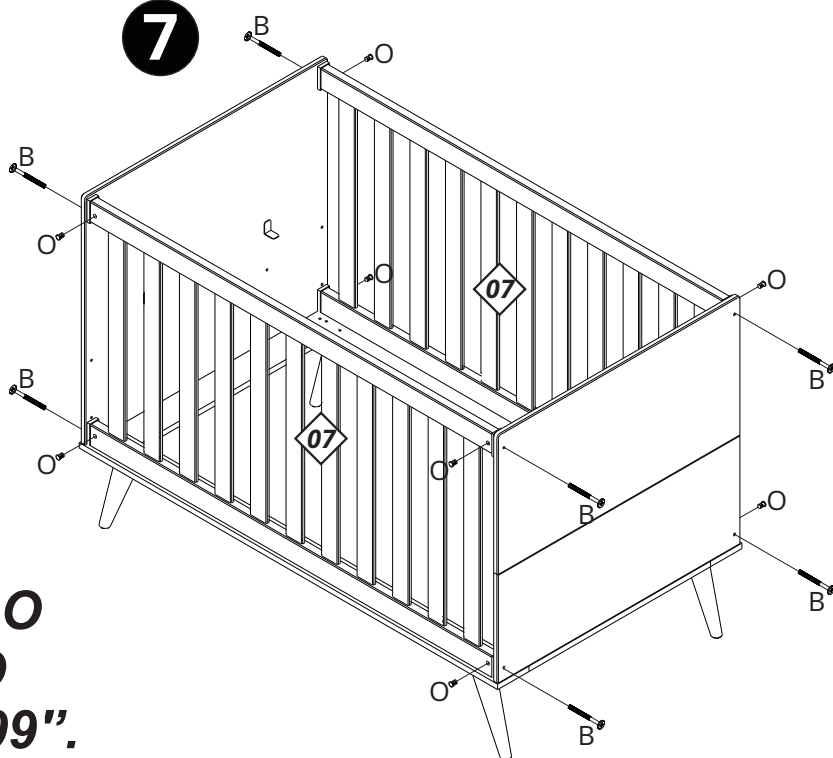

**NUNCA REMOVER O  
PARAFUSO "E" DO  
CONJUNTO "08 E 09".**

8

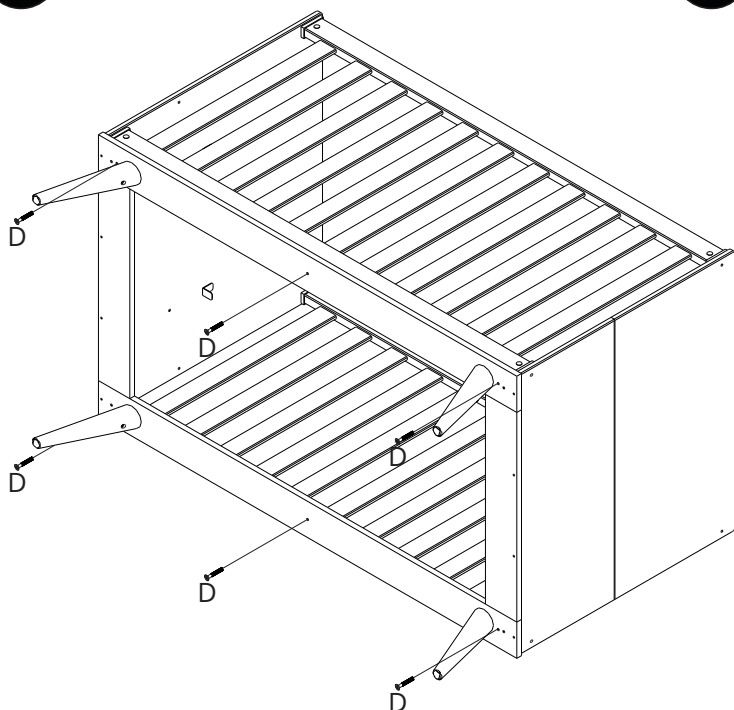

9

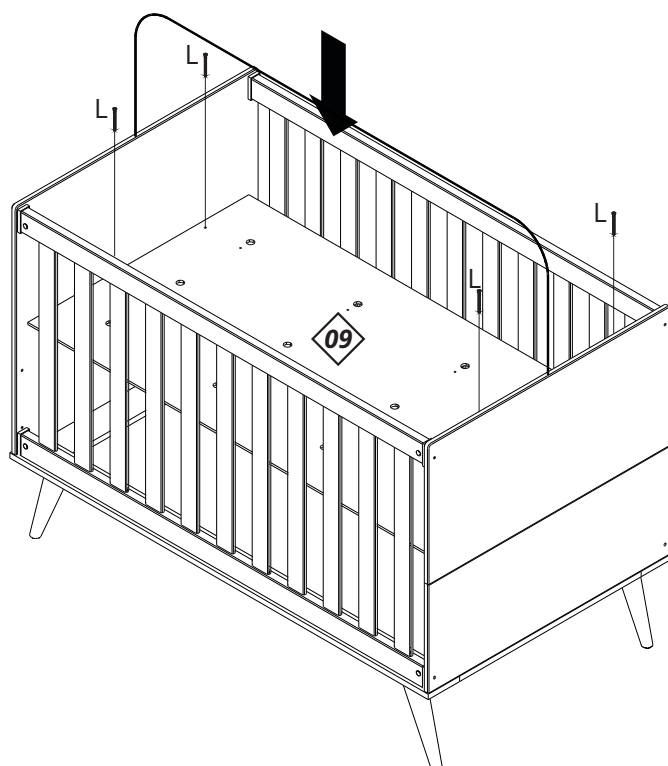

**INSTRUÇÕES**  
INSTRUCCIONES

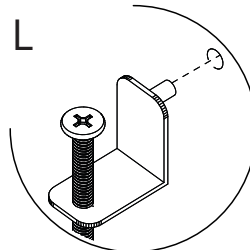
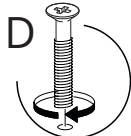
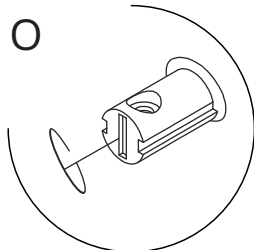
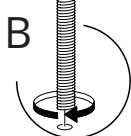
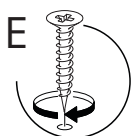

# TRANSFORMANDO EM MINI CAMA

**QUANDO TRANSFORMADO EM  
MINI CAMA, NÃO REUTILIZAR  
COMO BERÇO.**

**2**

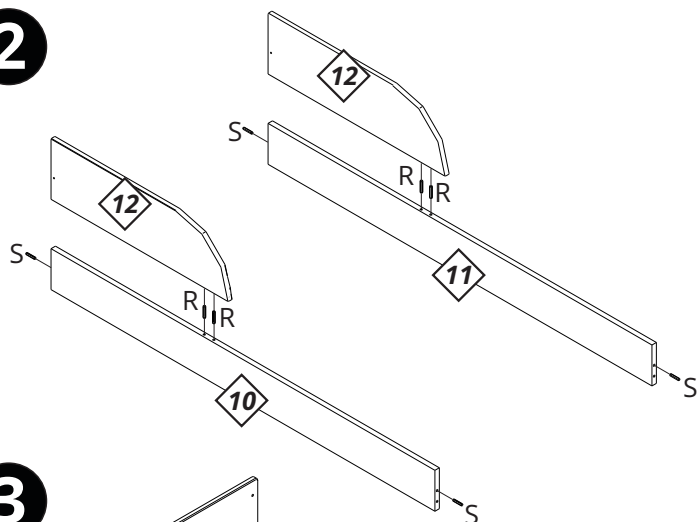

**1**

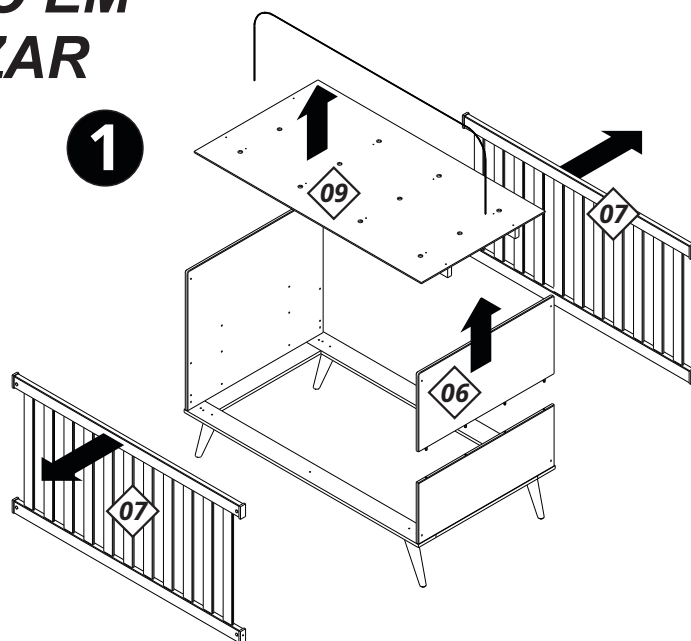

**3**

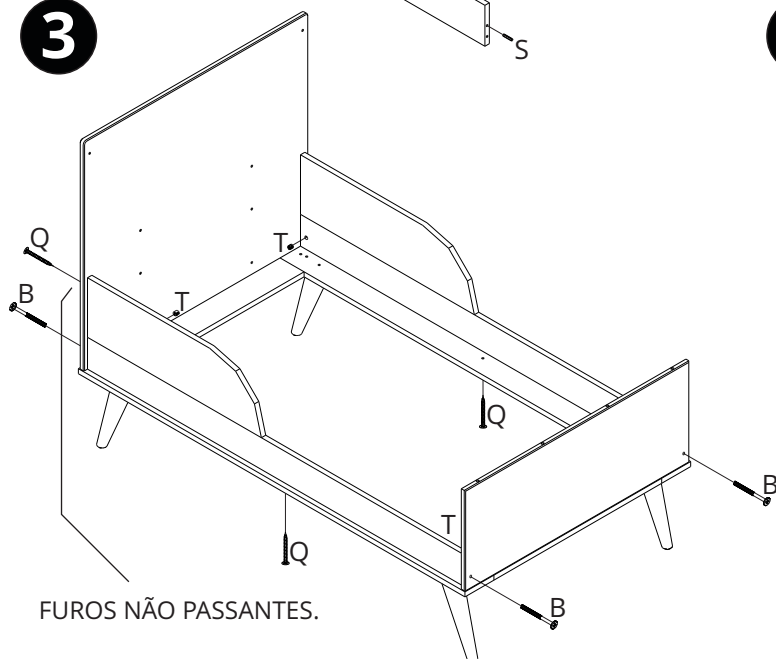

FUROS NÃO PASSANTES.

**4**

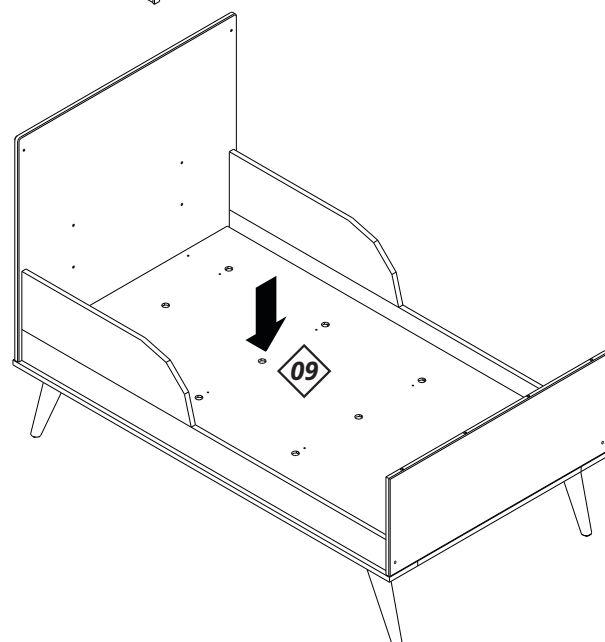

**ESTE PRODUTO ATENDE À  
REGULAMENTAÇÃO PARA BERÇOS  
INFANTIS, NÃO SENDO AS SUAS  
DEMAIS FUNÇÕES SUJEITAS À  
REGULAMENTAÇÃO.**

**INSTRUÇÕES**  
INSTRUCCIONES

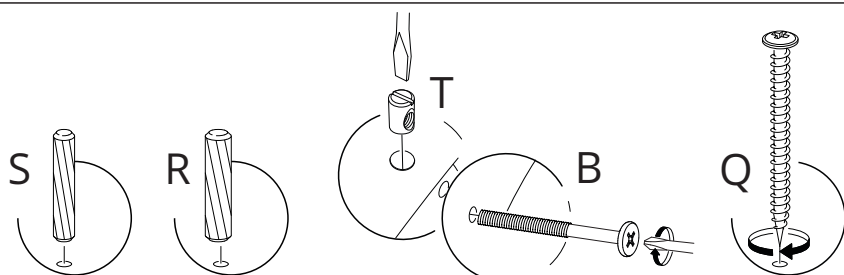

# DESMONTANDO PARA LOCOMOÇÃO

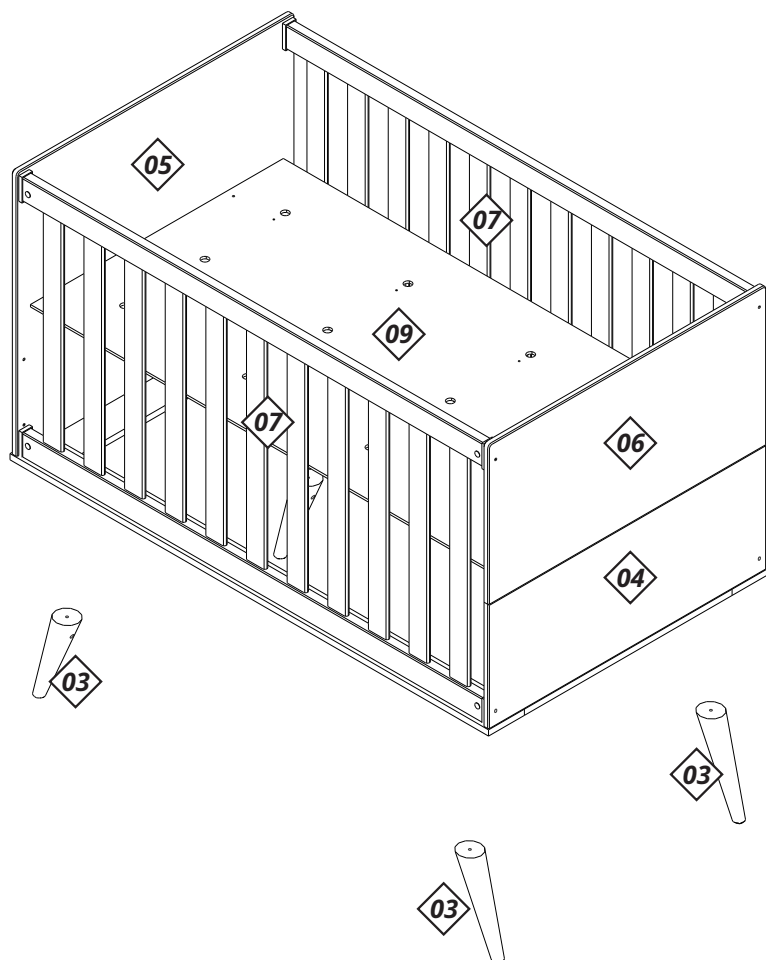

**PARA QUALQUER CONVERSÃO,  
DESMONTAGEM PARA TRANSPORTE  
OU ARMAZENAMENTO NUNCA  
DESMONTAR O CONJUNTO  
"01, 02, 04, 05, 06, 07, 08 E 09",  
É NECESSÁRIO APENAS  
REMOVER OS PÉS "03".**

