

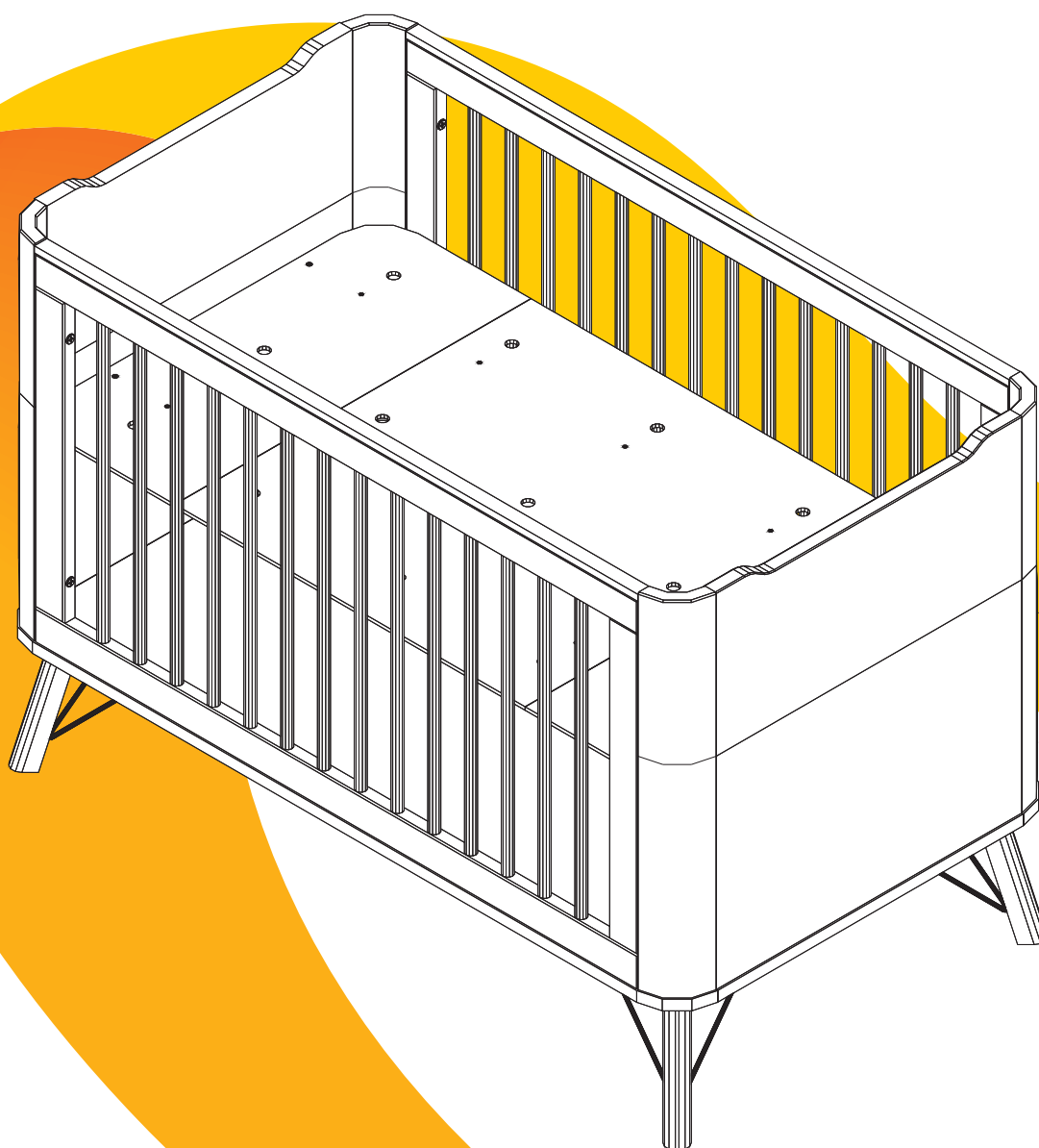

Berço Albi



BERÇO ALBI V00 REV. 10/12/2018

CNPJ: 07.203.655 / 0001-06
www.maticmoveis.com.br
matmoveis@matmoveis.com.br
SAC: 17 3283-9700
JACI/SP

ACESSÓRIOS

ACCESORIOS

A

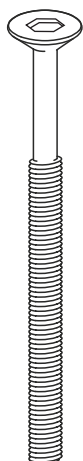

ALLEN CAB. 13 1/4 x 60

08 x

B

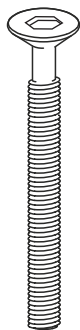

ALLEN CAB. 13 1/4 x 50

08 x

C

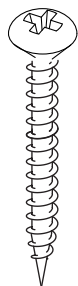

PARAFUSO PANELA
4,0x30

04 x

D

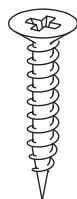

PARAFUSO CHATO
3,5x22

26 x

E



PARAFUSO PANELA
4,0x16

16 x

F



CAVILHA 8x40

24 x

G



CONECTOR
OCULTO

32 x

H

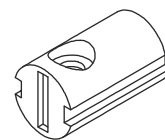

PORCA CILÍNDRICA
20x10x1/4

04 x

I



BUCHA AMERICANA
1/4 x 15

20 x

J



BUCHA AMERICANA
M4X10

16 x

K

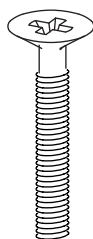

PARAFUSO CHATO
M4X25

16 x

L

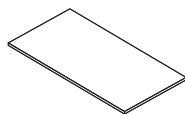

FILTRO
ADESIVO

04 x

M

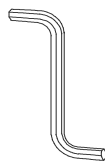

CHAVE ALLEN
Ø4mm Z

01 x

N

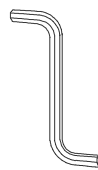

CHAVE ALLEN
Ø6mm Z

01 x

O



CHAPINHA
2 FUROS

04 x

P

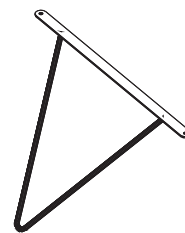

ARAMADO PARA PÉ

04 x

Q

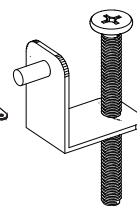

SUPORTE SARRAFO
KIT

01 x

ACESSÓRIOS MINI CAMA

ACCESORIOS MINI CAMA

R

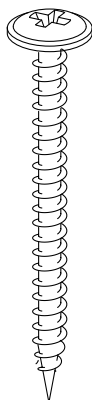

PARAFUSO FLANGEADO
5x50

04 x

S



PINO MINI FIX

08 x

T



CASTANHA MINI FIX
12x9

08 x

U



CAVILHA 8 x 30

08 x

VISTA GERAL

VISIÓN DE CONJUNTO

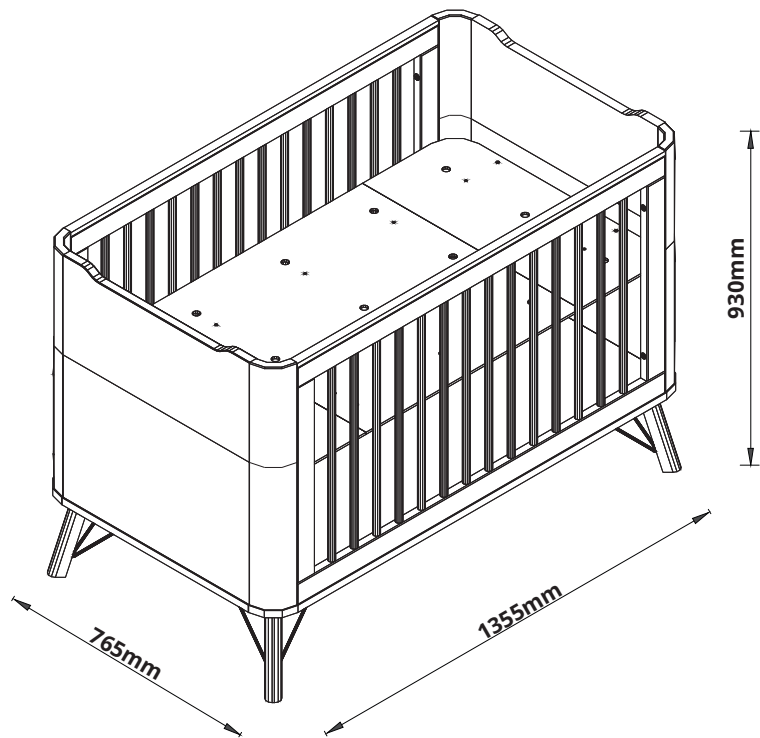

PEÇAS

PIEZAS

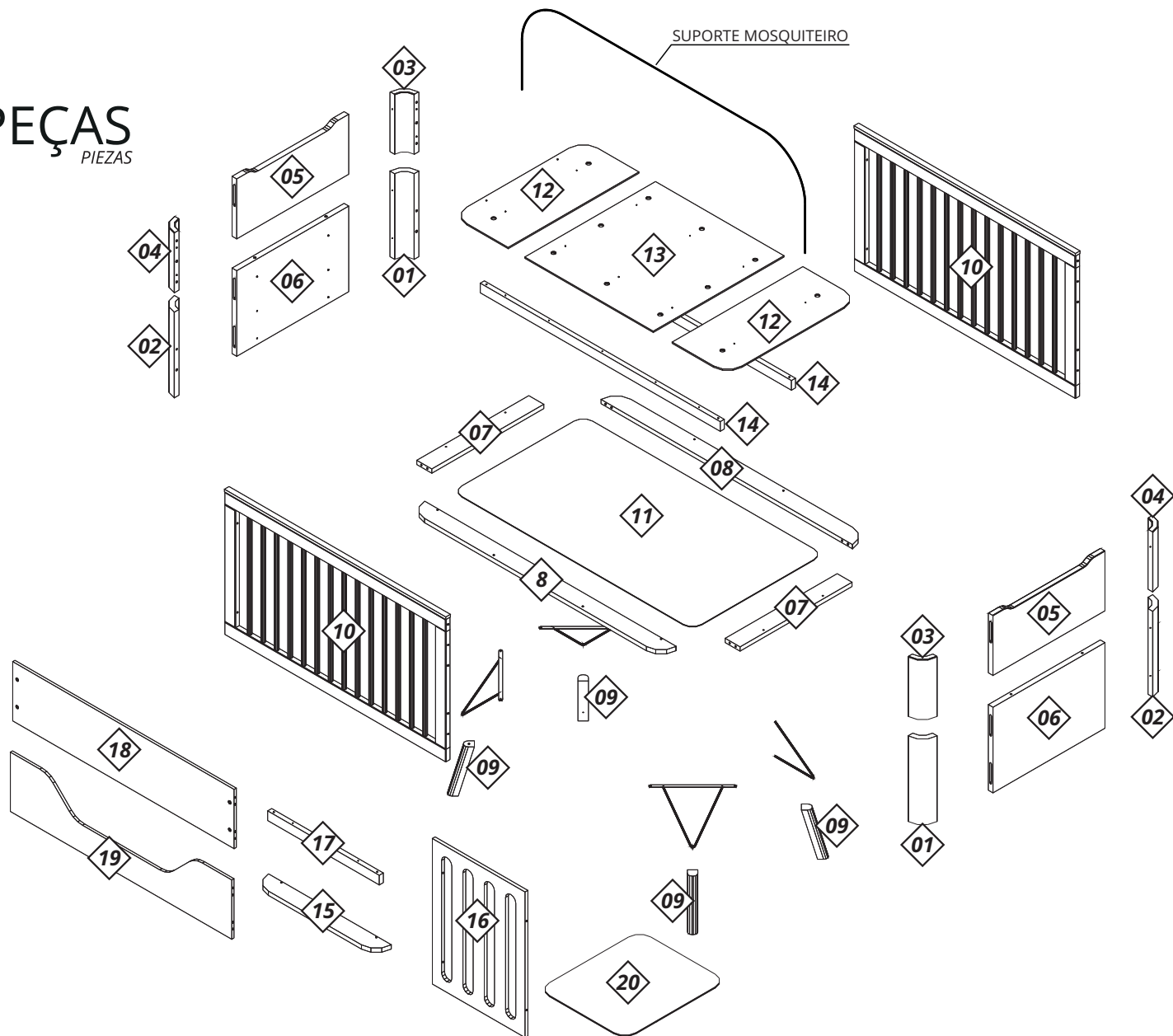

MONTAGEM

MONTAJE

IMPORTANTE

IMPORTANTE

A MONTAGEM DEVE SER REALIZADA POR UM PROFISSIONAL DE MONTAGEM.
EL MONTAJE DEBE SER HECHO POR UN MONTADOR DE MUEBLES.

1

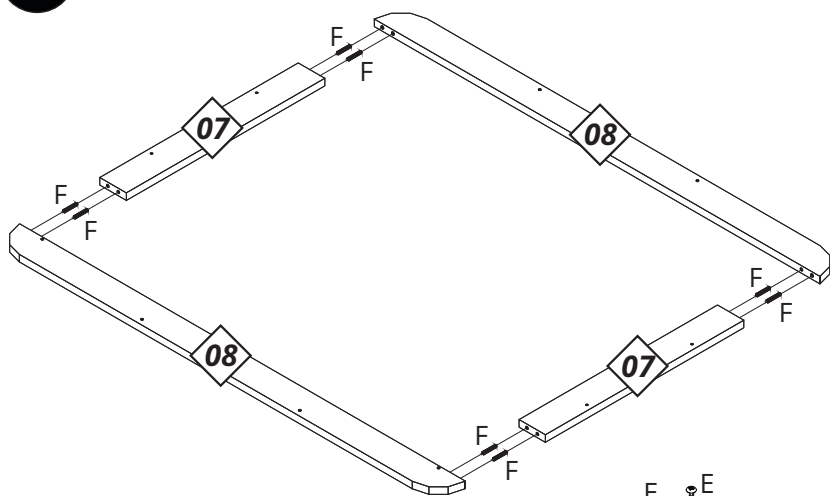

2

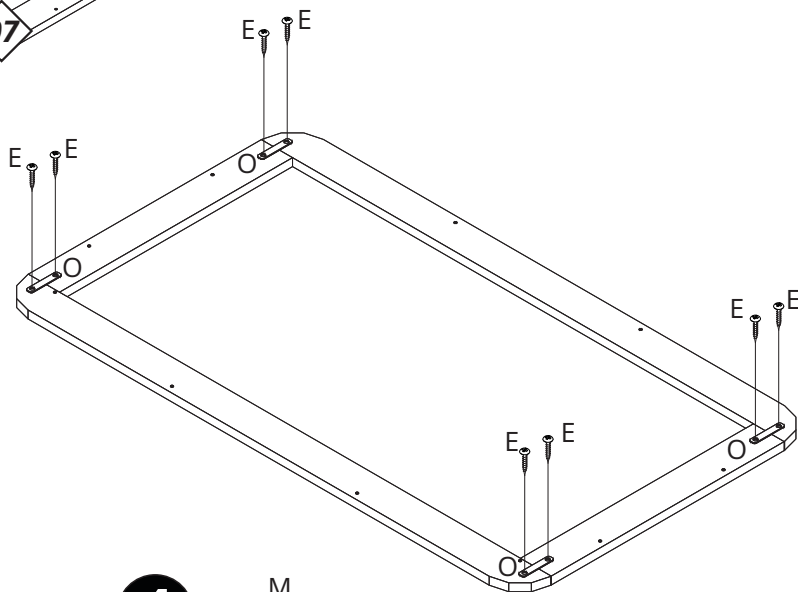

3

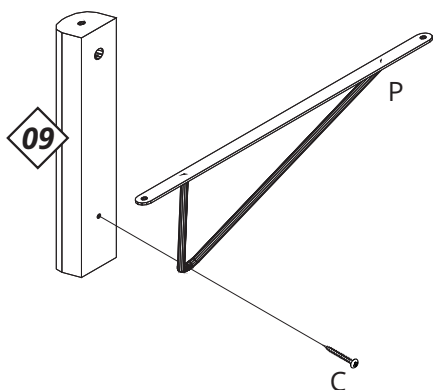

4

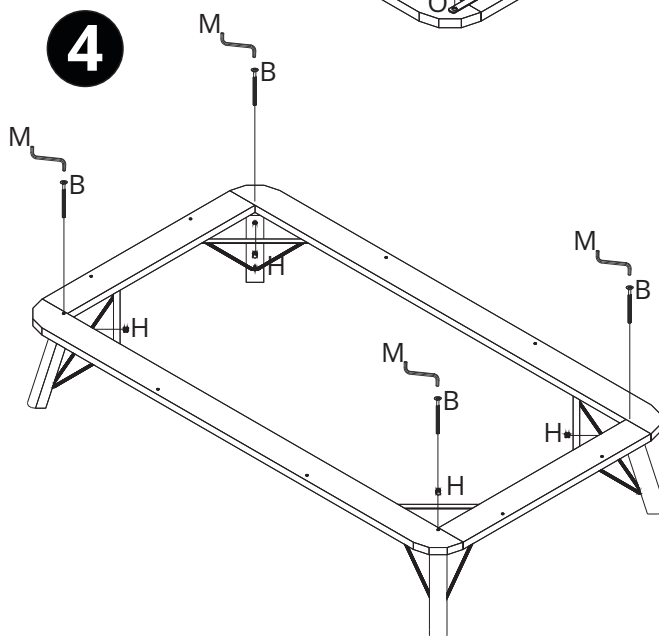

INSTRUÇÕES

INSTRUCCIONES

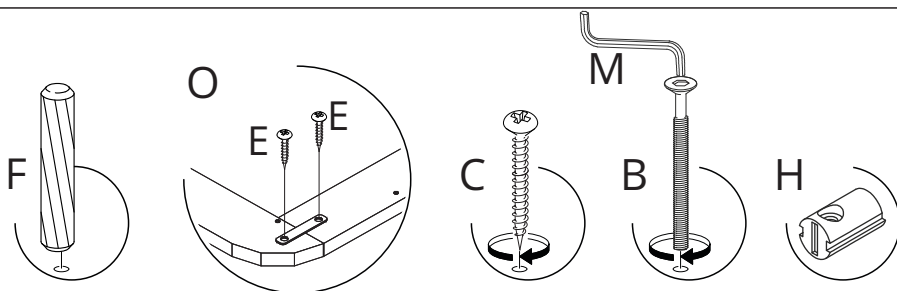

MONTAGEM

MONTAJE

5

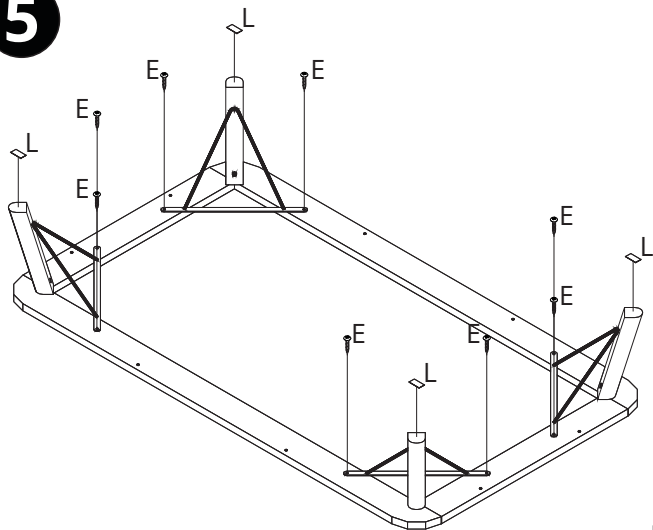

6

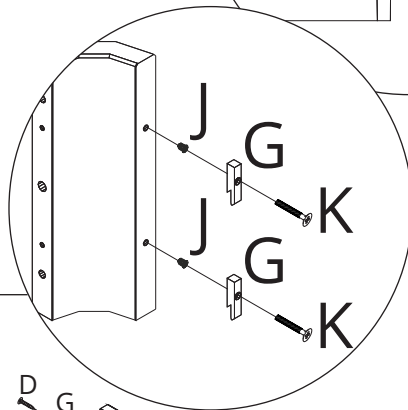
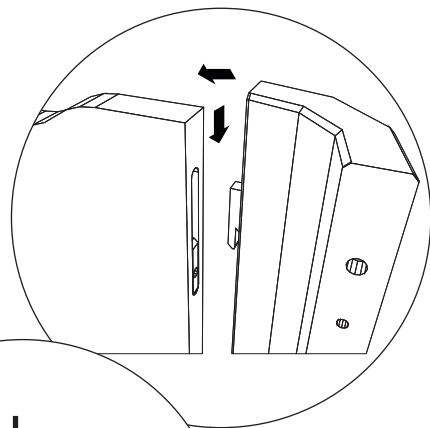
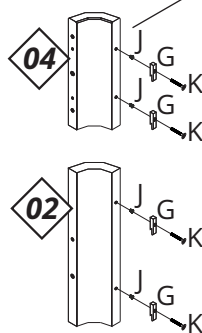

7

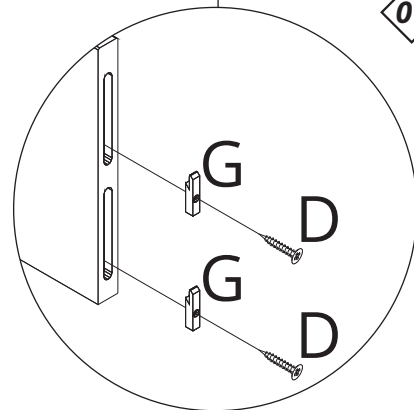
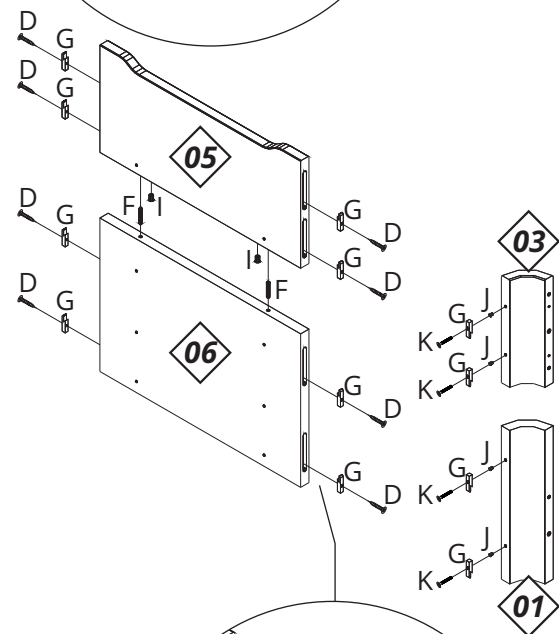
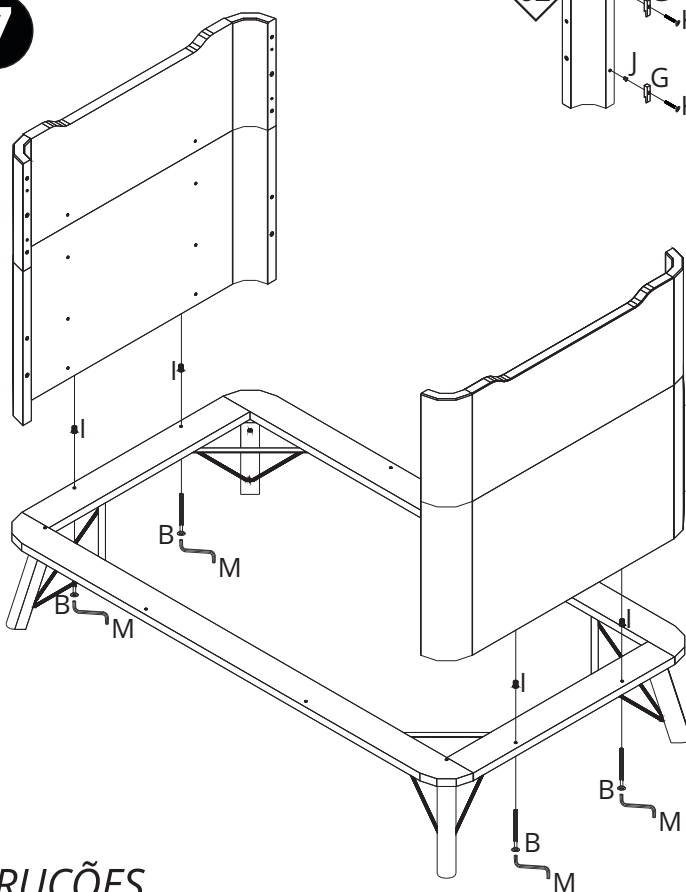

INSTRUÇÕES

INSTRUCCIONES

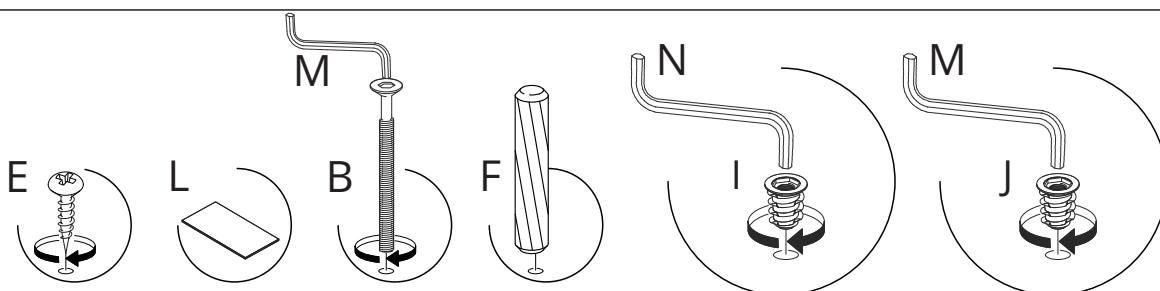

MONTAGEM

MONTAJE

8

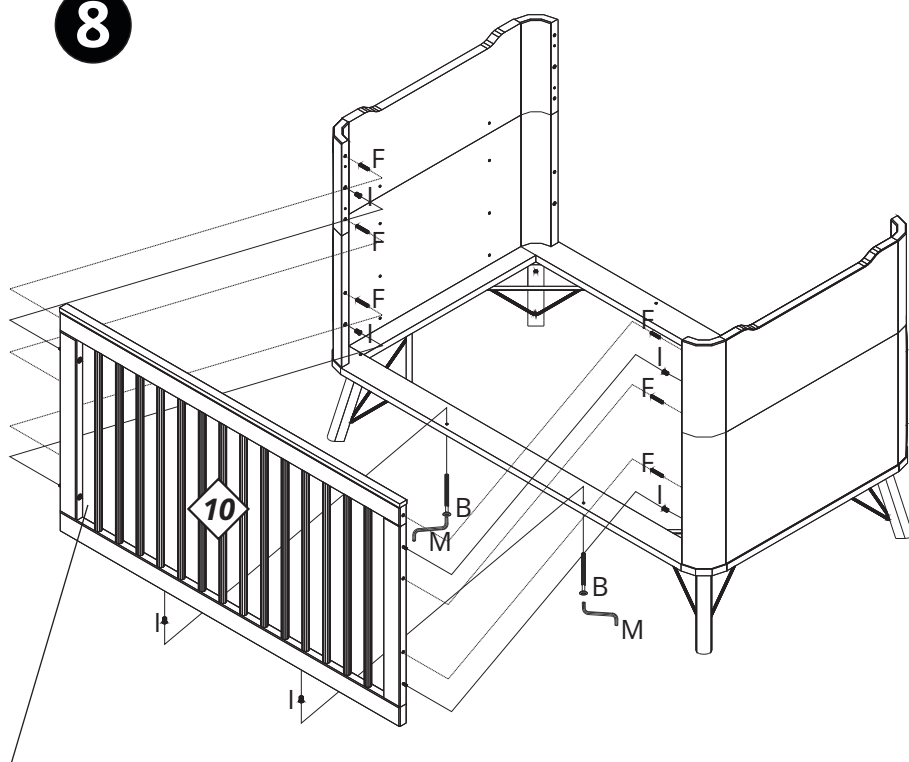

Parafusos internos (1/4 x 70) já posicionados.
Utilizar a Chave Allen Ø4mm (M) para fixá-los.

9

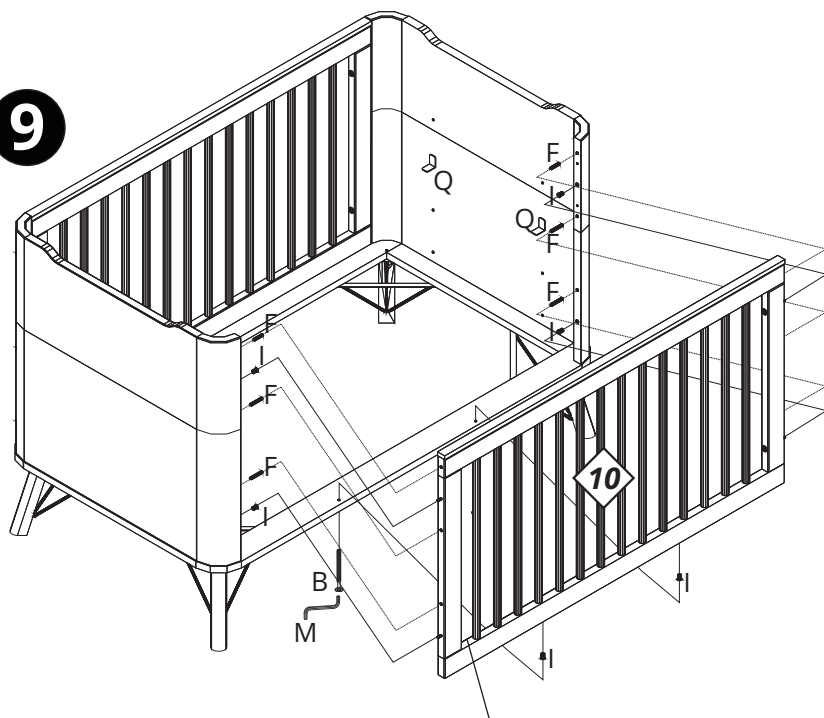

Parafusos internos (1/4 x 70) já posicionados.
Utilizar a Chave Allen Ø4mm (M) para fixá-los.

INSTRUÇÕES

INSTRUCCIONES

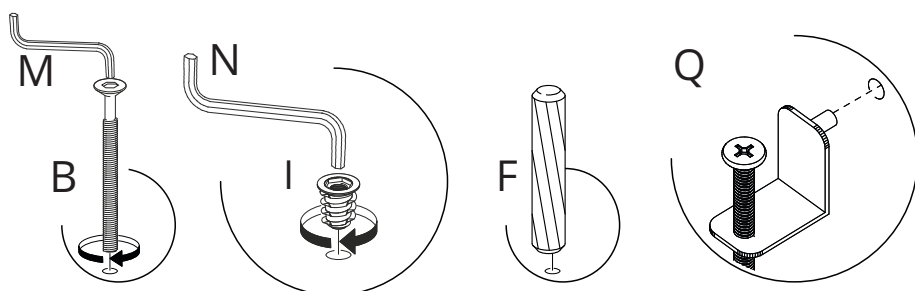

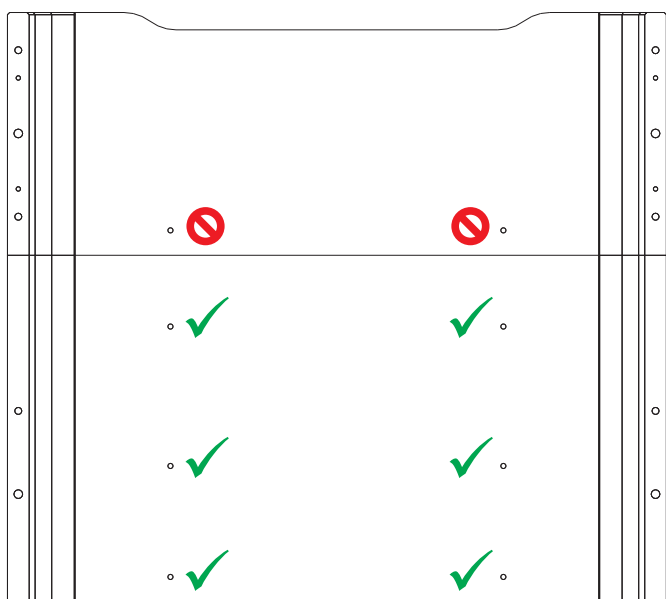

- NÃO UTILIZAR A FURAÇÃO SUPERIOR (PAINEL 05) PARA A MONTAGEM DO ESTRADO, FURAÇÃO EXCLUSIVA PARA A MONTAGEM DA MINI CAMA.

- UTILIZE AS 3 REGULAGENS DISPONÍVEIS NO PAINEL INFERIOR (06).

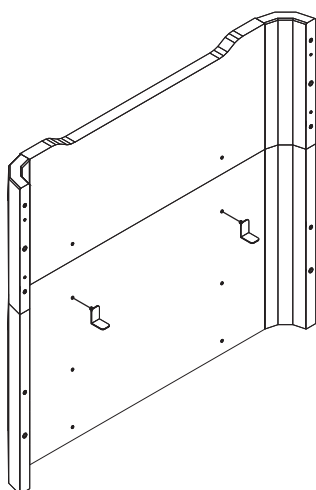
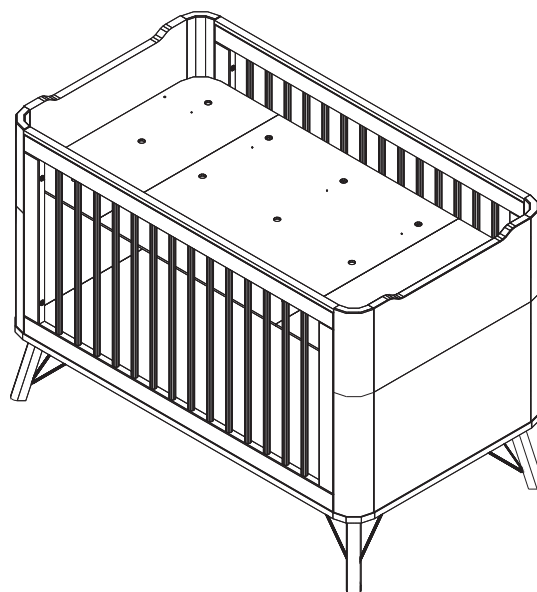
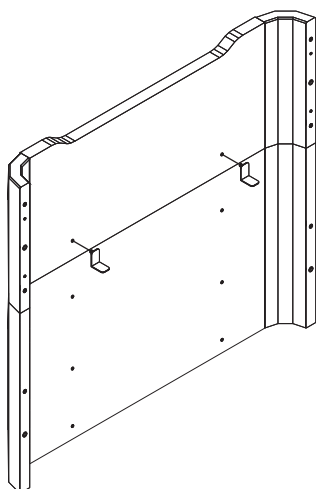

MONTAGEM

MONTAJE

10

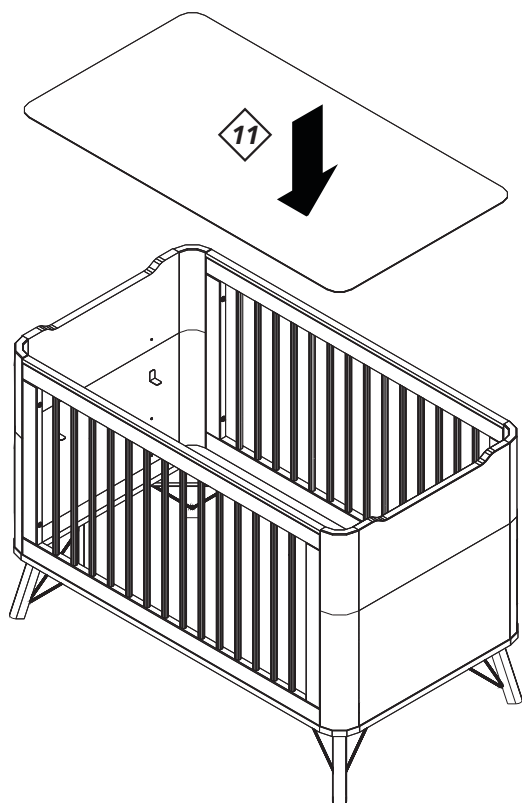

11

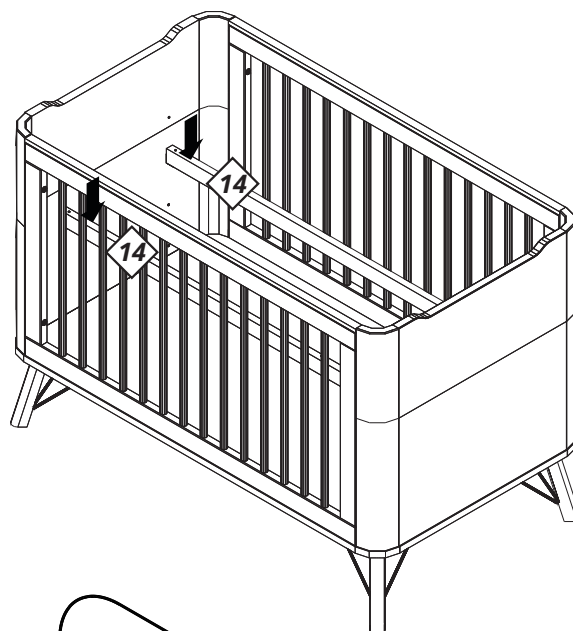

12

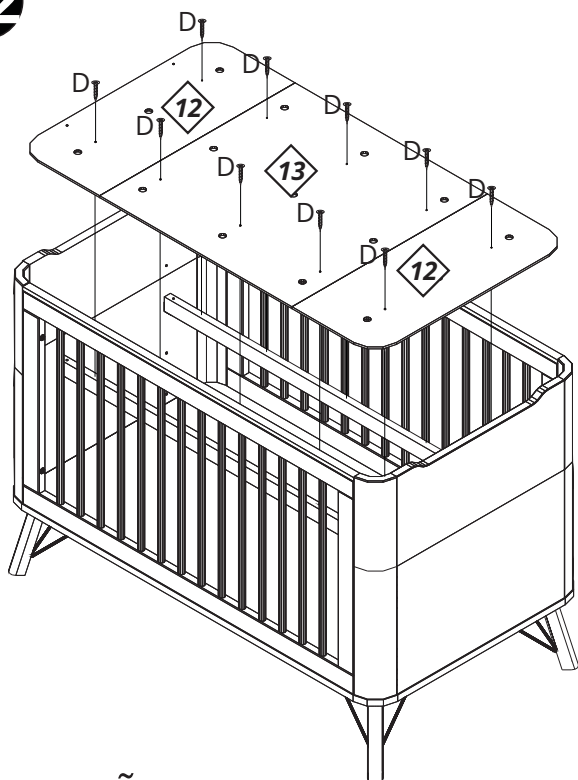

13

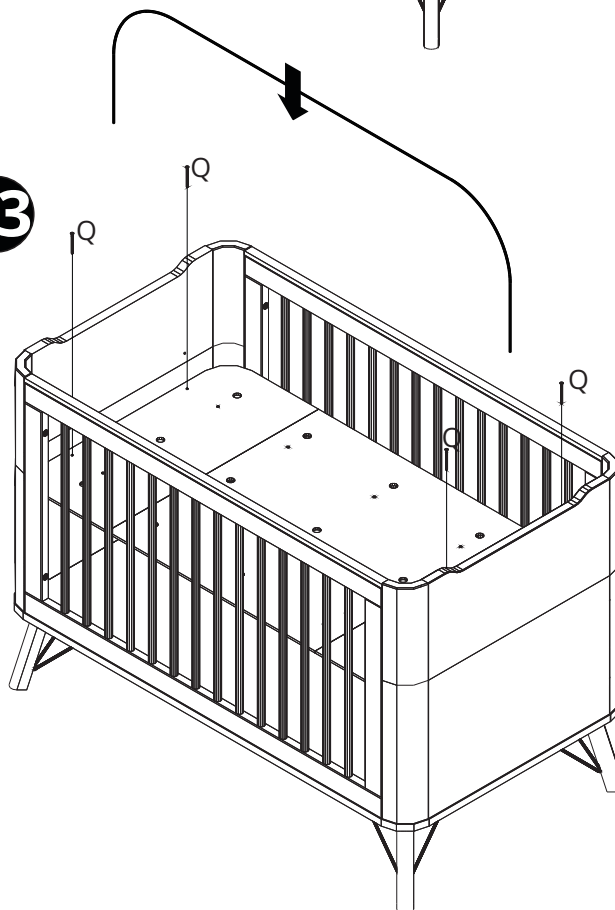

INSTRUÇÕES

INSTRUCCIONES

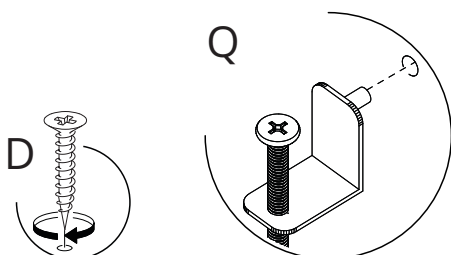

TRANSFORMANDO EM MINI BERÇO

- 1** DESMONTE OS PAINÉIS (06/05), AS GRADES (10) E REMOVA O ESTRADO
REUTILIZAR 04 CAVILHAS (F), QUE SERÃO UTILIZADAS
NO PASSO 06.

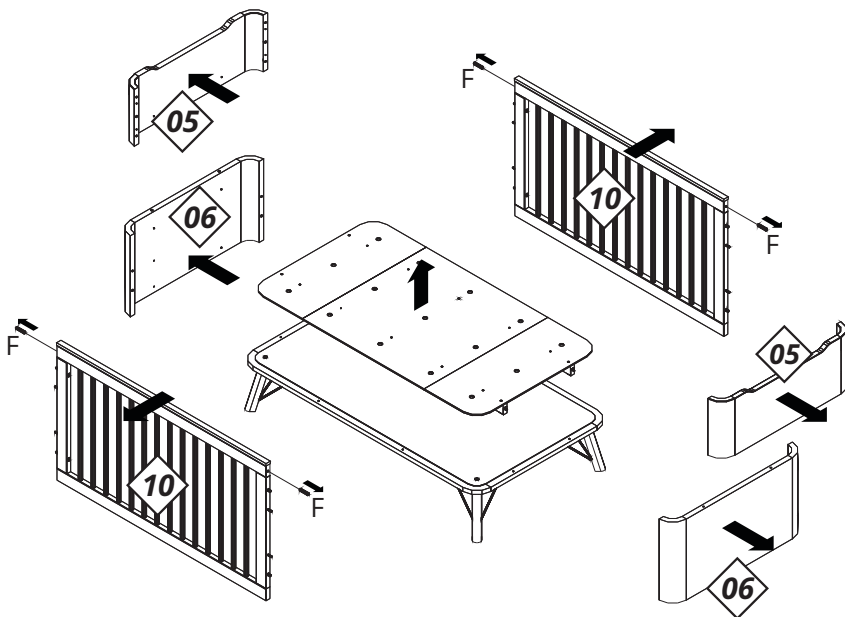

- 2** DESMONTE OS ARAMADOS (P) E AS CHAPINHAS (O)

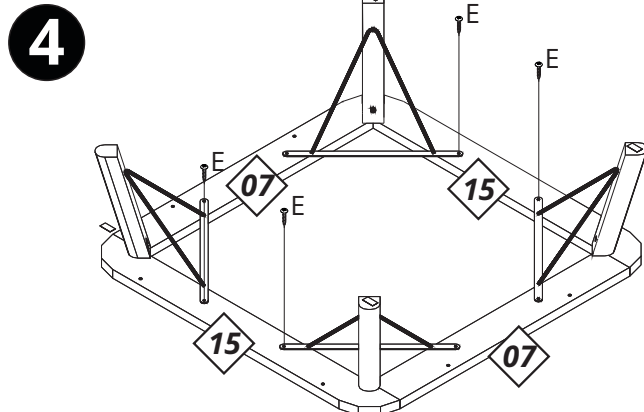
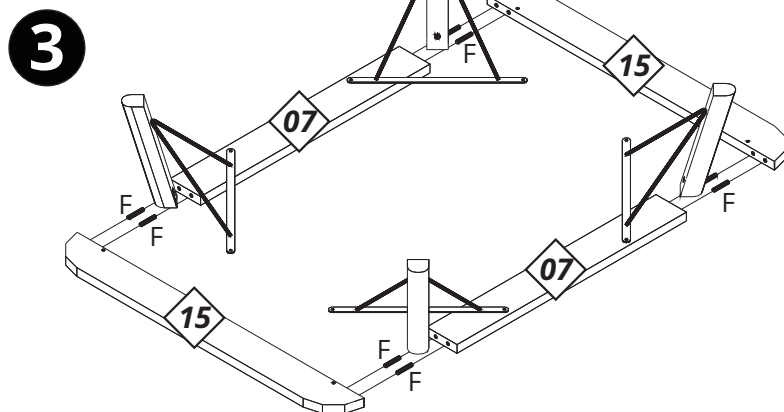
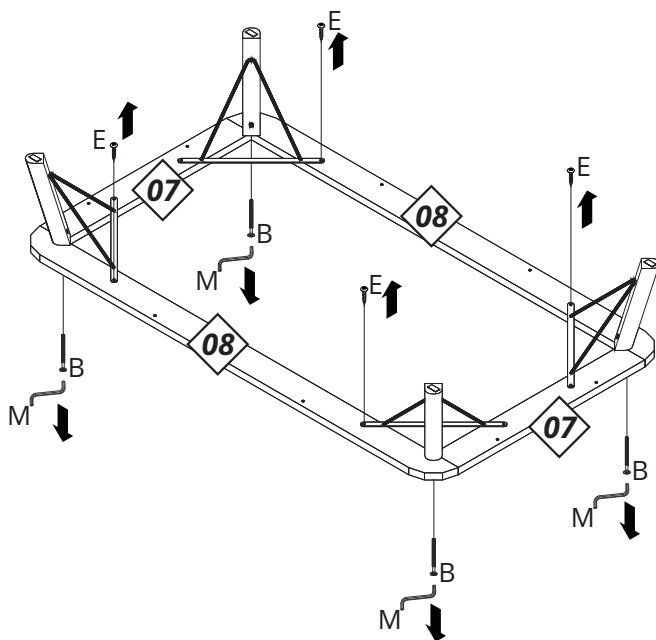

**ESTE PRODUTO ATENDE À
REGULAMENTAÇÃO PARA BERÇOS
INFANTIS, NÃO SENDO AS SUAS
DEMAIS FUNÇÕES SUJEITAS À
REGULAMENTAÇÃO.**

INSTRUÇÕES
INSTRUCCIONES

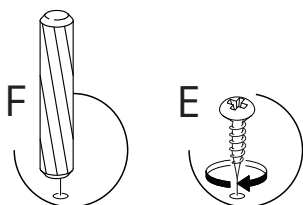

TRANSFORMANDO EM MINI BERÇO

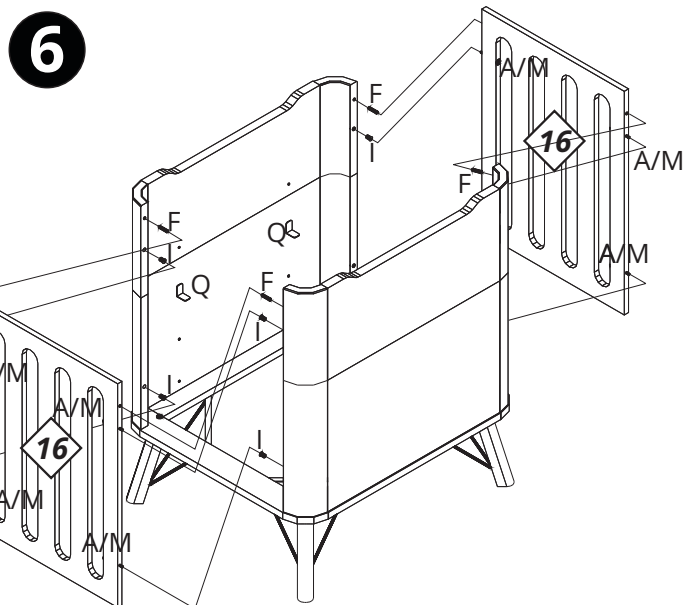
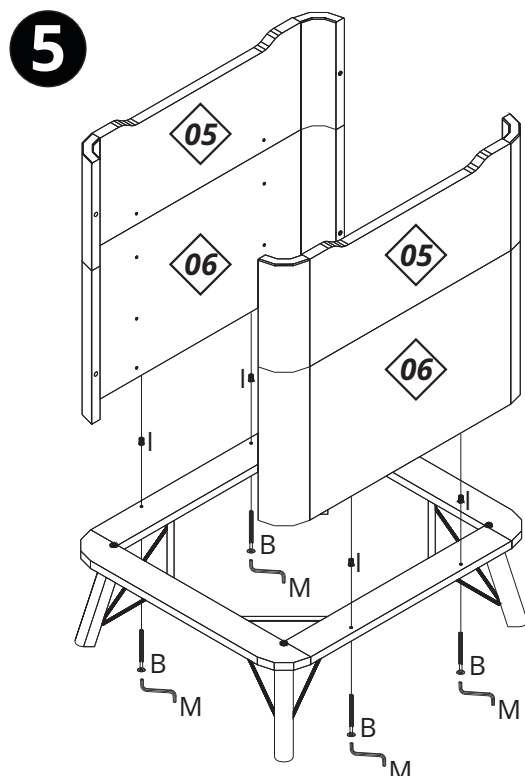

7 DESMONTE O ESTRADO (12/13/14)

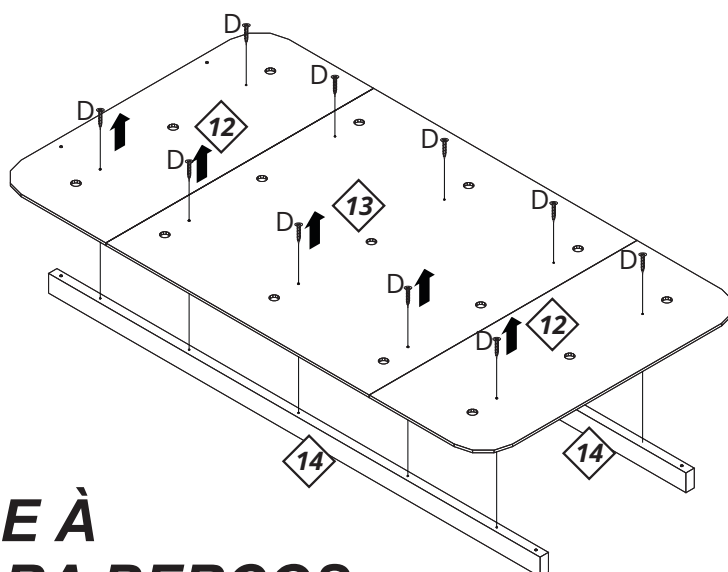

**ESTE PRODUTO ATENDE À
REGULAMENTAÇÃO PARA BERÇOS
INFANTIS, NÃO SENDO AS SUAS
DEMAIS FUNÇÕES SUJEITAS À
REGULAMENTAÇÃO.**

INSTRUÇÕES

INSTRUCCIONES

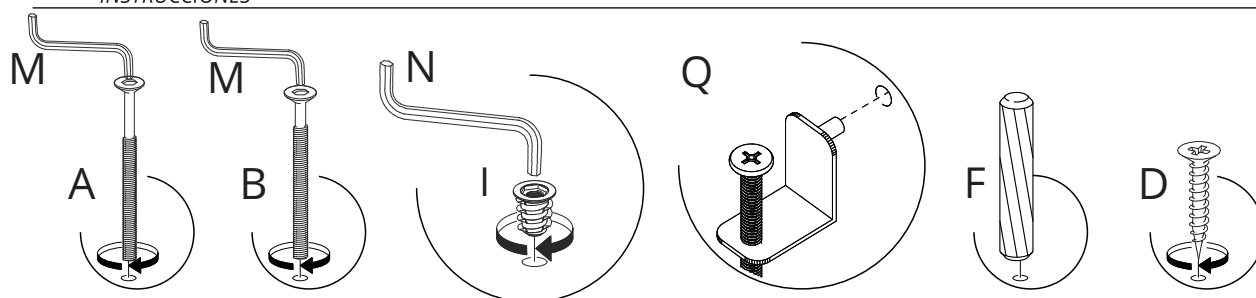

TRANSFORMANDO EM MINI BERÇO

8

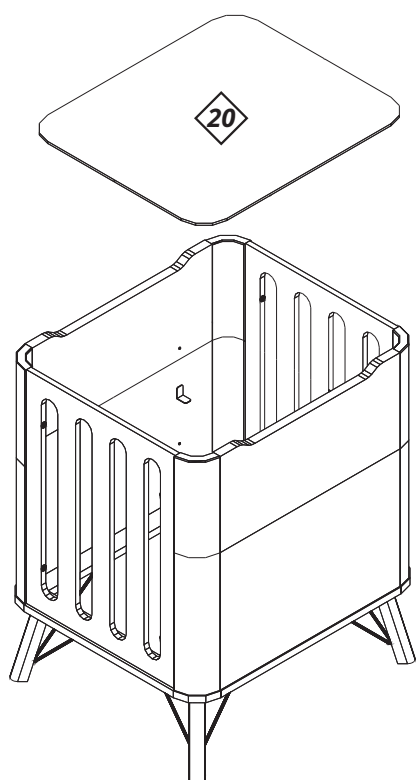

9

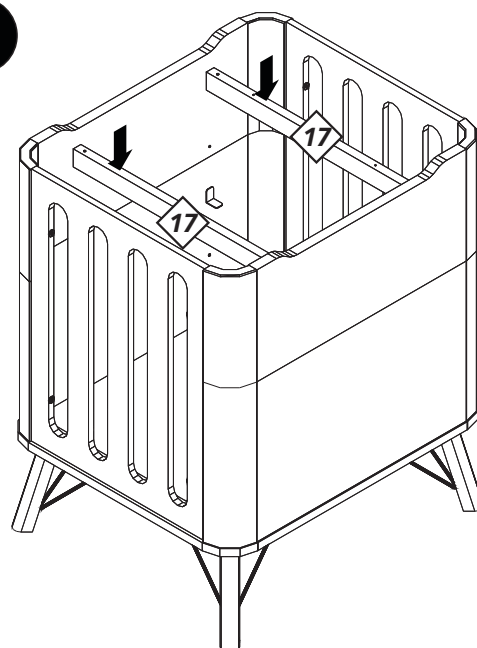

10

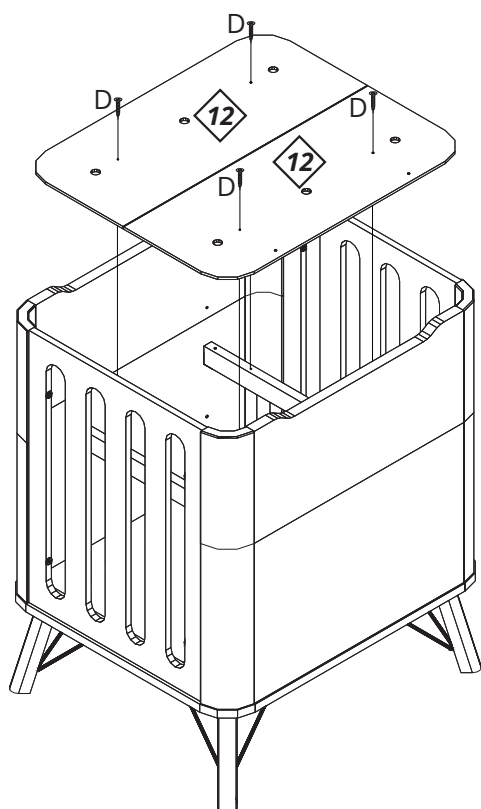

11

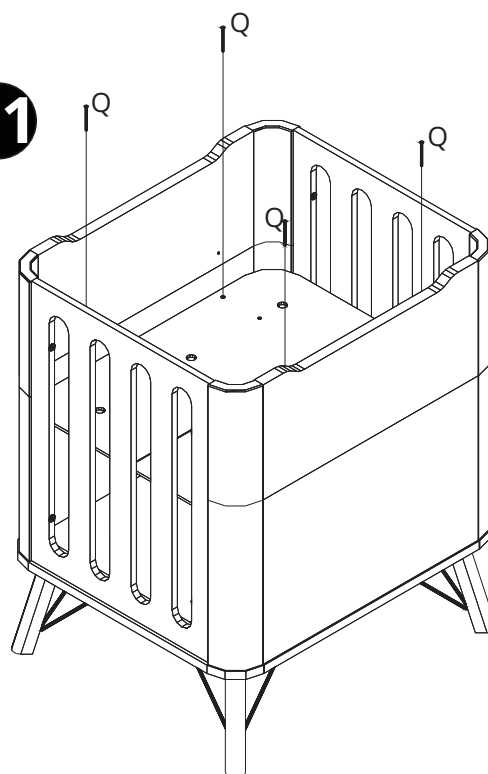

INSTRUÇÕES
INSTRUCCIONES

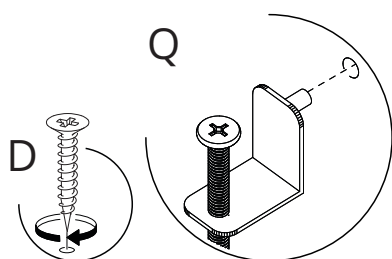

**ESTE PRODUTO ATENDE À
REGULAMENTAÇÃO PARA BERÇOS
INFANTIS, NÃO SENDO AS SUAS
DEMAIS FUNÇÕES SUJEITAS À
REGULAMENTAÇÃO.**

TRANSFORMANDO EM MINI CAMA

- 1** DESMONTE OS PAINÉIS (06/05), AS GRADES (10) E REMOVA O ESTRADO

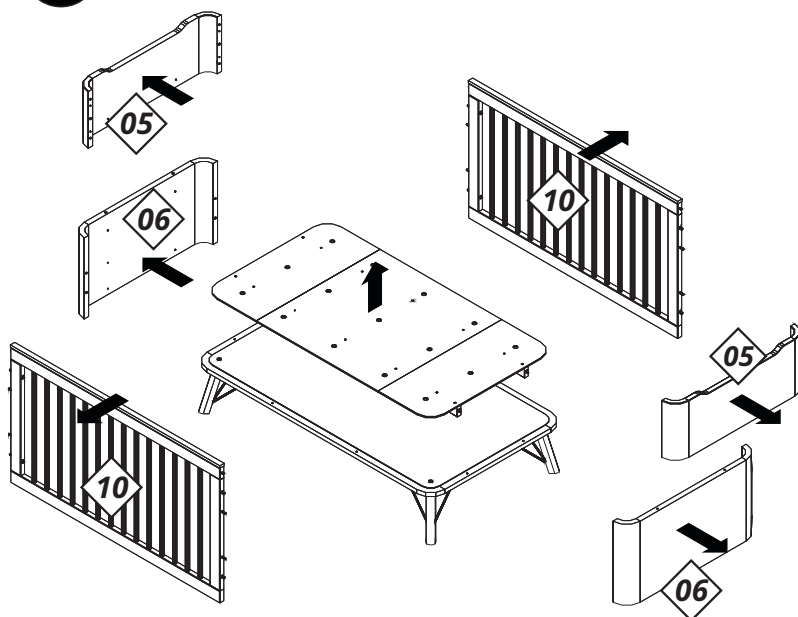

2

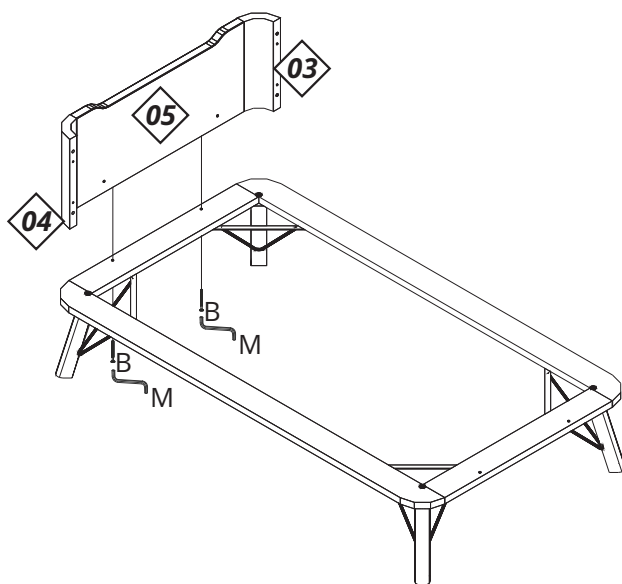

3

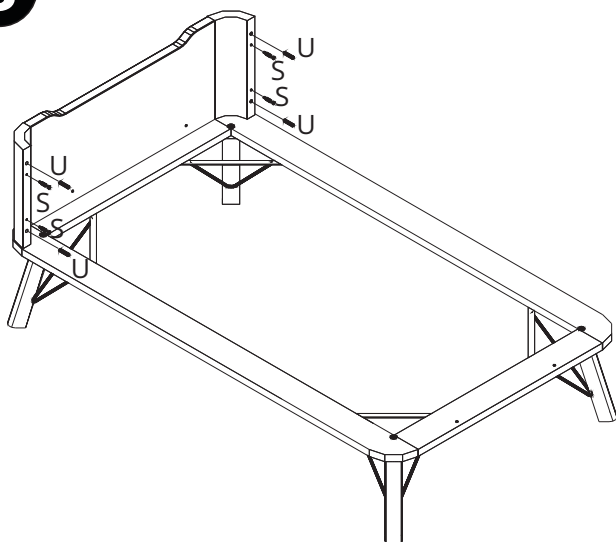

4

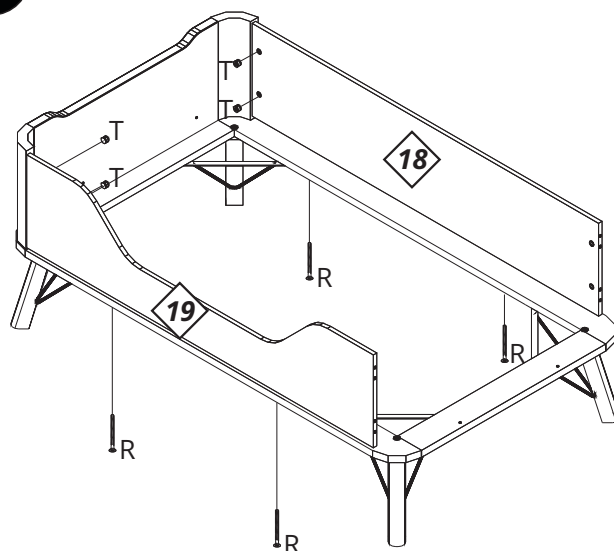

**ESTE PRODUTO ATENDE À
REGULAMENTAÇÃO PARA BERÇOS
INFANTIS, NÃO SENDO AS SUAS
DEMAIS FUNÇÕES SUJEITAS À
REGULAMENTAÇÃO.**

INSTRUÇÕES
INSTRUCCIONES

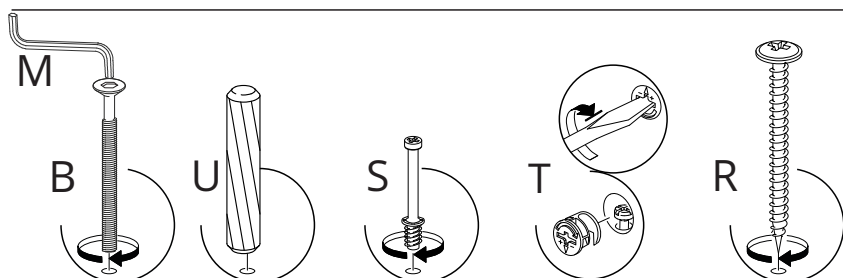

TRANSFORMANDO EM MINI CAMA

5

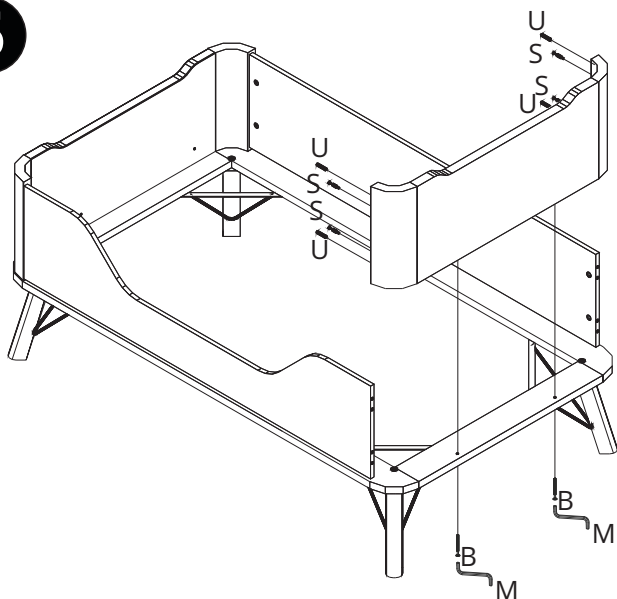

6

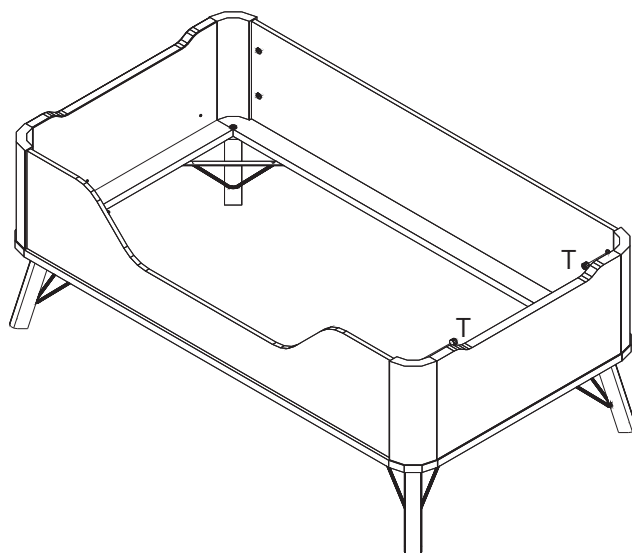

7

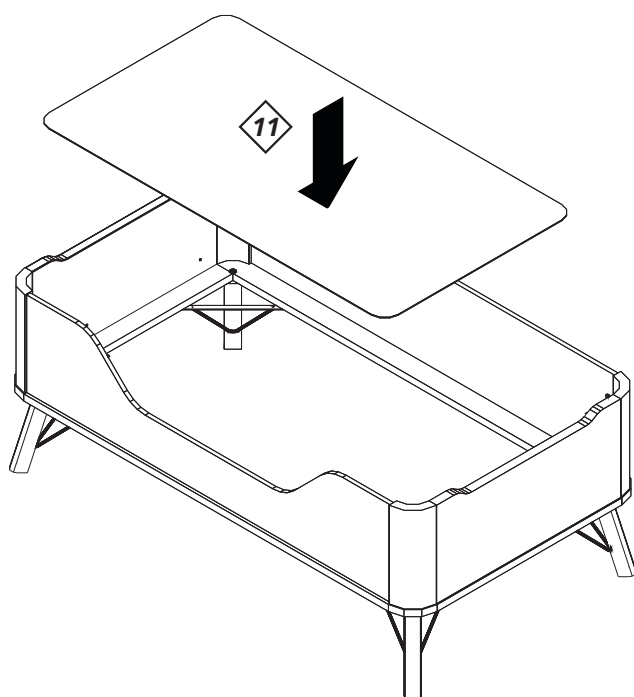

**ESTE PRODUTO ATENDE À
REGULAMENTAÇÃO PARA BERÇOS
INFANTIS, NÃO SENDO AS SUAS
DEMAIS FUNÇÕES SUJEITAS À
REGULAMENTAÇÃO.**

INSTRUÇÕES
INSTRUCCIONES

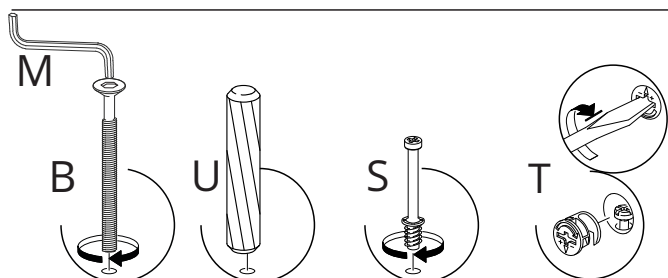

TRANSFORMANDO EM MINI CAMA

8

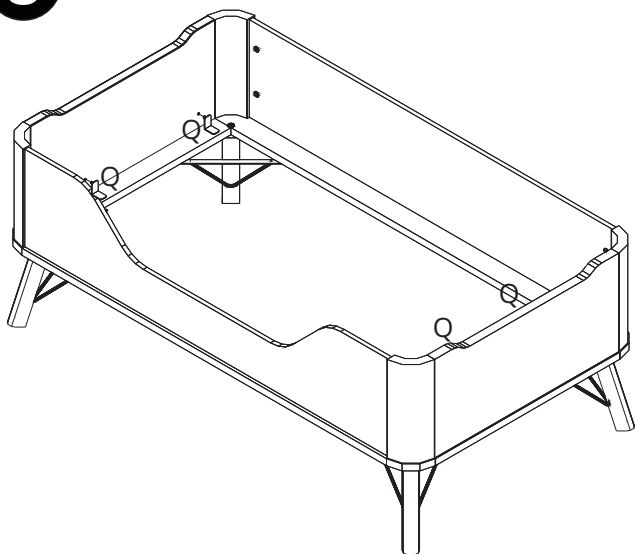

9

REPOSICIONAR O ESTRADO (12/13/14)

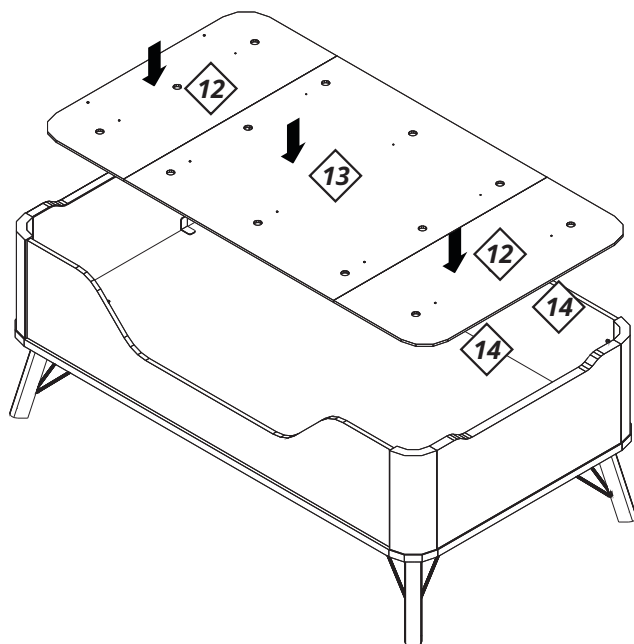

10



**ESTE PRODUTO ATENDE À
REGULAMENTAÇÃO PARA BERÇOS
INFANTIS, NÃO SENDO AS SUAS
DEMAIS FUNÇÕES SUJEITAS À
REGULAMENTAÇÃO.**

INSTRUÇÕES
INSTRUCCIONES

Q

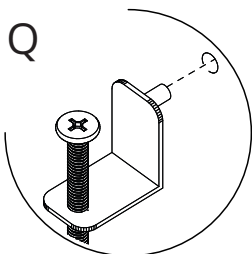

DESMONTANDO PARA LOCOMOÇÃO

