

MANUAL DE INSTRUCCIONES

**COMODA 6CJ NEW PROVENZAL
MODELO: MB3607TT24-2**

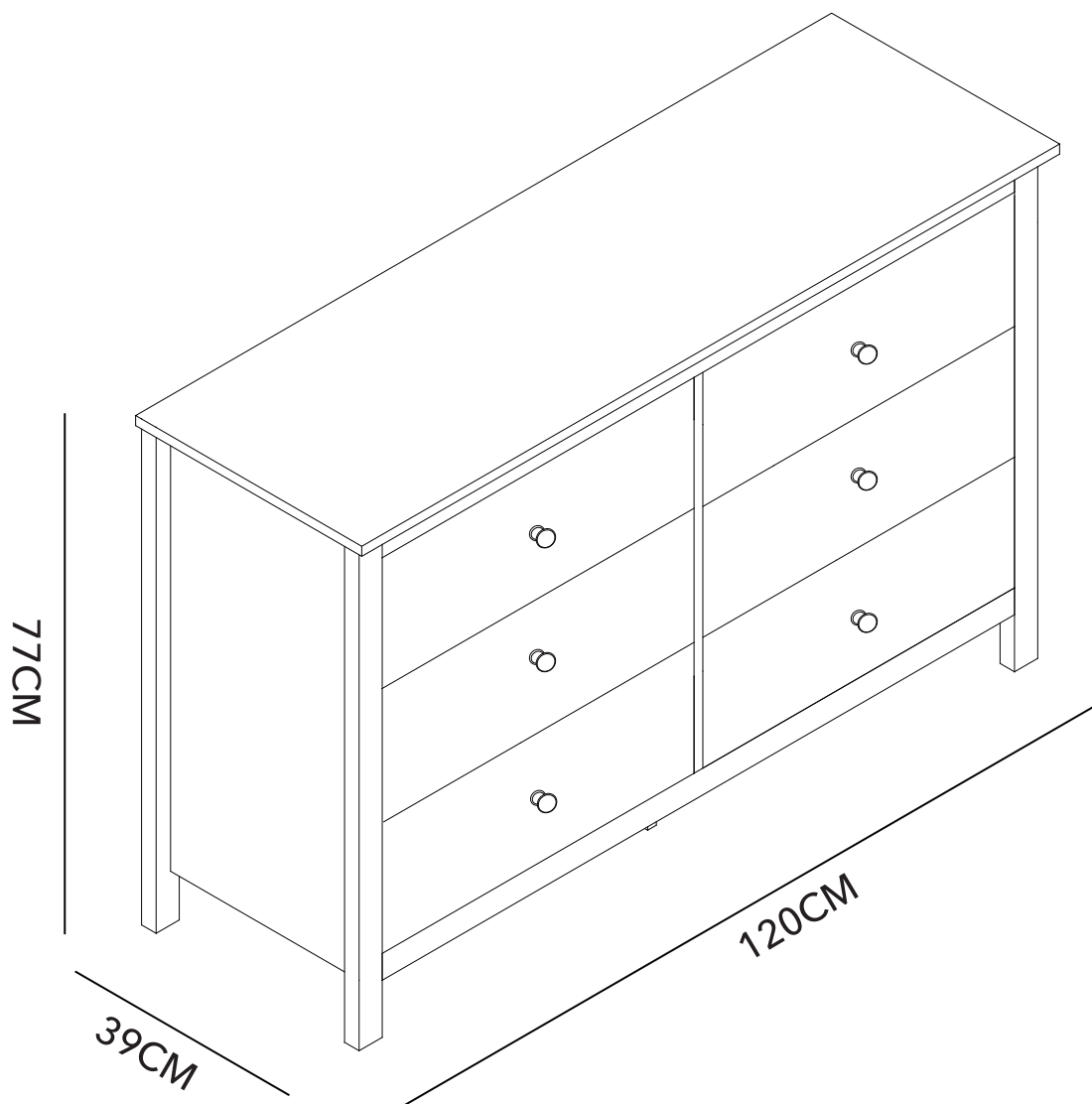

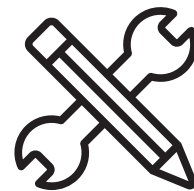

ADVERTENCIA

Siga las instrucciones que se detallan en el manual, si presenta alguna diferencia en el contenido de sus piezas pongase en contacto con la tienda donde fue adquirido.

RECOMENDACIONES

- Estudie atentamente las instrucciones antes del montaje.
- Ordene las piezas que componen el mueble.
- Agrupe y ordene la quincallería.
- Prepare una zona despejada para el montaje.
- Monte las piezas sin forzar los ensambles, una vez armada toda la estructura, reaprete de forma definitiva.
- Volver a apretar los tornillos después de un tiempo de uso.
- Conserve estas instrucciones de montaje.

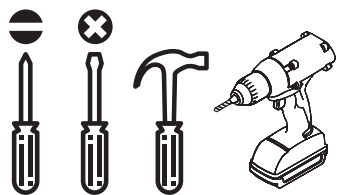

Herramientas requeridas
(no incluidas)



2 personas
para el armado



Producto contenido
en 1 caja

QUINCALLERÍA

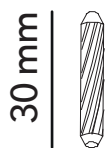

A x 18



B x 60

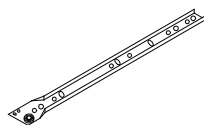

CL x 6

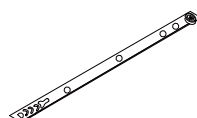

DL x 6

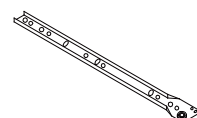

CR x 6

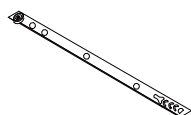

DR x 6

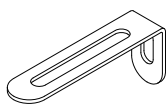

E x 2

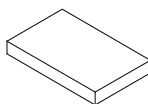

F x 4

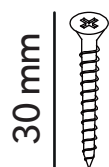

G x 24



H x 71

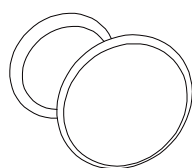

I x 6



J x 71

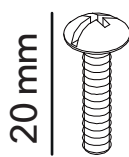

K x 6



L x 12

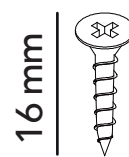

M x 12

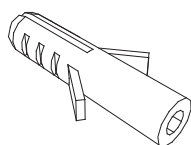

N x 2

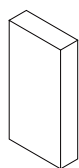

O x 2

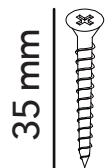

P x 10



Q x 2

PIEZAS

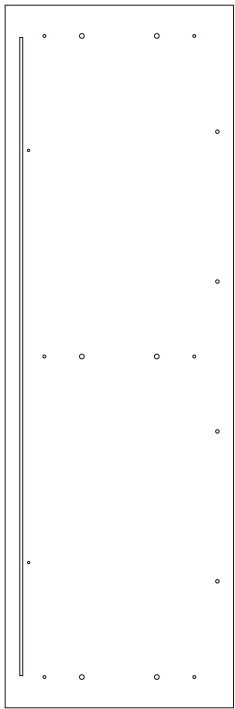

1 x1

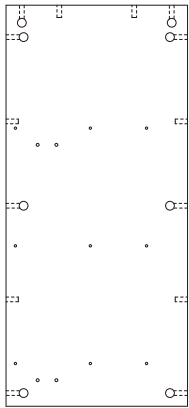

2 x1

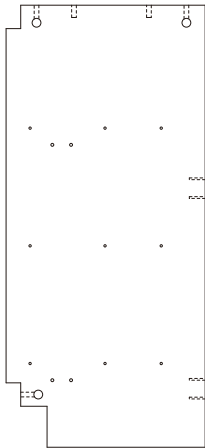

3 x1

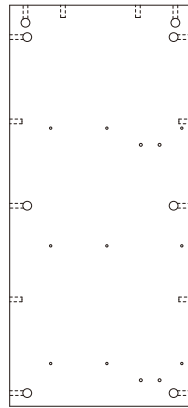

4 x1



5 x1



6 x1



7 x1



8 x4



9 x6



10 x6



11 x6

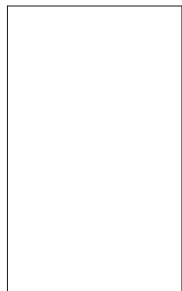

12 x6

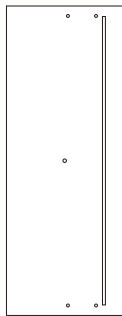

13 x6



14 x1



15 x1



16 x1



17 x1



18 x1



19 x1

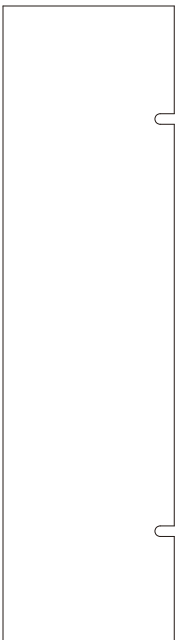

20 x1

PASO 1

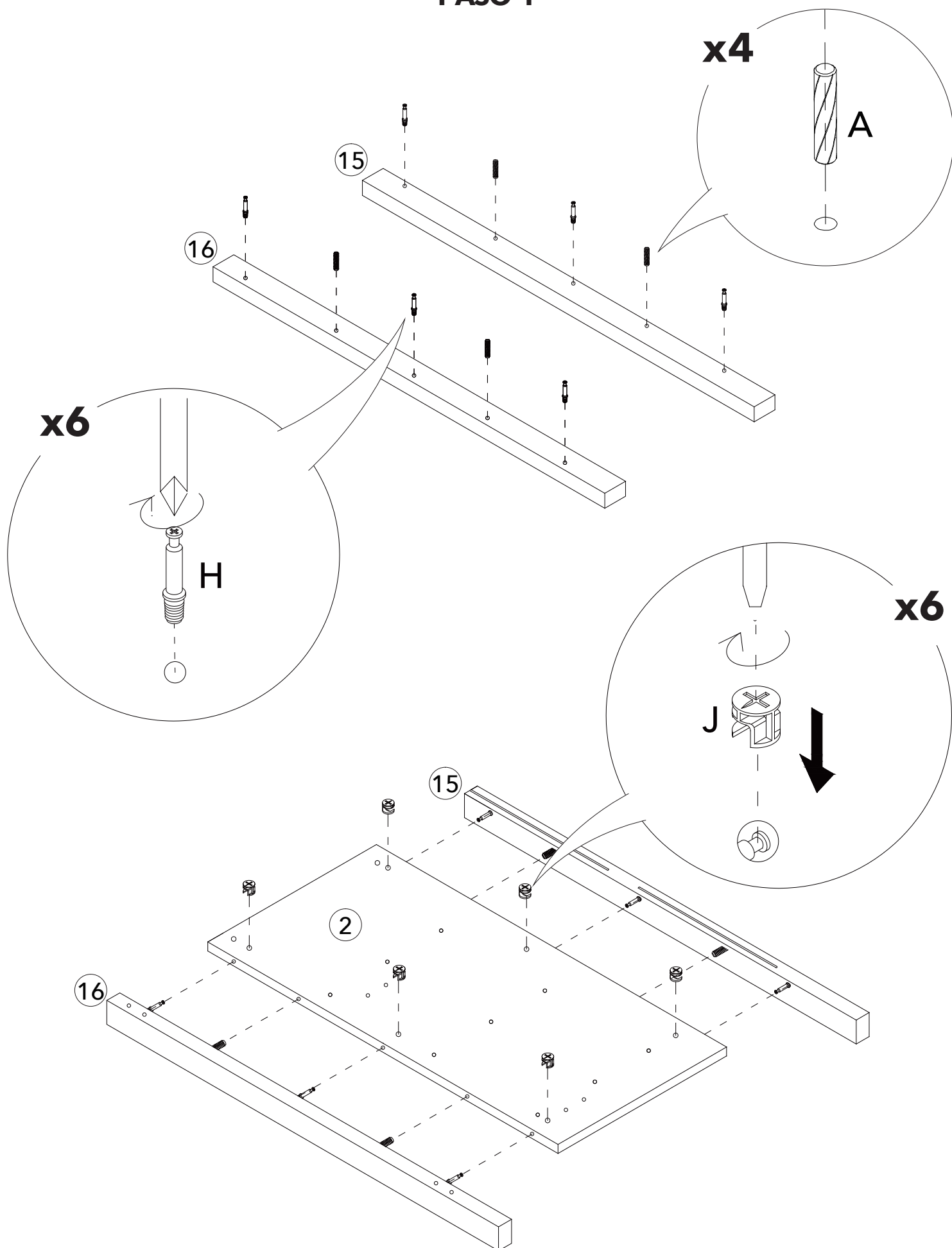

PASO 2

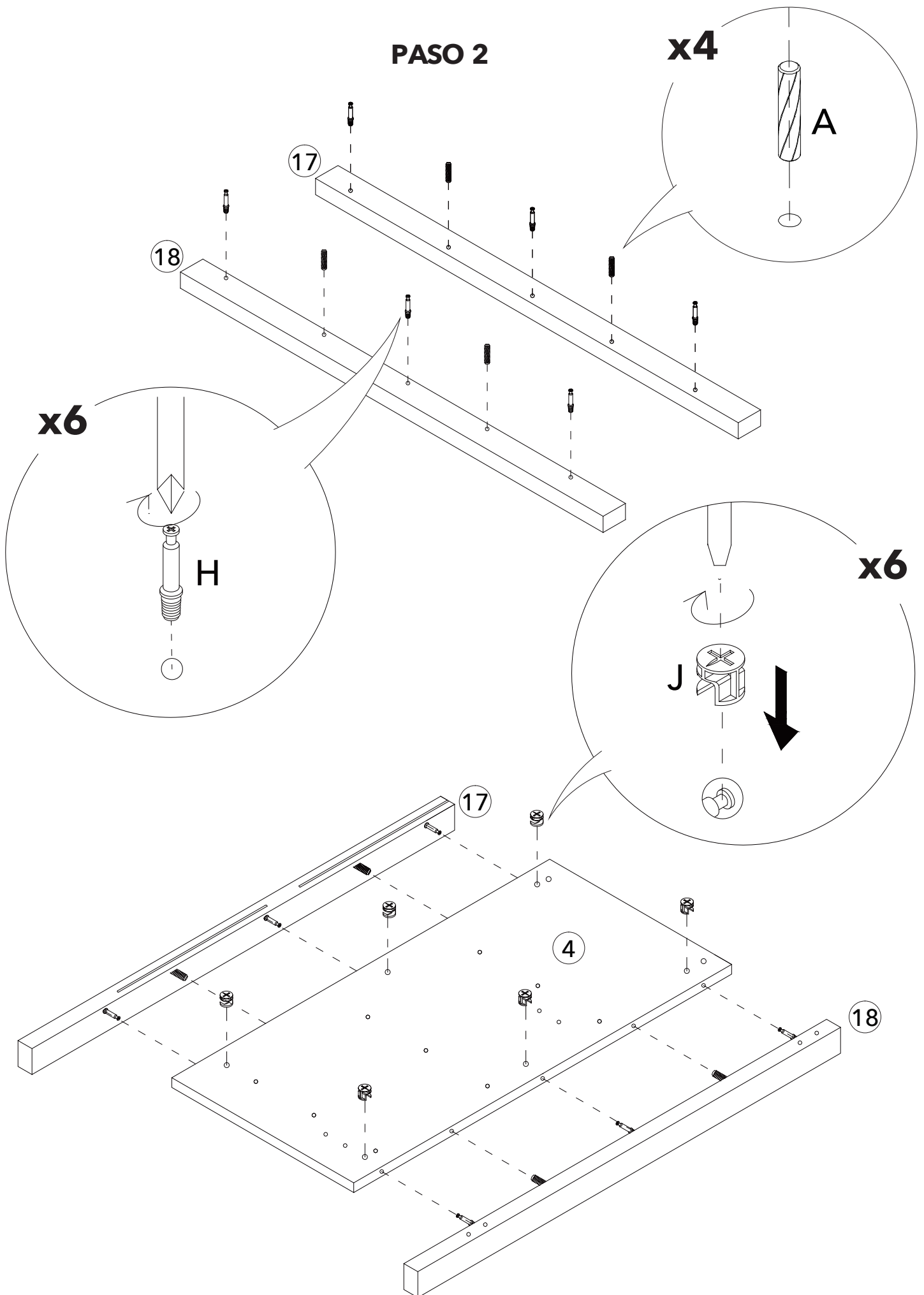

PASO 3

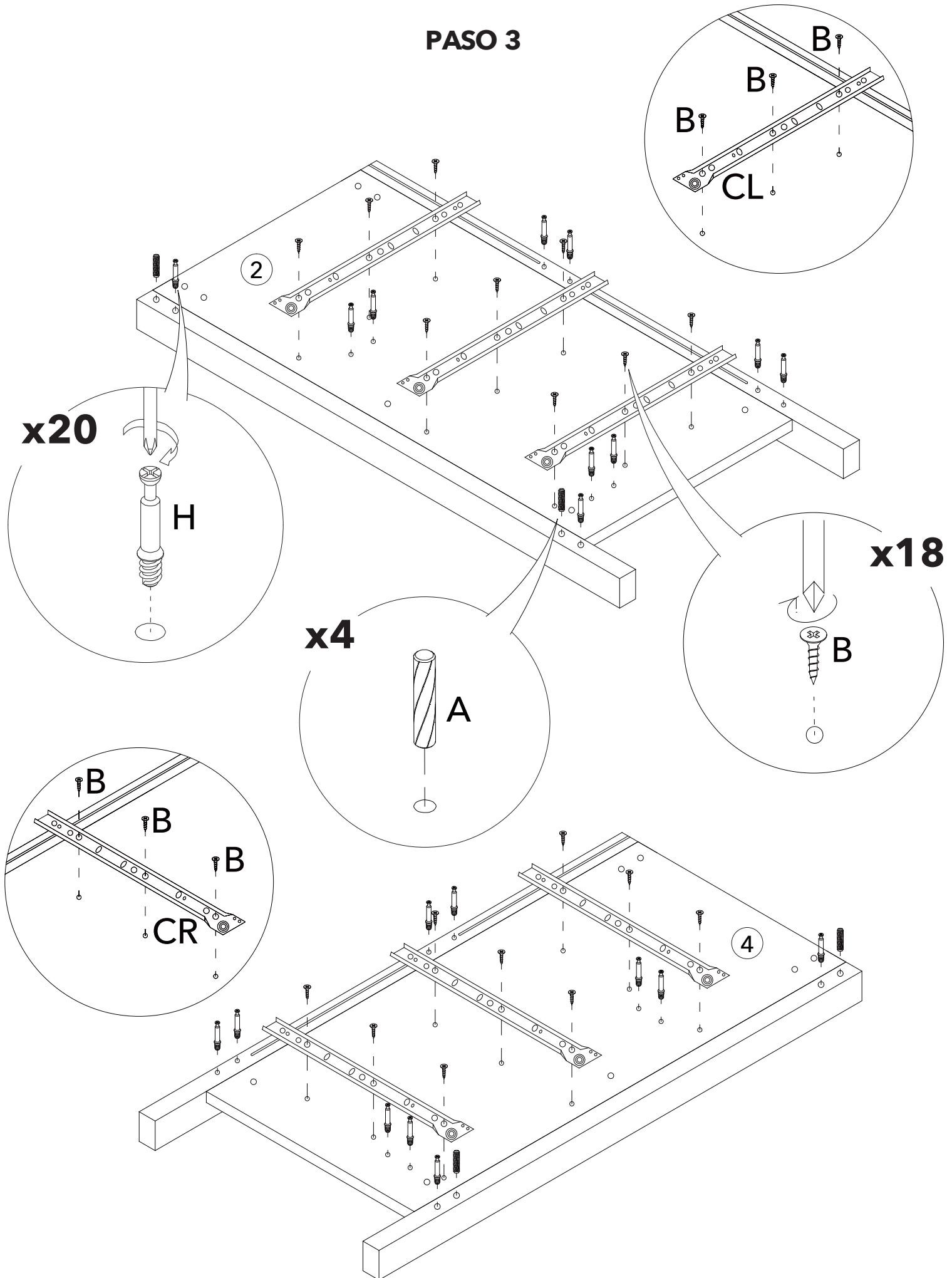

PASO 4

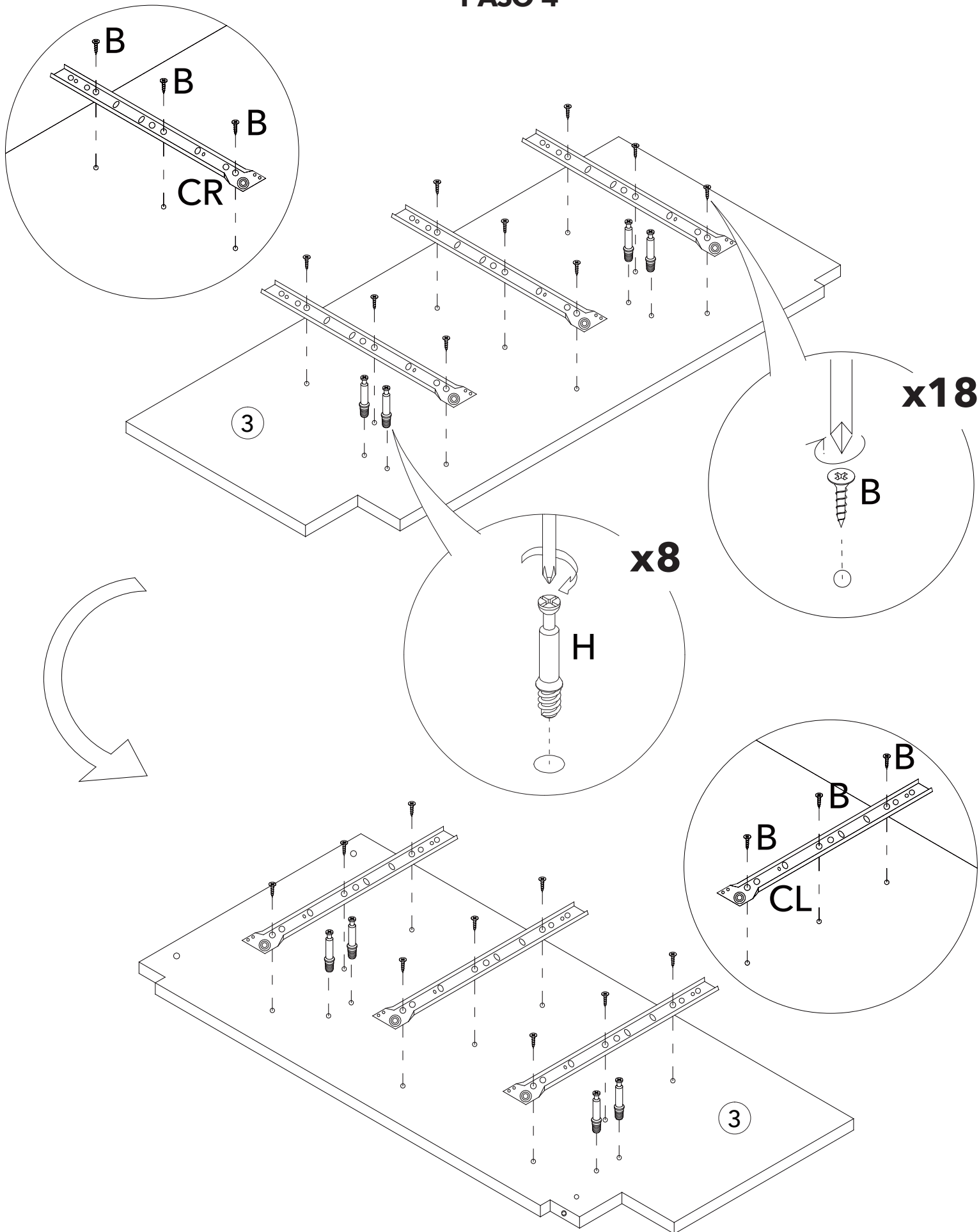

PASO 5

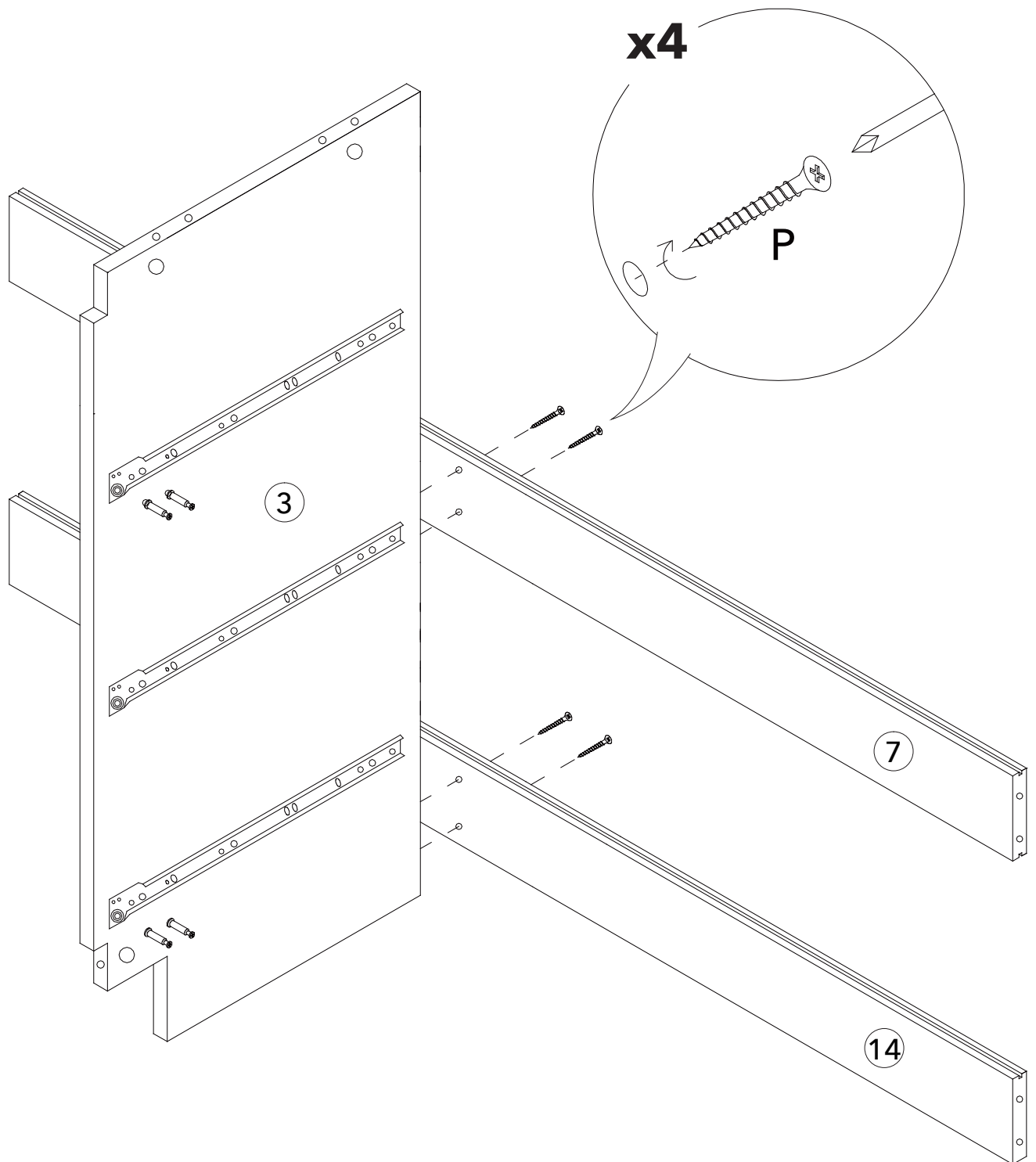

PASO 6

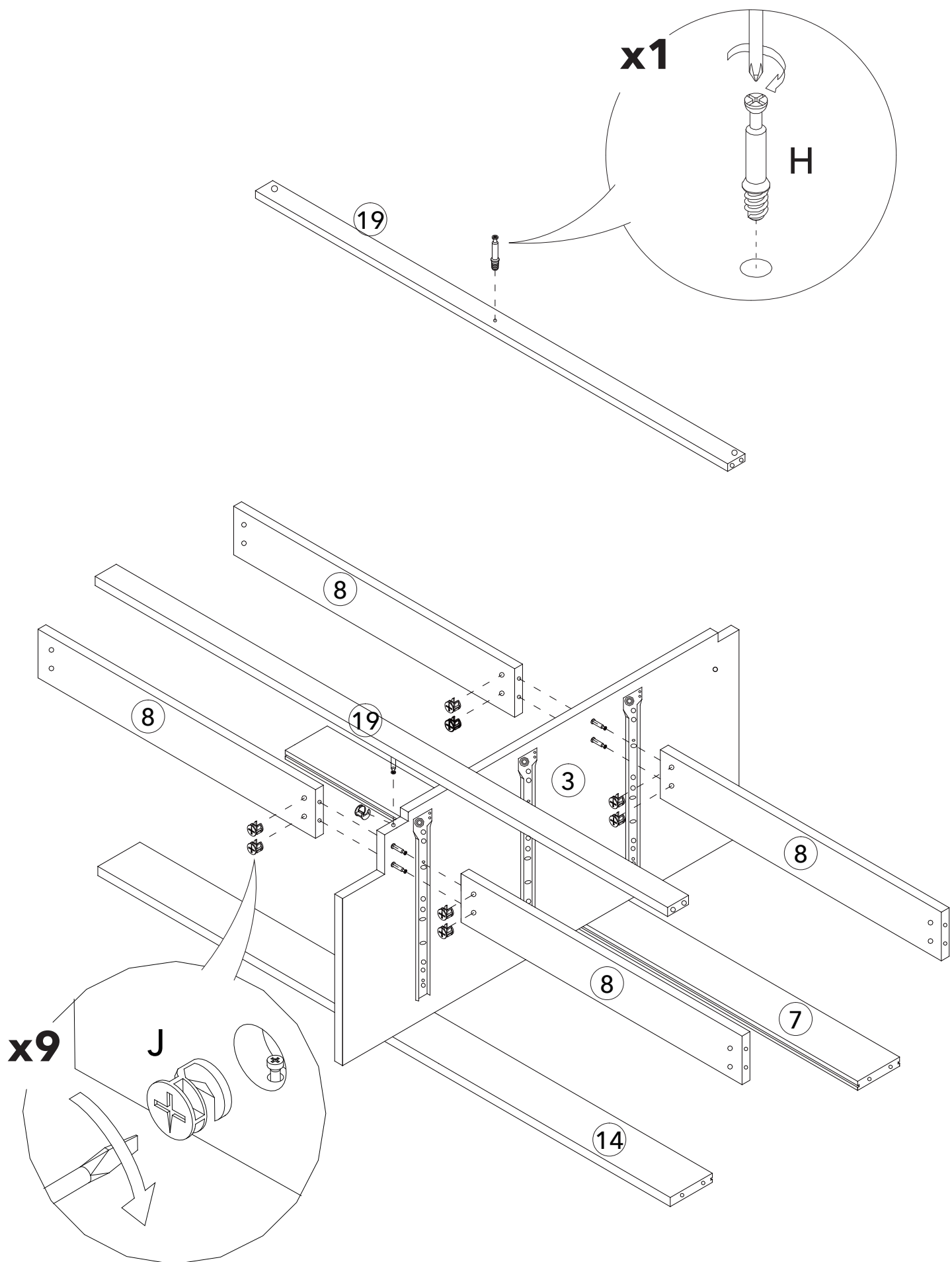

PASO 7

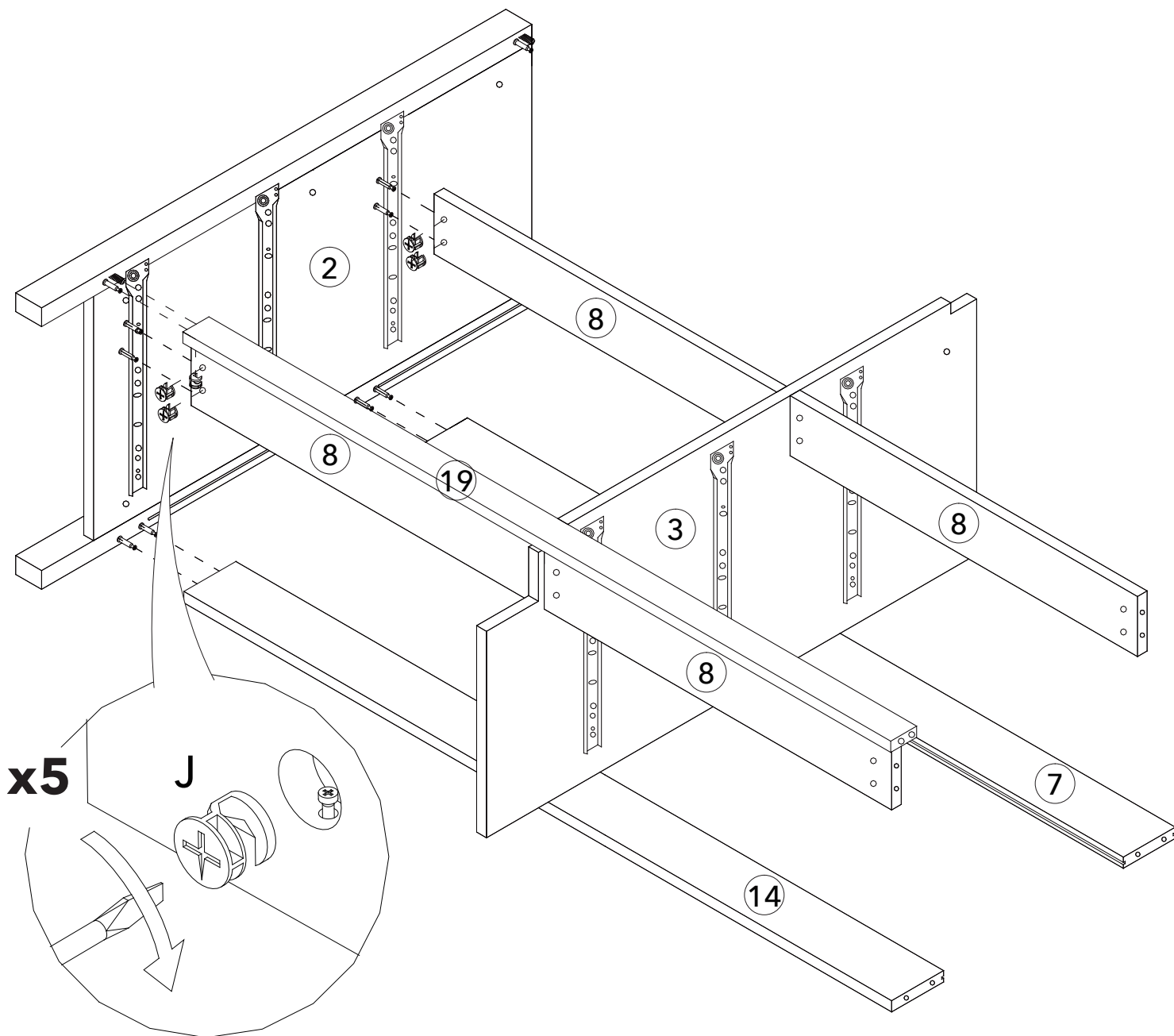

PASO 8

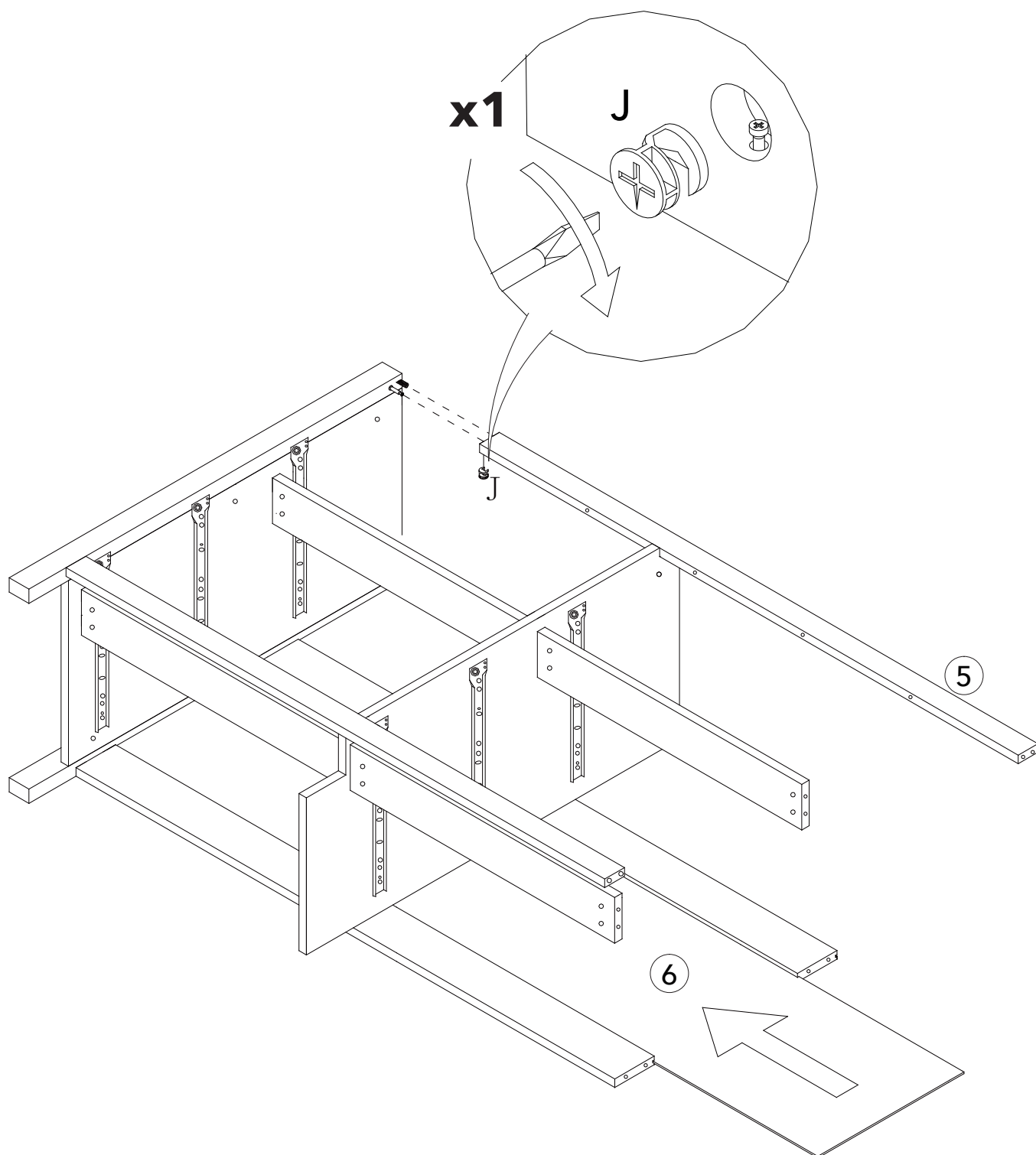

PASO 9

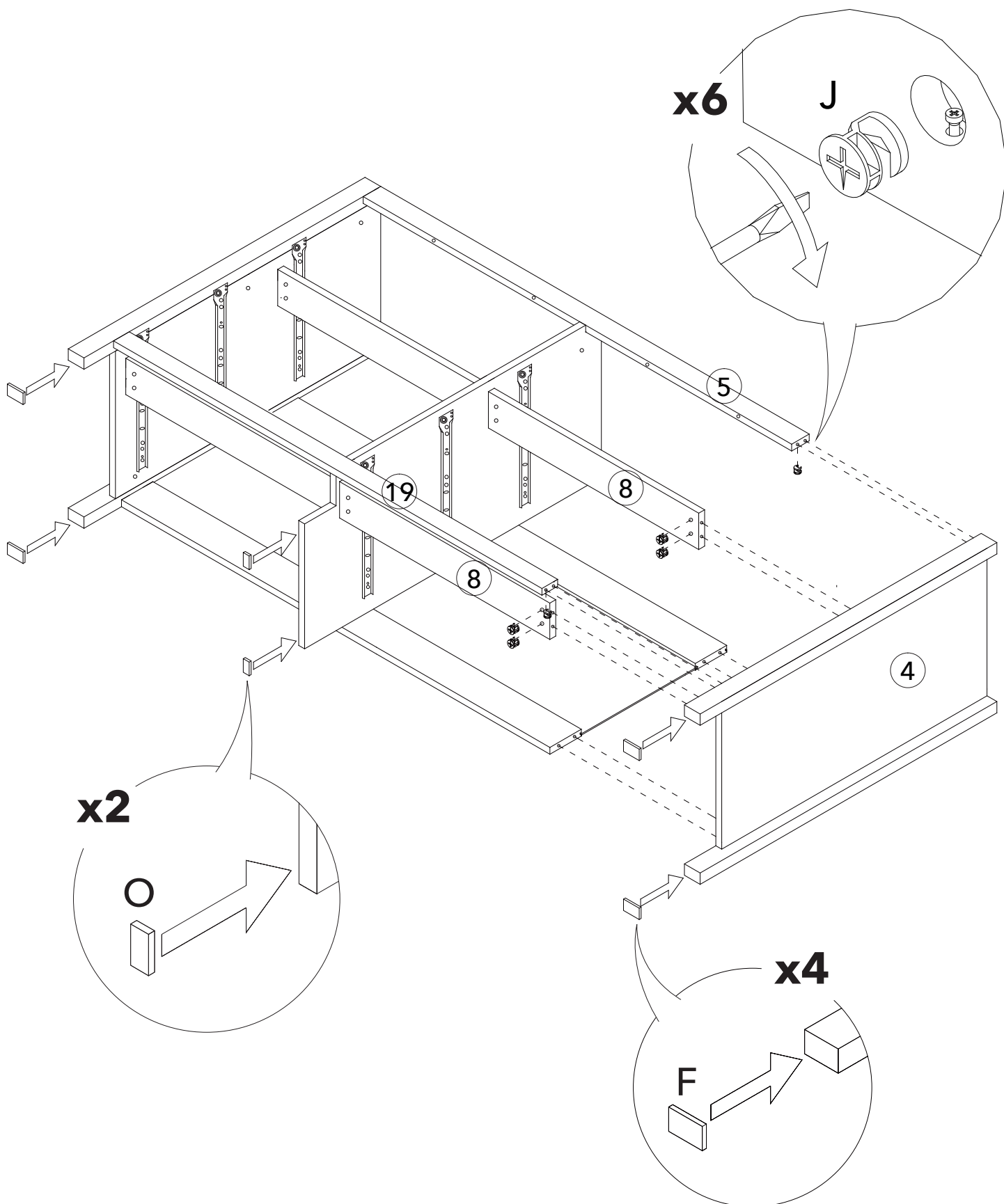

PASO 10

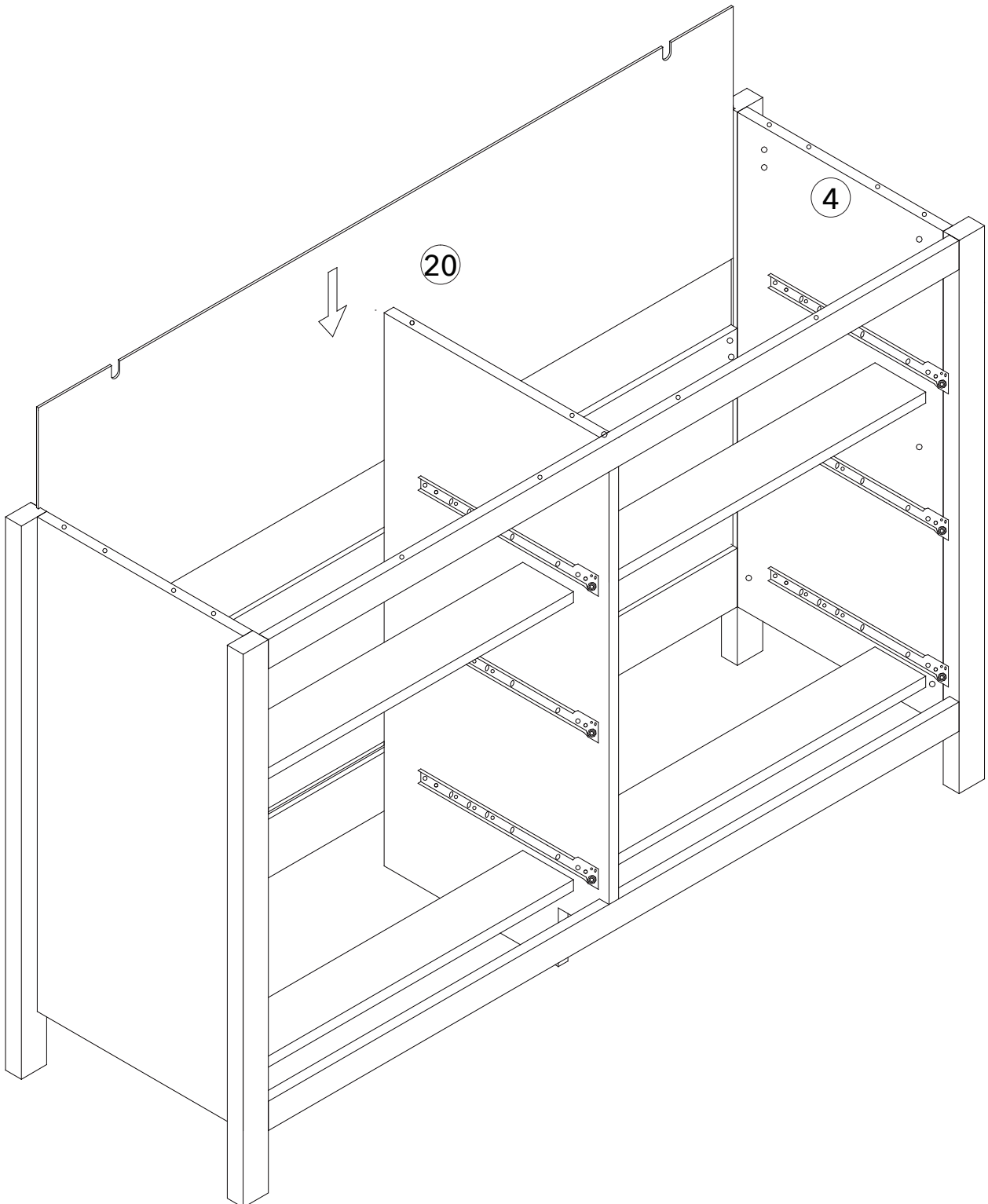

PASO 11

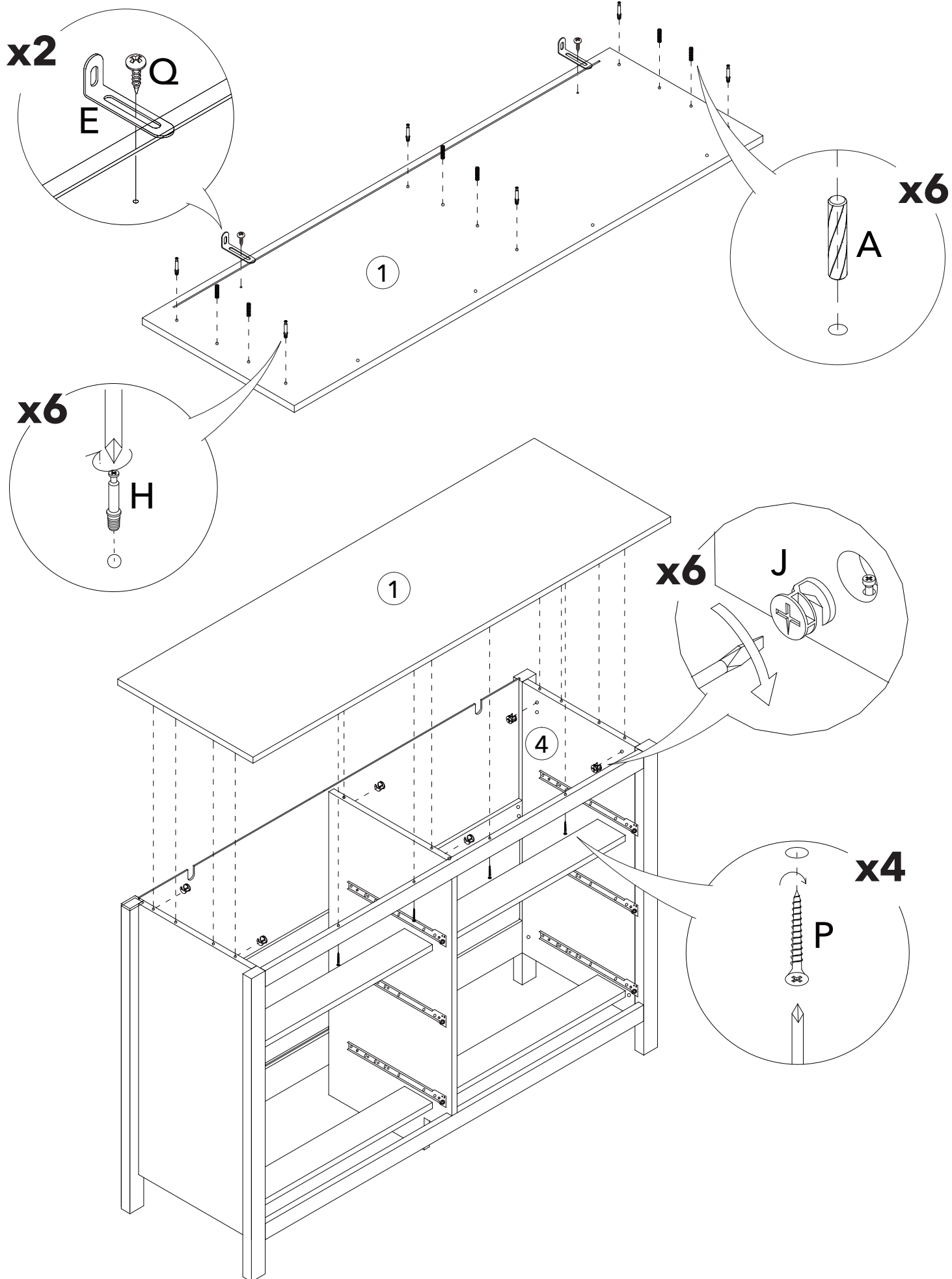

PASO 12

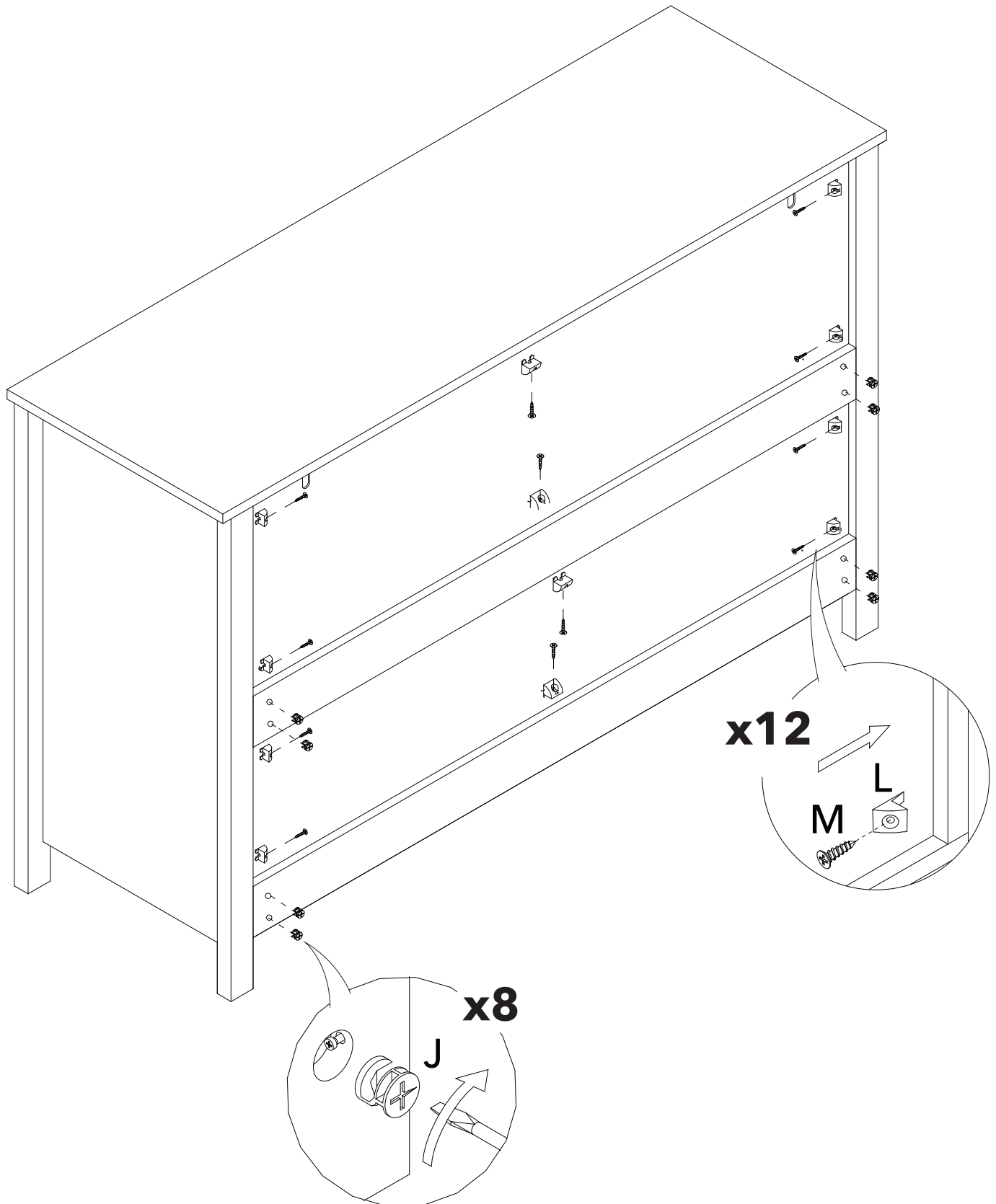

PASO 13
ARMADO DE CAJONES
HACER LO MISMO PARA LOS 6 CAJONES

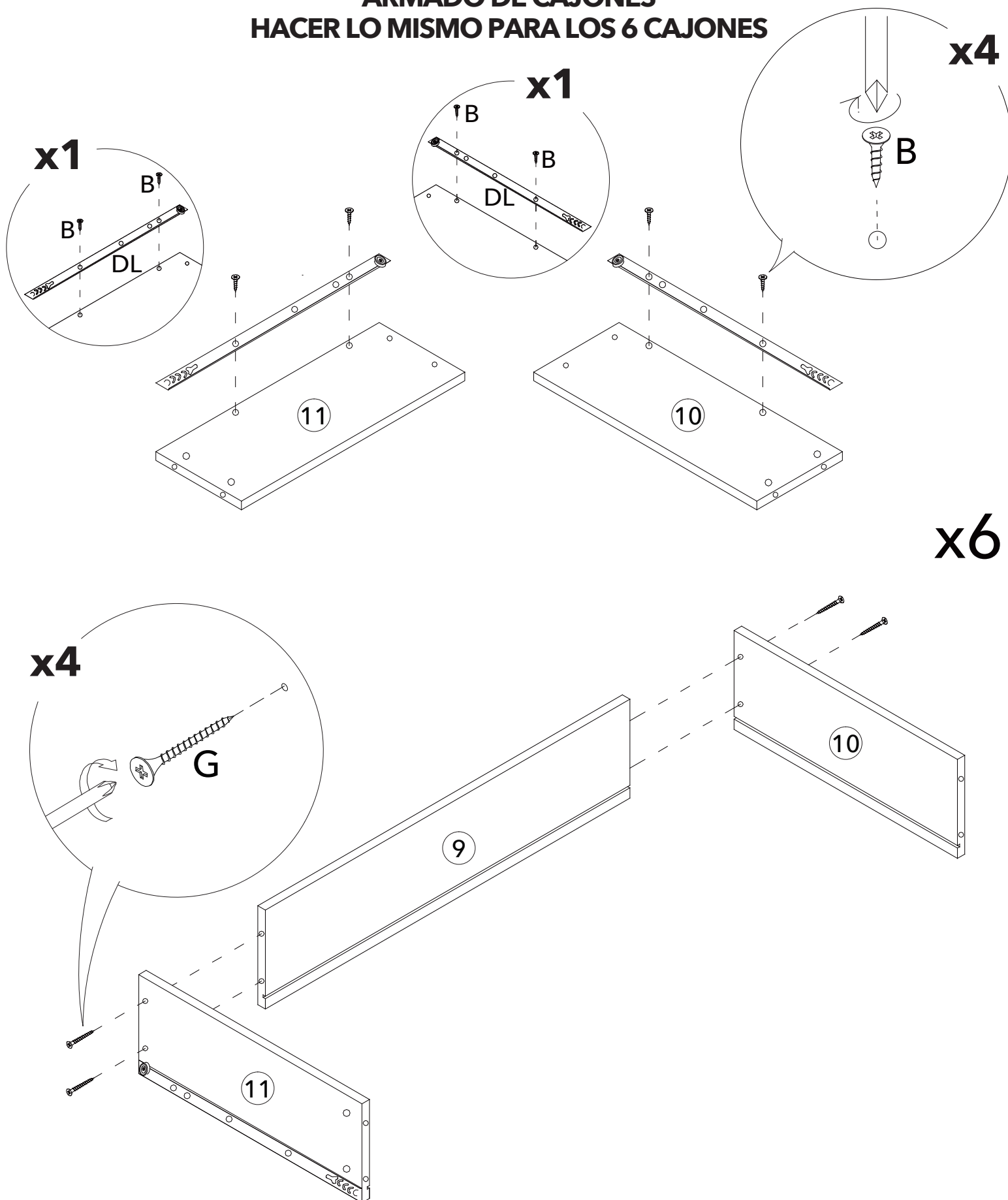

PASO 14
HACER LO MISMO PARA LOS 6 CAJONES

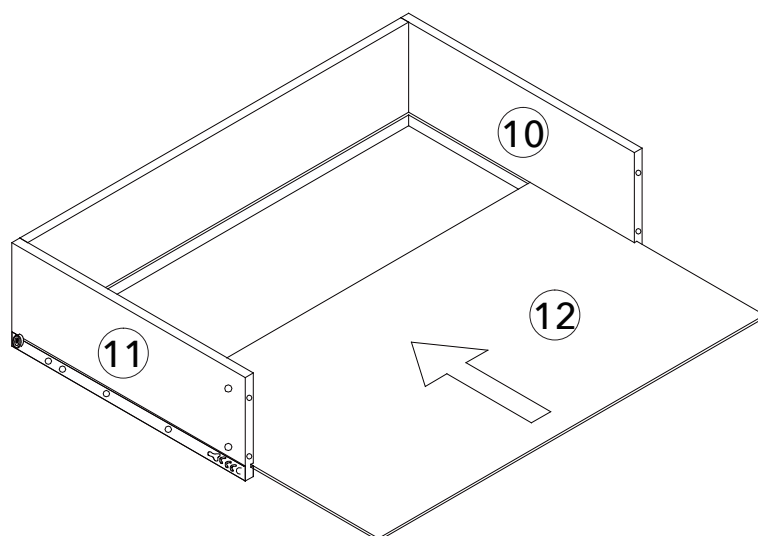

x6

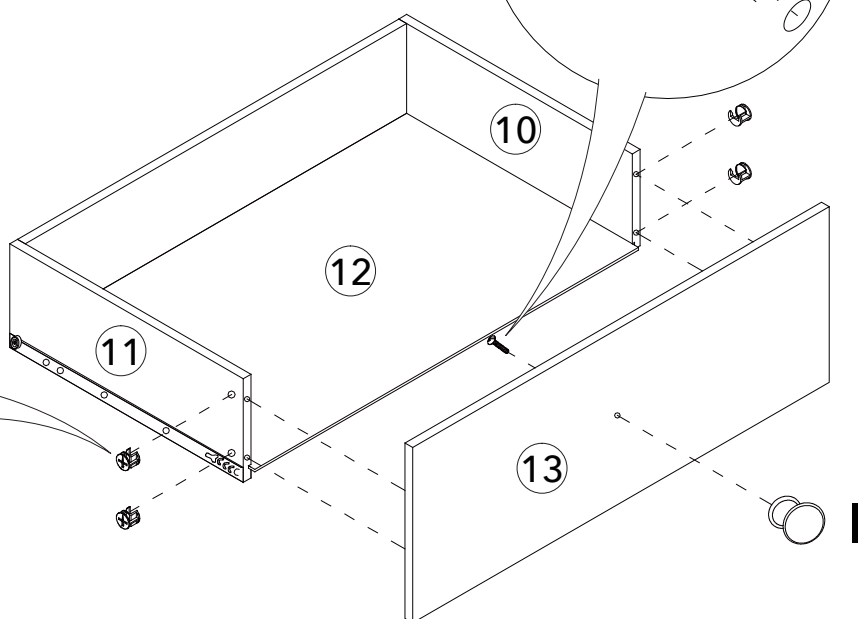
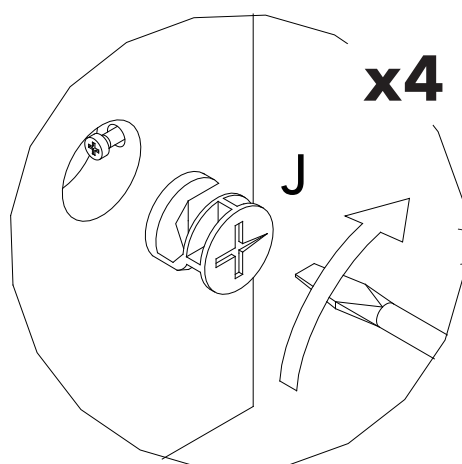
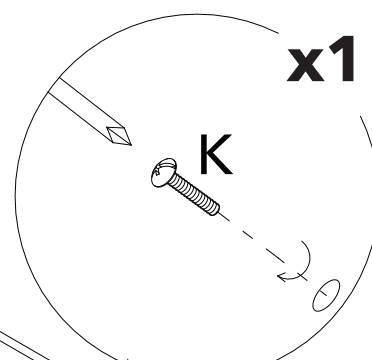
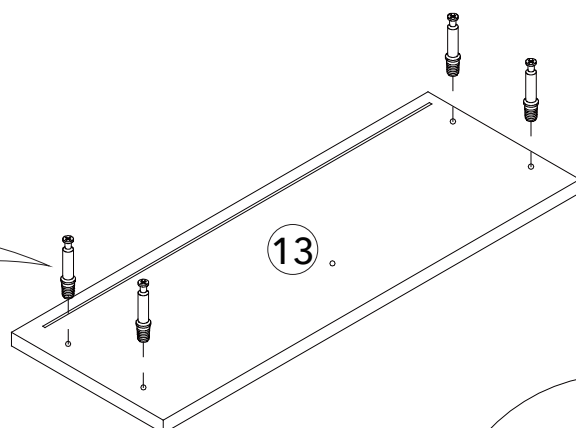
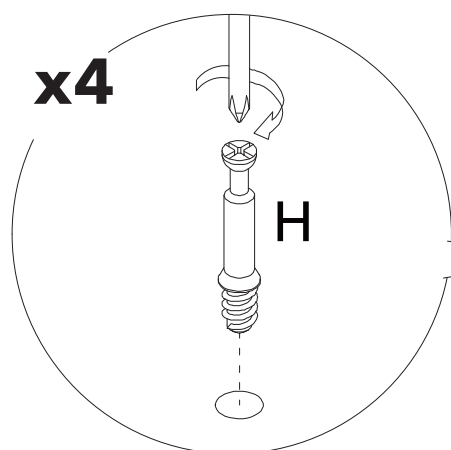

PASO 15
HACER LO MISMO PARA LOS 6 CAJONES

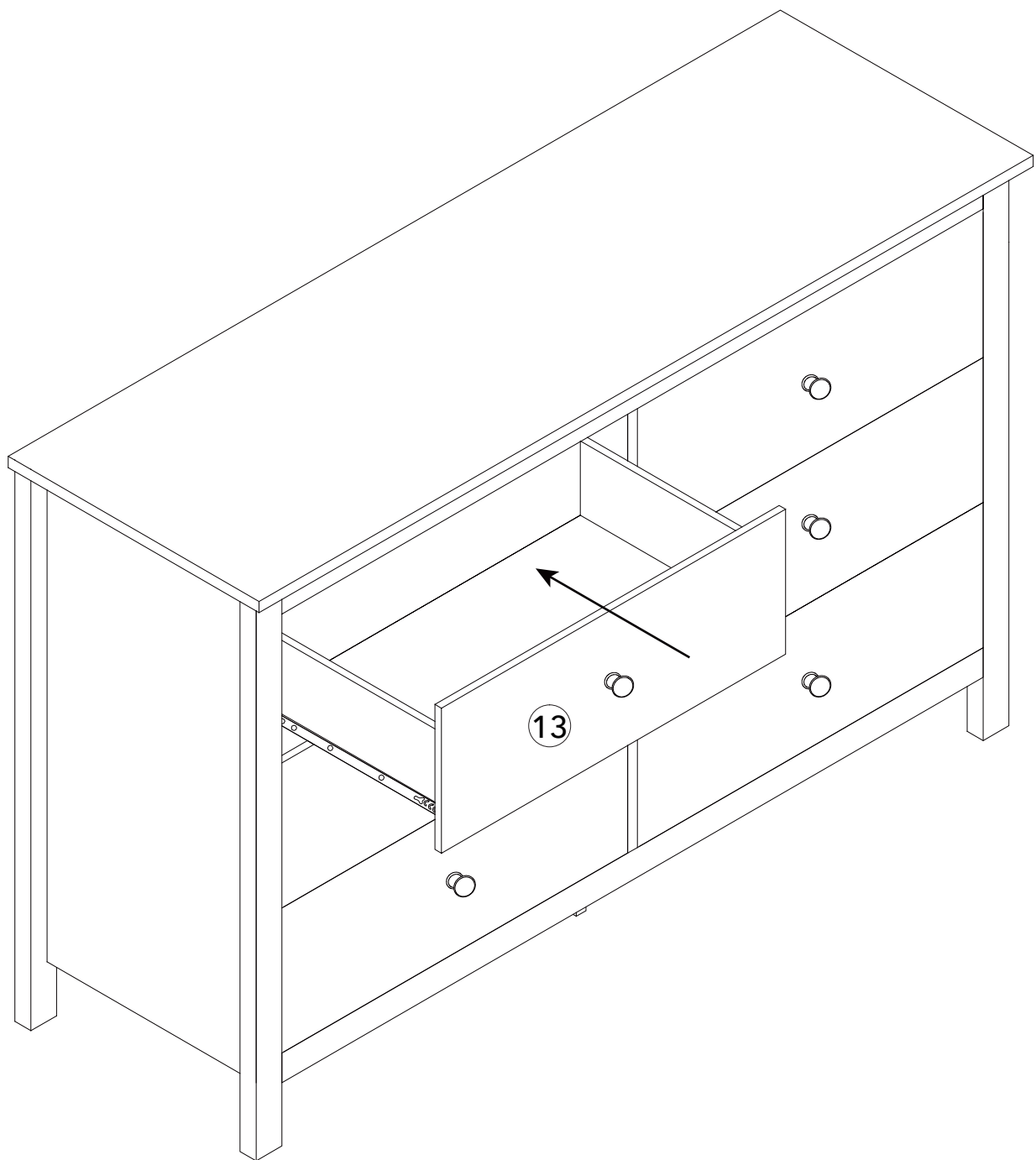

PASO 16

Wall /Mur

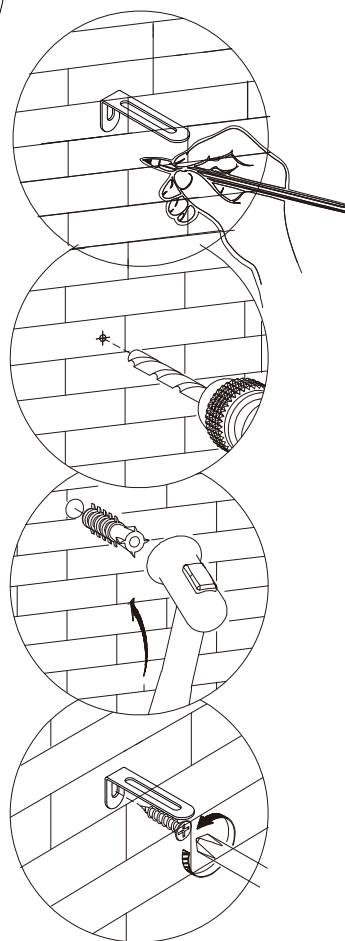
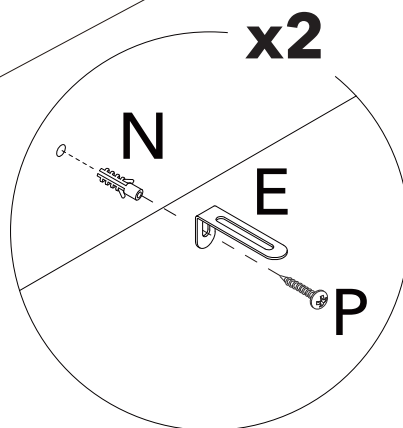
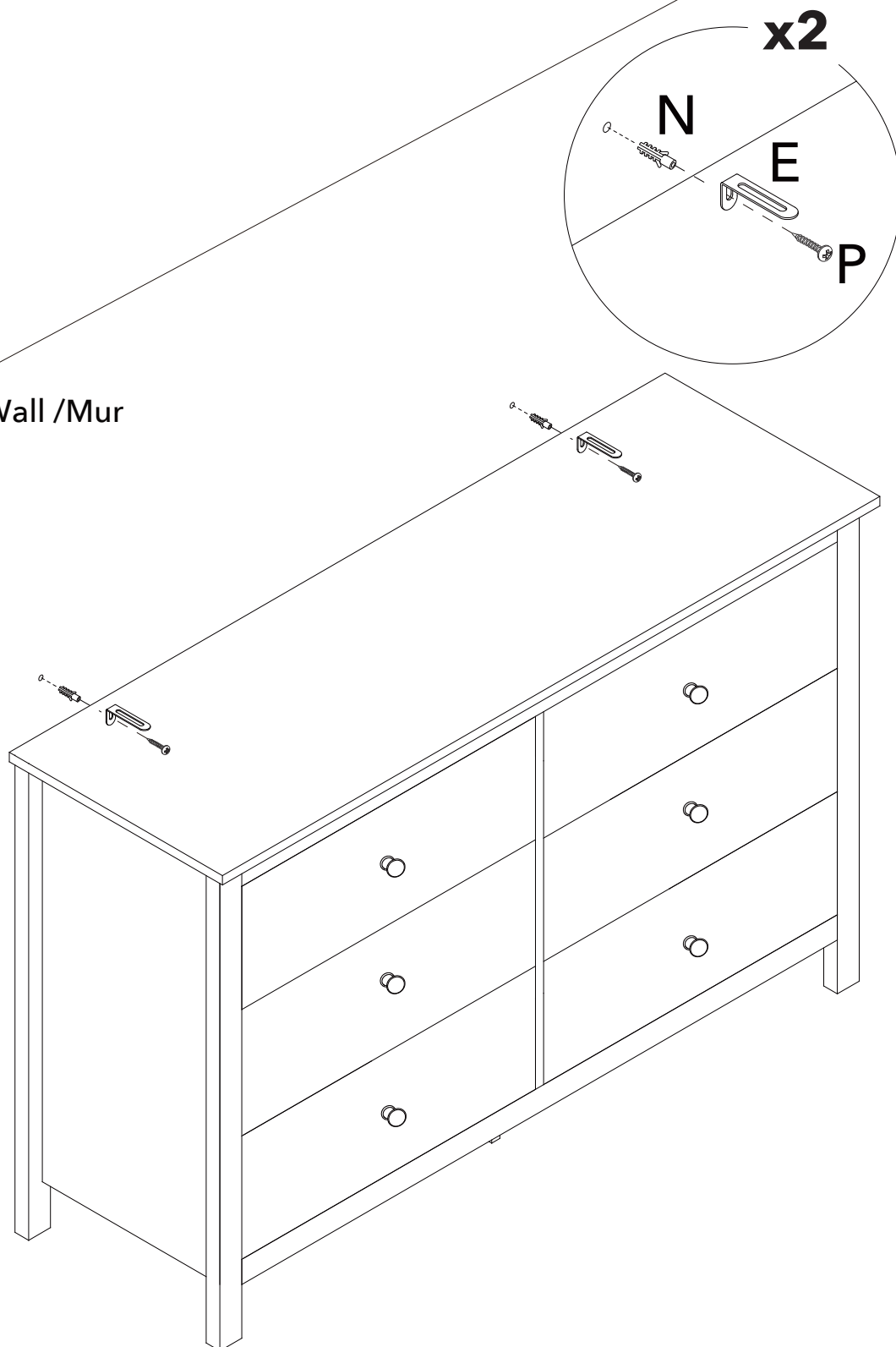



TODOS JUNTOS

Entre todos sí es posible
lograr un impacto real
ahorrando papel.

